



2008 ST1300/A
SET-UP
INSTRUCTIONS



**Set-up and pre-delivery service
must be performed by an authorized
Honda motorcycle dealer.**

IMPORTANCE OF PROPER SET-UP AND PRE-DELIVERY SERVICE

FOR YOUR CUSTOMER'S SAFETY

Proper set-up and pre-delivery service are essential to rider safety and the reliability of the machine. Any error or oversight made by the technician assembling and servicing a new machine can result in faulty operation, damage to the machine, or injury to the rider.

WARNING

Improper set-up or pre-delivery service can create an unsafe condition that can cause your customer to be seriously hurt or killed.

Follow the procedures and precautions in this manual and the Service Manual carefully.

FOR YOUR SAFETY

Some of the most important safety precautions are given below. However, we cannot warn you of every conceivable hazard that can arise in performing set-up and pre-delivery service. Only you can decide whether or not you should perform a given task.

WARNING

Failure to properly follow instructions and precautions can cause you to be seriously hurt or killed.

Follow the procedures and precautions in this manual carefully.

IMPORTANT SAFETY PRECAUTIONS

Make sure you have a clear understanding of all basic shop safety practices and that you are wearing appropriate clothing and safety equipment. When performing the set-up or pre-delivery service, be especially careful of the following:

- Read the instructions before you begin, and make sure you have the tools and skills required to perform the tasks safely.
- To prevent the machine from falling on you, park it on a firm, level surface, using the proper stand(s) to provide firm support.

Make sure the engine is OFF before you begin any servicing procedures. This will help eliminate several potential hazards:

- **Carbon monoxide poisoning from engine exhaust**—be sure there is adequate ventilation whenever you run the engine.
- **Burns from hot parts**—let the engine and exhaust system cool before touching.
- **Injury from moving parts**—do not run the engine unless the instruction tells you to do so. Even then, keep your hands, fingers, and clothing away.

To reduce the possibility of a fire or explosion, be careful when working around gasoline or batteries. Use only a nonflammable solvent, not gasoline, to clean parts. Keep all cigarettes, sparks and flames away from the battery and all fuel-related parts.

2008 ST1300/A

How To Use This Manual

Follow the complete sequence of steps as shown. Do not short-cut any steps. The sequence has been established to ensure the unit is properly assembled.

The individual steps are composed of three components:

- Sub-heading—The large sub-headings are a brief description of the step. They are intended to be used by the experienced technician, one who only needs a brief reminder of the set-up sequence.
- Descriptive text—The descriptive text explains in detail what is to be done during that step. This explanation is intended as a guide for the technician needing additional information.
- Photographs/Line art—The photographs or line art support both the sub-headings and the detailed text.



Indicates the set-up section



Indicates the pre-delivery section

Modifications and Accessories

Modifications that you may have made, or should make in the future, to any Honda product, shall be deemed by our company to have been performed at your sole risk and responsibility, and without our company's or the manufacturer's approval, or consent, implied or expressed. We further disclaim any and all liability, obligation, or responsibility for any defects of modified parts or of the modified product, and for any claims, demands, or causes of action for damage to property or for personal injuries resulting from the modification of said Honda product.

Torque Table

ITEM	SIZE	TORQUE
Reflector nuts	6 mm	12 N·m (1.2 kgf·m, 9 lbf·ft)
Front fender bolts	6 mm	12 N·m (1.2 kgf·m, 9 lbf·ft)
Front axle bolt	-----	79 N·m (8.1 kgf·m, 58 lbf·ft)
Pinch bolts	8 mm	22 N·m (2.2 kgf·m, 16 lbf·ft)
Caliper bolts	8 mm	31 N·m (3.2 kgf·m, 23 lbf·ft)
Mirror bolts	6 mm	12 N·m (1.2 kgf·m, 9 lbf·ft)
Windscreen bolts	6 mm	12 N·m (1.2 kgf·m, 9 lbf·ft)
Windscreen cover screws	4 mm	1.0 N·m (0.1 kgf·m, 0.7 lbf·ft)
Engine guard covers	6 mm	9.0 N·m (0.9 kgf·m, 6.6 lbf·ft)
Oil filler cap	-----	12 N·m (1.2 kgf·m, 9 lbf·ft)
Clutch reservoir cover screws	4 mm	1.5 N·m (0.15 kgf·m, 1.1 lbf·ft)
Front brake reservoir cover screws	4 mm	1.5 N·m (0.15 kgf·m, 1.1 lbf·ft)



1. Remove the carton cover.

The ST1300/A is crated in one of three ways. You may receive one of the following.

Carton covered crate:

Cut the strap and remove the carton cover. Remove the inner cardboard frame cover.

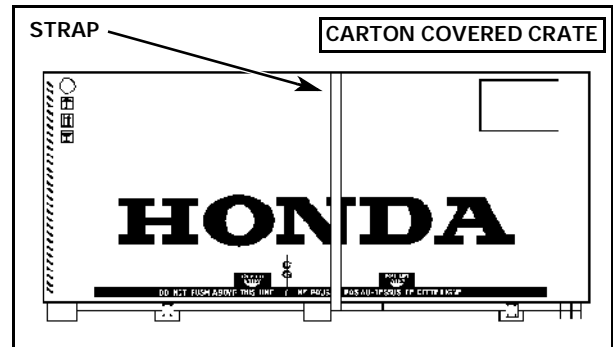

Polypropylene covered crate:

Cut the strap, open the fastener, and remove the polypropylene cover.

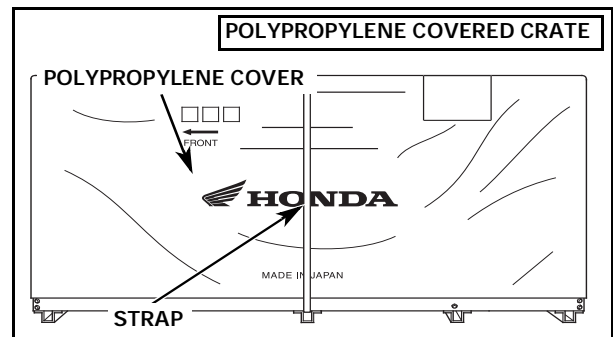

Uncovered crate:

When stacking crates, protect the motorcycle from falling objects and bad weather.

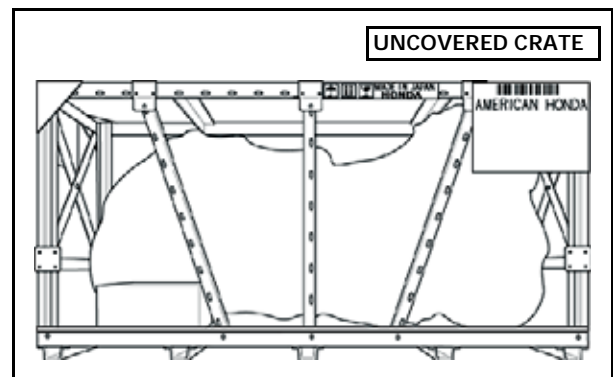

2. Check for damage.

Check the unit for hidden damage.

If you find damage, follow the instructions on the *Delivery and Damage Claims Guidelines* wall chart (Reorder No. S0477) before proceeding.

3. Remove the side braces, wheel assembly, loose parts cartons, and crate frame.

Remove the ties securing the front wheel assembly and loose parts cartons.

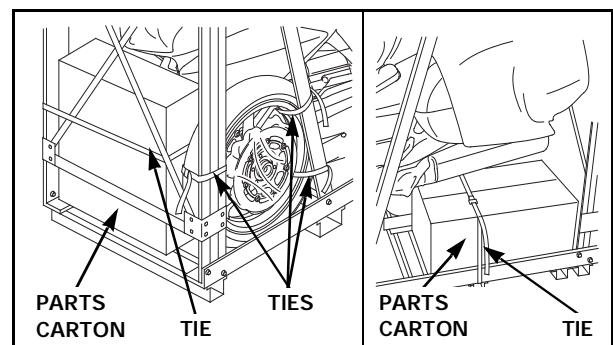

2008 ST1300/A

3. Remove the side braces, wheel assembly, loose parts cartons, and crate frame (cont.).

PARTS	QTY
<i>You & Your Motorcycle Riding Tips</i>	1

Remove the bolts and side braces, being careful not to damage the front wheel assembly.

Remove the loose parts cartons.

Remove the *You & Your Motorcycle Riding Tips* from the loose parts carton hand deliver to the customer at the time of delivery.

Remove the nuts and plate.

Remove the bolts securing the crate frame to the base.

Using two people, carefully remove the crate frame, being careful not to damage the motorcycle.

Remove the front shipping brace, being careful not to damage the motorcycle.

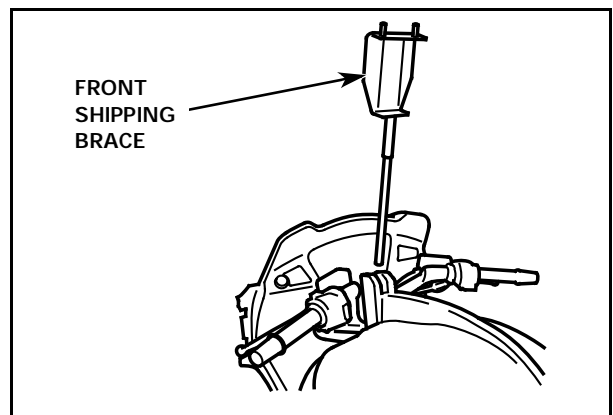
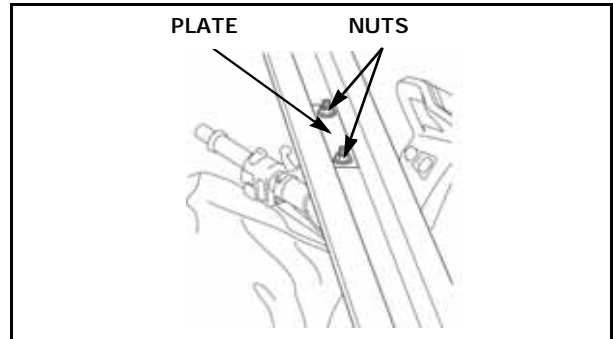
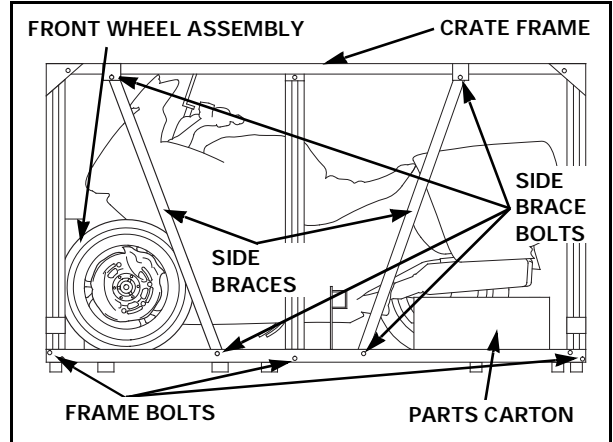



4. Loose Parts Information.

Unpack the remaining loose parts and check them against this illustration.

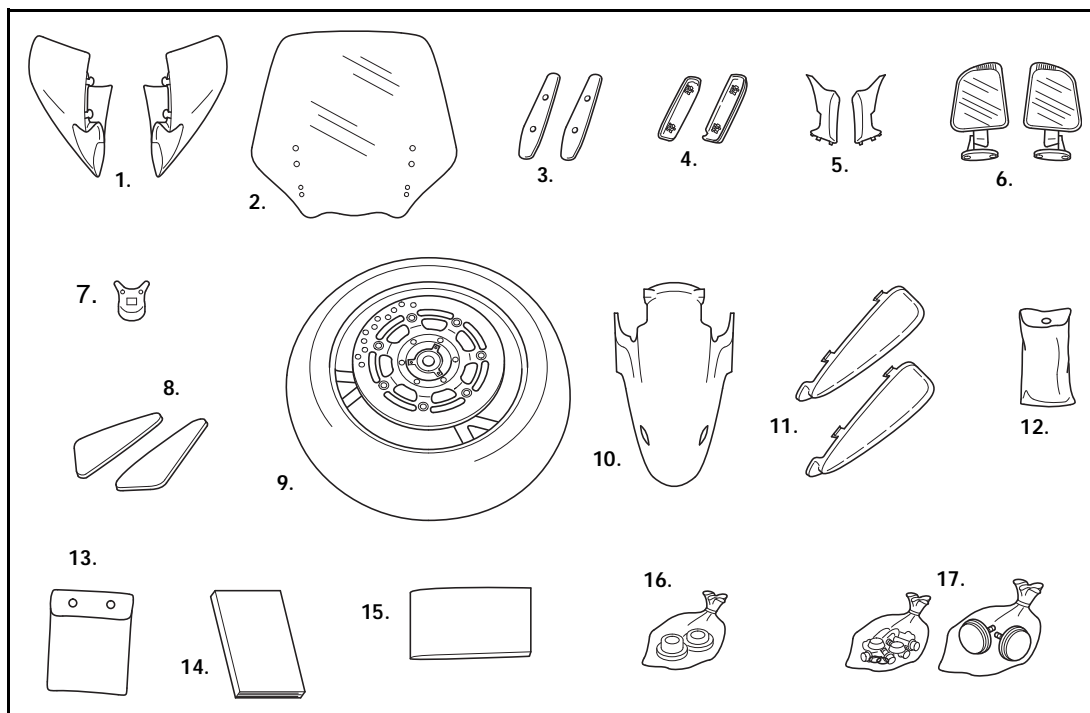

DESCRIPTION	QTY	PART NUMBER	STEP
1. Right mirror cover assembly	1	8811T-MCS-L00	8
Left mirror cover assembly	1	8812T-MCS-L00	8
2. Windscreen	1	64150-MCS-G00	9
3. Windscreen cover	2	64151-MCS-G00	9
4. Right windscreen bracket cover	1	64183-MCS-G00	9
Left windscreen bracket cover	1	64188-MCS-G00	9
5. Right mirror cover rubber	1	88112-MCS-G00	8
Left mirror cover rubber	1	88122-MCS-G00	8
6. Right rear view mirror	1	88110-MCS-G01	8
Left rear view mirror	1	88120-MCS-G01	8
7. Handlebar cover	1	53115-MCS-G00ZA	10
8. Right knee grip pad*	1	17506-MCS-G01	16
Left knee grip pad*	1	17507-MCS-G01	16
9. Front wheel assembly	1	-----	7
10. Front fender	1	61100-MCS-G00ZK	6
11. Right engine guard cover	1	64260-MCS-G01	14
Left engine guard cover	1	64265-MCS-G01	14

*Optional parts. Give the knee grip pads to the customer at the time of delivery or install if the customer wants them installed (see step 16).

(Continued on next page.)

2008 ST1300/A

4. Loose parts information (cont.).

DESCRIPTION	QTY	PART NUMBER	STEP
12. Tool kit	1	-----	12
13. <i>Owner's Manual</i> bag	1	83642-MN5-000	12
14. <i>Owner's Manual</i>	1	31MCS650**	12
15. <i>You & Your Motorcycle Riding Tips</i>	1	G0045***	3
16. Right front wheel side collar	1	44311-MCS-G00	7
Left front wheel side collar	1	44312-MCS-G00	7
17. Attaching parts:			
<i>Front fender:</i>			
Rubber washer	2	18325-MBV-000	6
Pan screw 6 x 20 mm	2	90138-MCS-G00	6
Socket bolt 6 x 18 mm	2	96600-06018-00	6
Flange bolt 6 x 16 mm	2	96001-06016-00	6
Front reflector	2	33741-413-013	6
Front reflector stay	2	33742-MCS-L00	6
Flange nut 6 mm	2	94050-06000	6
<i>Mirrors:</i>			
Flange bolt 6 x 20 mm	4	96001-06020-00	8
Hose clip	4	95002-02100	8
<i>Windscreen:</i>			
Plastic retainer	4	64509-MK4-000	9
Side cover collar	4	61104-435-000	9
Flange bolt 6 x 18 mm	4	96001-06018-07	9
Pan screw 4 x 25 mm	4	90126-MCS-G00	9
Adjuster rubber	2	64175-MCS-G00	9
<i>Handlebar cover:</i>			
Special screw 4 x 6.5 mm	2	90136-MCS-G00	10
<i>Engine guard covers:</i>			
Pan screw 6 x 11 mm	2	90106-KY2-701	14
<i>Battery cable</i>			
Pipe Clamp	1	11152-KS4-003	18

INCLUDED TOOLS: 5mm hex wrench

** If missing, order from Helm Inc.

*** If missing, order from Resolve Corp.

Missing Parts or Shipping Damage

Identify missing parts by referring to the *Loose Parts Information* section. Order the parts using normal parts ordering procedures. Claims for missing loose parts or those damaged during transit should be submitted to American Honda, not the carrier. After completing repairs, submit a Transportation Claim via **IN**. For complete details, please refer to the *Warranty Policy and Procedures Manual*.



5. Remove the motorcycle from the crate base.

Install lifting slings on the engine guards and grab rails as shown.

Be careful not to damage the fuel tank and cowls.

If necessary, use a spreader board to prevent the slings from damaging the motorcycle.

Lift the slings just enough to remove the slack.

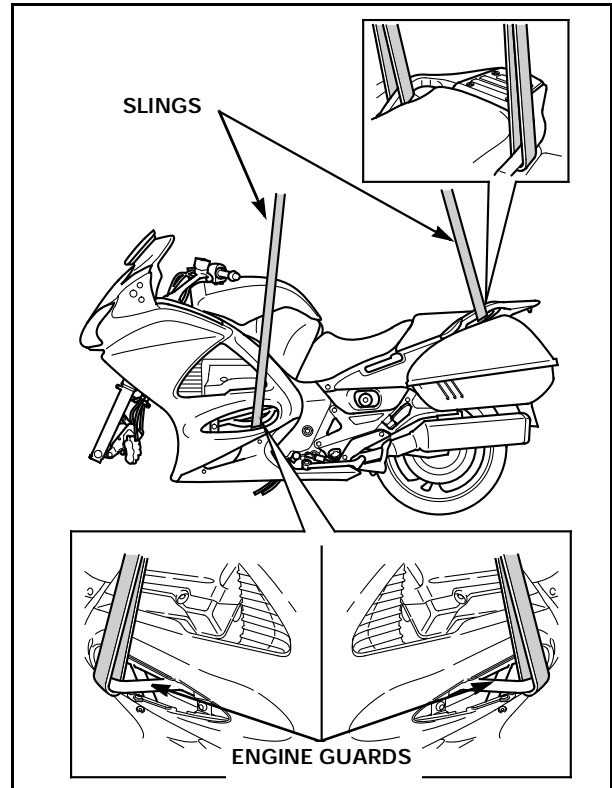

Loosen the caliper bolts, axle bolt, and axle pinch bolts. Remove the washer bolts and lower shipping bracket from the crate base.

Discard the washer bolts.

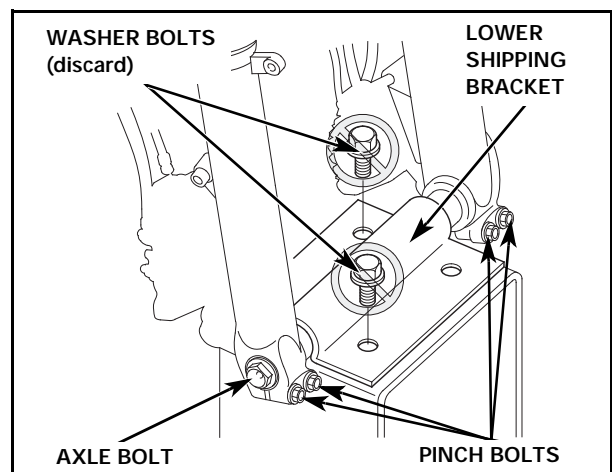
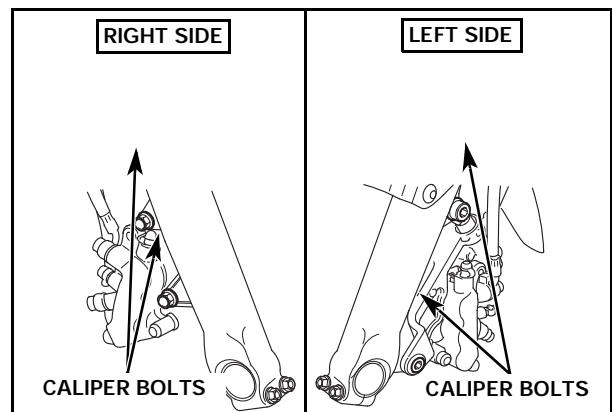

2008 ST1300/A

5. Remove the motorcycle from the crate base (cont.).

Remove the shipping braces, nuts, and protective covering from the foot pegs on both sides of the motorcycle.

Lift the motorcycle free from the crate base and remove the base.

On a firm, level surface, lower the sidestand and lower the motorcycle until it is resting on its rear wheel and sidestand.

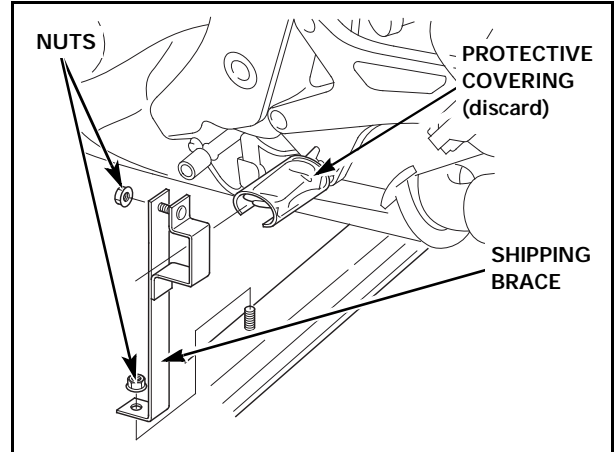

6. Install the front fender.

PARTS	QTY
Front fender	1
Rubber washer	2
Pan screw 6 x 20 mm	2
Socket bolt 6 x 18 mm	2
Flange bolt 6 x 16 mm	2
Front reflector	2
Front reflector stay	2
Flange nut 6 mm	2

Remove the axle bolt.

Remove the axle protective covering and the axle shaft.

Position the front reflector stays on the inside of the front fender by aligning them with the projections on the front fender. Install the front reflector stays with two 6 x 20 mm pan screws and rubber washers.

Secure the reflectors to the stays with two 6 mm flange nuts.

Torque the nuts.

Torque: 12 N·m (1.2 kgf·m, 9 lbf·ft)

Position the front fender between the fork legs and attach it to the fork stays with two 6 x 18 mm socket bolts. Secure the brake hose stays with two 6 x 16 mm flange bolts.

Torque the bolts.

Torque: 12 N·m (1.2 kgf·m, 9 lbf·ft)

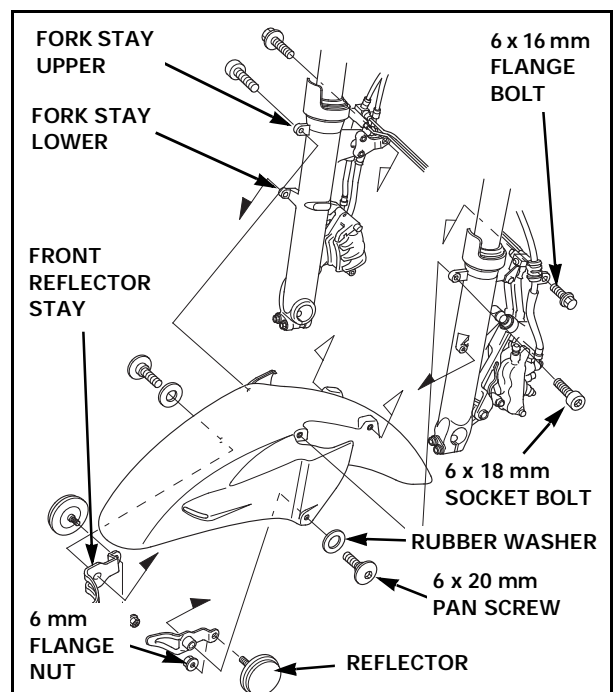
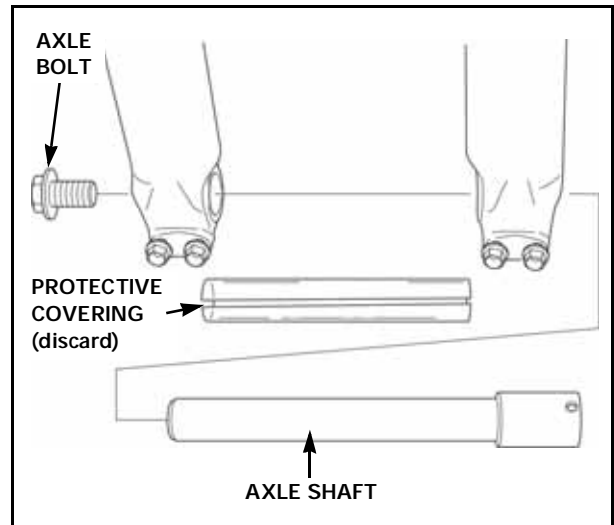



7. Install the front wheel.

PARTS	QTY
Front wheel assembly	1
Right front wheel side collar	1
Left front wheel side collar	1

Clean both sides of the front and rear brake discs with a clean shop towel and Pro Honda Brake Cleaner or equivalent.

Remove the caliper bolts. Be careful not to get dust and dirt on the ends of the caliper bolts.

Support both calipers with a piece of wire, or similar method, so they do not hang from the brake hoses. Be careful not to twist the brake hoses.

Do not operate the brake lever or pedal after the brake calipers are removed.

Note that the shoulders on each front wheel side collar are different sizes. It is important to install them with the correct sides facing the wheel.

Install the 16.5 mm left front wheel side collar with the 10 mm deep shoulder side facing the wheel.

Install the 27.5 mm right front wheel side collar with the 34 mm outside diameter shoulder facing the wheel.

Position the front wheel between the fork legs.

Slide the axle shaft through the left fork leg, the 16.5 mm left front wheel side collar, front wheel, 27.5 mm right front wheel side collar, and right fork leg.

Push in on the axle shaft so the left end of the axle shaft is flush with the surface of the left fork leg.

Tighten the **left** axle pinch bolts to the specified torque.

Torque: 22 N·m (2.2 kgf·m, 16 lbf·ft)

Install and tighten the axle bolt to the specified torque.

Torque: 79 N·m (8.1 kgf·m, 58 lbf·ft)

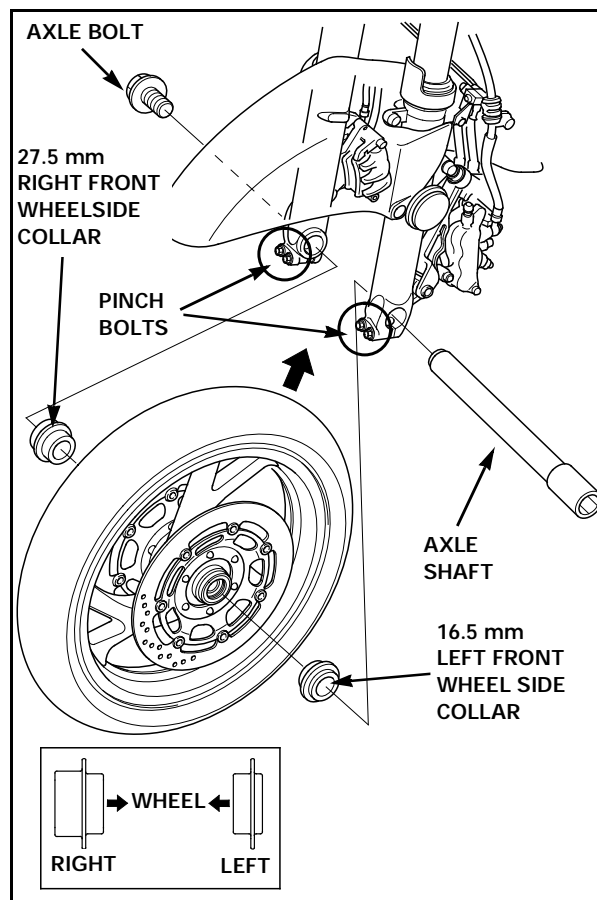
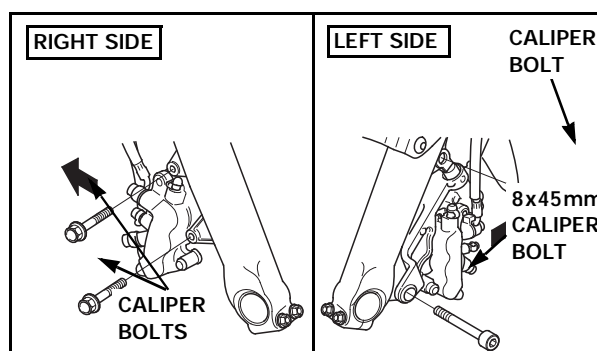
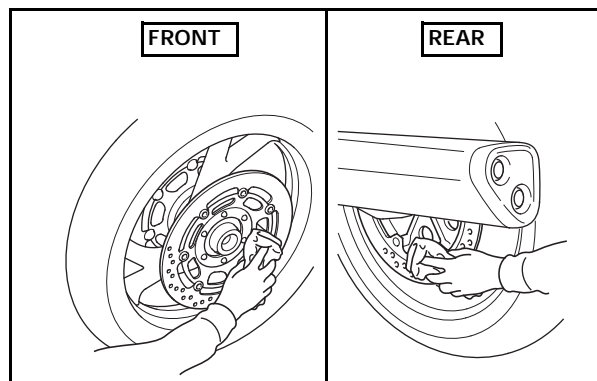

2008 ST1300/A

7. Install the front wheel (cont.).

Tighten the **right** axle pinch bolts to the specified torque and loosen the **left** axle pinch bolts.

Torque: 22 N·m (2.2 kgf·m, 16 lbf·ft)

Reinstall the right and left front brake calipers, being careful not to damage the front wheel and related components.

Install the caliper bolts and tighten to the specified torque.

Torque: 31 N·m (3.2 kgf·m, 23 lbf·ft)

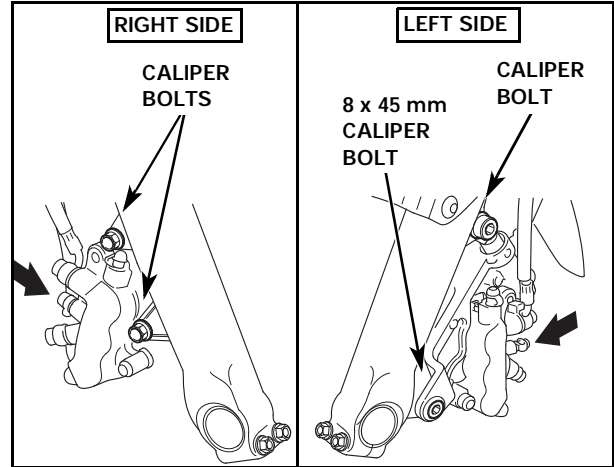

Operate the front brake and pump the forks several times to seat the axle.

Check the brake operation by applying the brake lever and pedal.

Check the wheel for free rotation after the brake is released. If the brake drags or the wheel does not rotate freely, recheck the wheel and brake caliper installation.

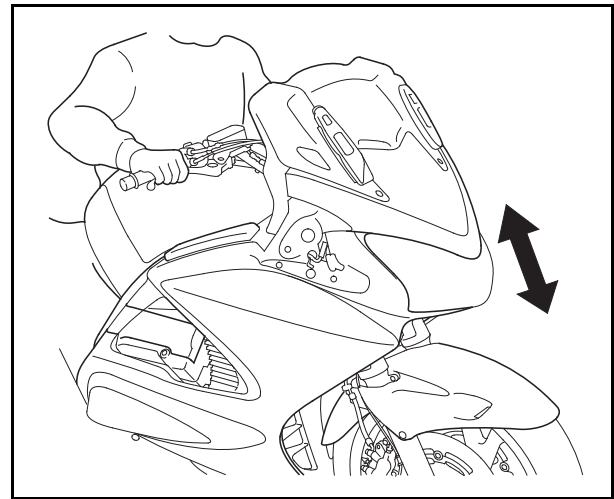

Visually check the position of the brake disc in relation to the brake caliper; it should be centered. If not, recheck the wheel and brake caliper installation.

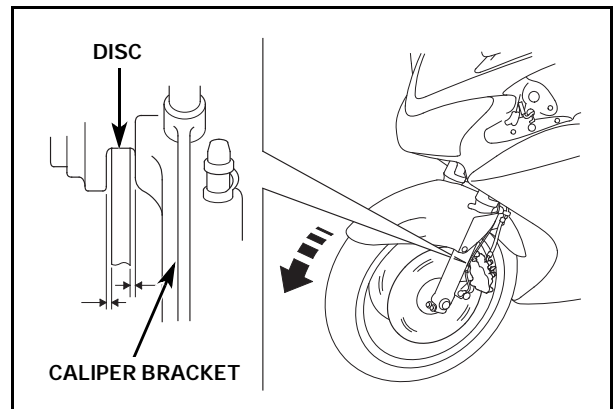



7. Install the front wheel (cont.).

Make sure the axle end is flush with the front fork leg outer surface as shown.

Tighten the **left** axle pinch bolts to the specified torque.

Torque: 22 N·m (2.2 kgf·m, 16 lbf·ft)

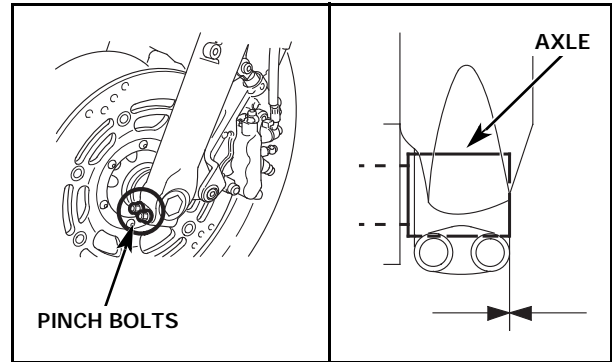

On the ST1300A, verify the clearance between the ABS front pulser ring and sensor.

**Clearance specification:
0.4 – 1.2 mm (0.02 – 0.05 in)**

If outside the clearance specification range, recheck the wheel installation.

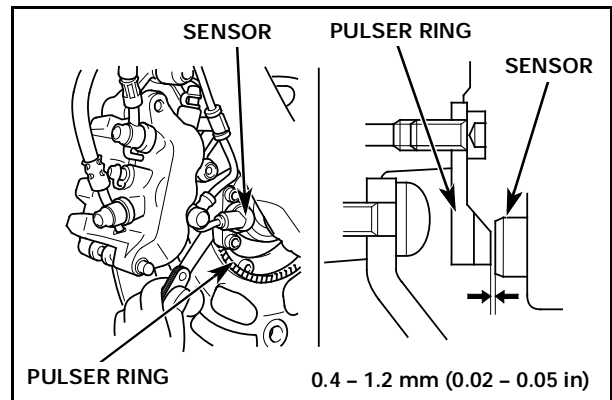

8. Install the mirrors.

PARTS	QTY
Right mirror cover assembly	1
Left mirror cover assembly	1
Right mirror cover rubber	1
Left mirror cover rubber	1
Right rear view mirror	1
Left rear view mirror	1
Flange bolt 6 x 20 mm	4
Hose clip	4

Remove and discard the shipping bolts. Install the right and left rear view mirrors using two 6 x 20 mm flange bolts on each side.

Torque the bolts.

Torque: 12 N·m (1.2 kgf·m, 9 lbf·ft)

Install the two hose clips as shown.

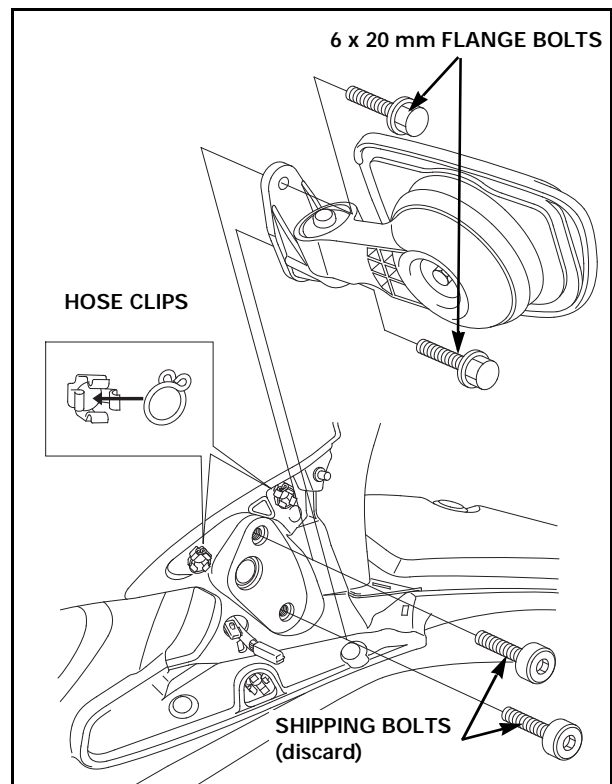

8. Install the mirrors (cont.).

Align the retaining tabs, located on the ends of the mirror cover rubber, with the indentations on the fairing.

Push the end of the retainer strap into the hole in the body.

Connect the wiring harness terminals color-to-color: right side wires are colored light blue and white, left side wires are colored orange and white.

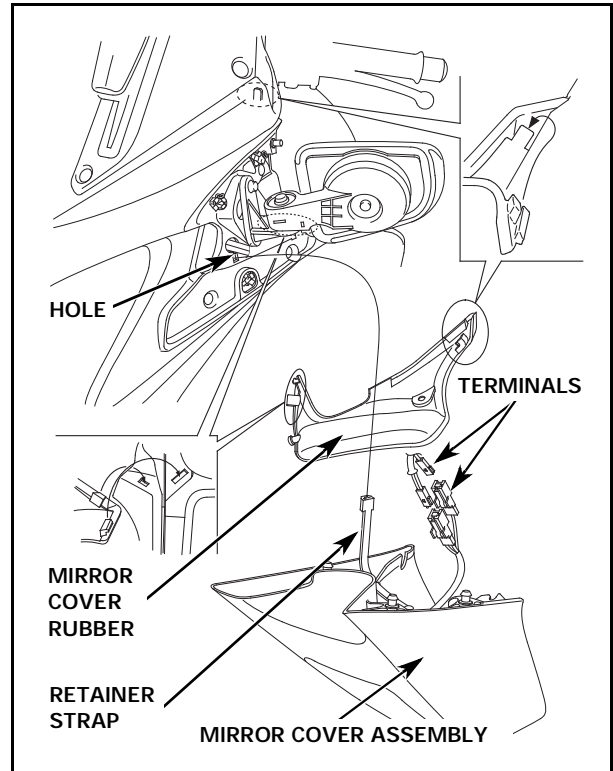

Carefully install the mirror cover assemblies by pressing the cover prongs into the grommets on the bracket, and mirror bracket ends into the cover as shown.

Check that the mirror cover rubber and mirror cover are installed securely and there is no clearance between each of the components.

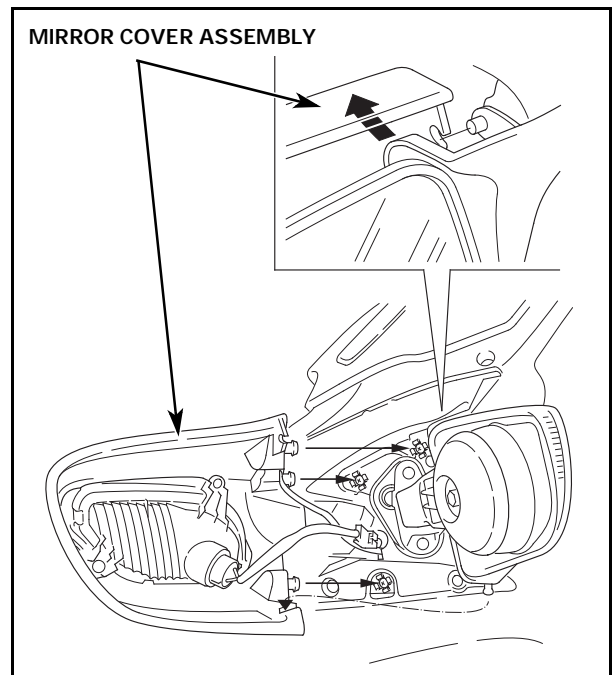



9. Install the windscreen.

PARTS	QTY
Windscreen	1
Windscreen cover	2
Right windscreen bracket cover	1
Left windscreen bracket cover	1
Plastic retainers	4
Side cover collar	4
Flange bolt 6 x 18 mm	4
Pan screw 4 x 25 mm	4
Adjuster rubber	2

Note that the windscreen adjusters are installed as shown, however, they can be reinstalled according to rider preference.

To install the windscreen, use two people to carefully install the following parts in the order indicated below:

- Windscreen bracket covers
- Adjuster rubbers
- Windscreen
- Plastic retainer
- Side cover collars
- 6 x 18 mm flange bolts

Torque the bolts.

Torque: 12 N·m (1.2 kgf·m, 9 lbf·ft)

Then, install the following:

- Windscreen covers
- 4 x 25 mm pan screws

Torque the pan screws.

Torque: 1.0 N·m (0.1 kgf·m, 0.7 lbf·ft)

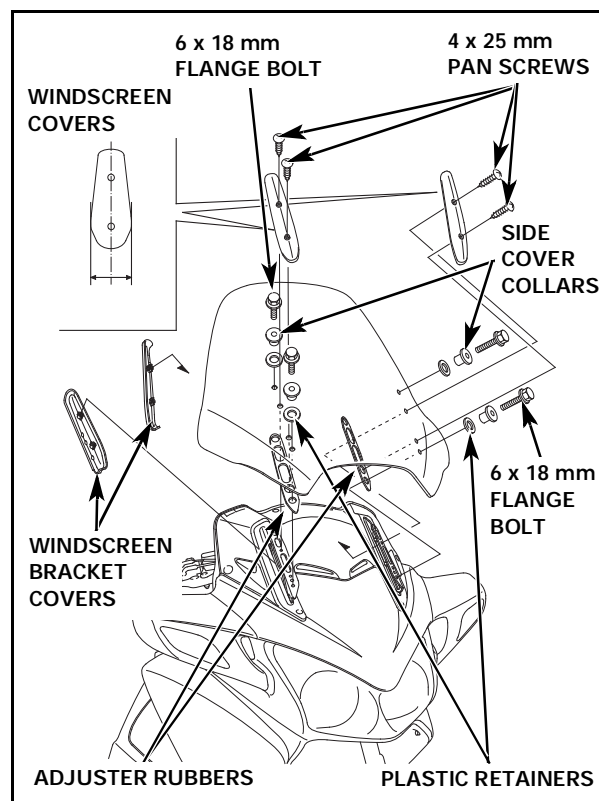

2008 ST1300/A

10. Install the handlebar cover and saddlebag lever lock.

PARTS	QTY
Handlebar cover	1
Special screw 4 x 6.5 mm	2

Remove the ignition key from the ignition.

Remove the protective tapes.

Attach the handlebar cover using two 4 x 6.5 mm special screws.

Tighten the screws securely.

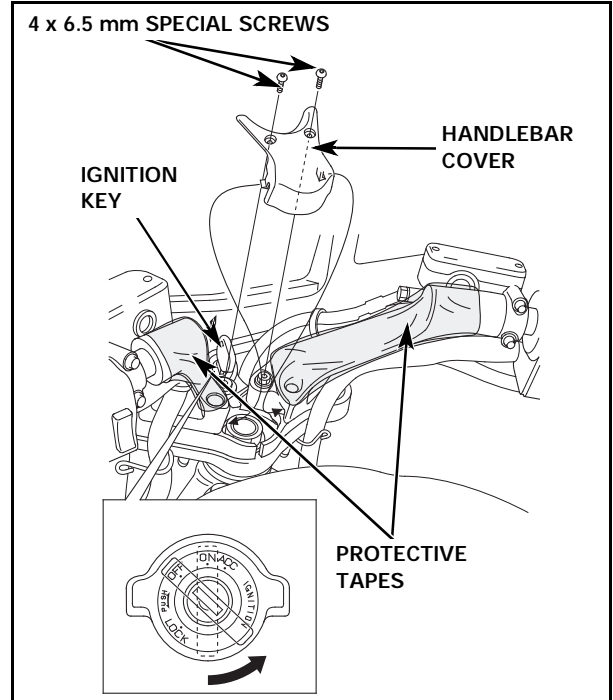

Open the left fairing pocket with the ignition key.

Take out the saddlebag lever locks from the left fairing pocket.

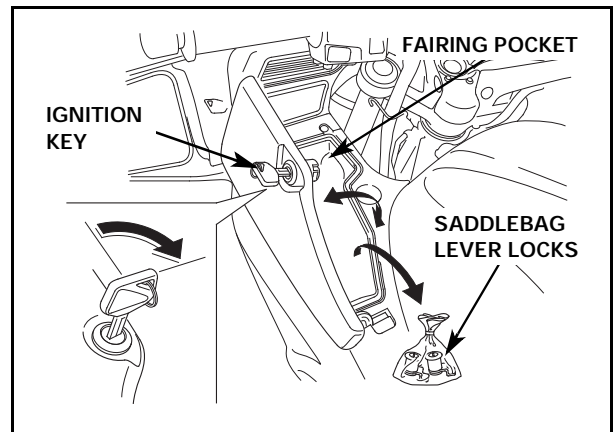

Insert the ignition key into the saddlebag lever lock and turn it clockwise to the position shown.

Push in on the saddlebag lever lock while aligning it with the cutout in the saddlebag as shown.

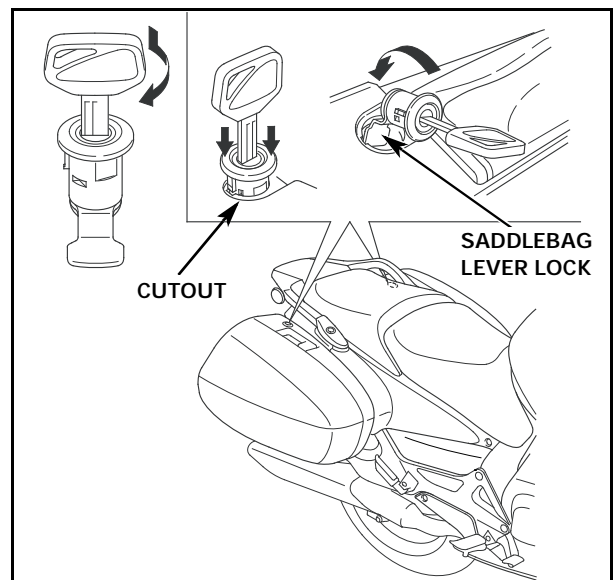



11. Remove the rear seat.

Insert the ignition key and turn it clockwise to open the latch lever.

Pull the rear seat back and up while depressing the seat opener.

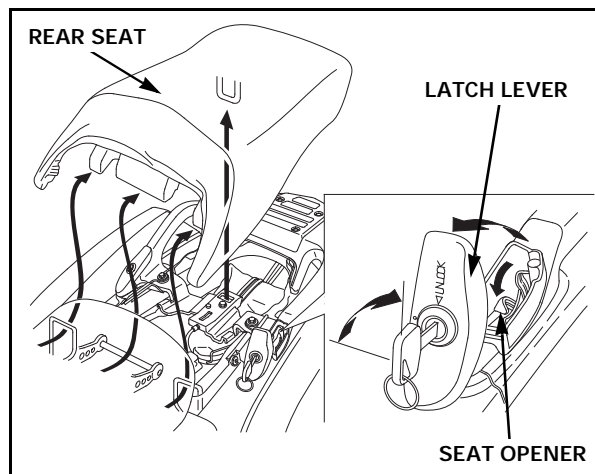

12. Store the tool kit and Owner's Manual.

PARTS	QTY
Tool kit	1
Owner's Manual bag	1
Owner's Manual	1

Place the tool kit under the rear seat and secure it with the tool band.

Place the *Owner's Manual* into its bag and place it on top of the tool kit.

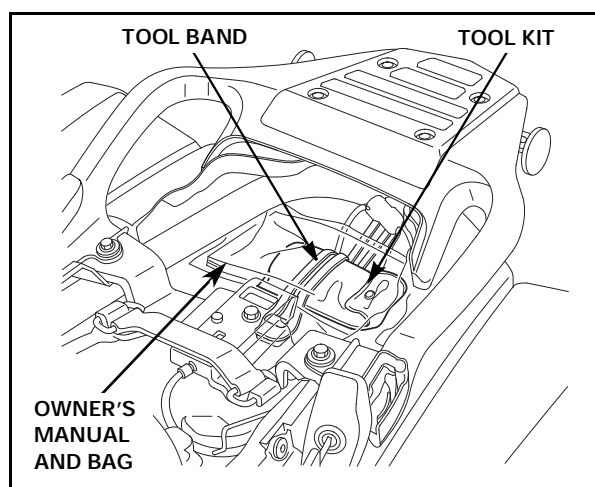

13. Install the rear seat.

Note: If the pre-delivery steps will be completed directly after set-up, leave the rear seat off until after step 18.

Insert the prong into the recess under the frame cross member, then push down on the rear of the rear seat.

Close the latch lever and turn the ignition key counterclockwise.

Be sure the seat is locked securely in position.

Place the ignition key into the ignition.

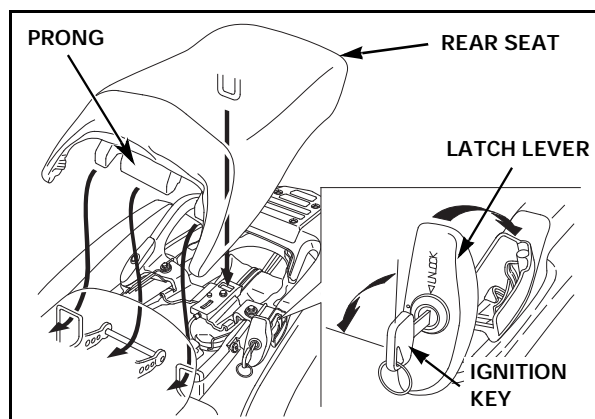

2008 ST1300/A

14. Install the engine guard covers.

PARTS	QTY
Right engine guard cover	1
Left engine guard cover	1
Pan screw 6 x 11 mm	2

Install both the left and right engine guard covers and secure them with a 6 x 11 mm pan screw.

Torque the screws.

Torque: 9.0 N·m (0.9 kgf·m, 6.6 lbf·ft)

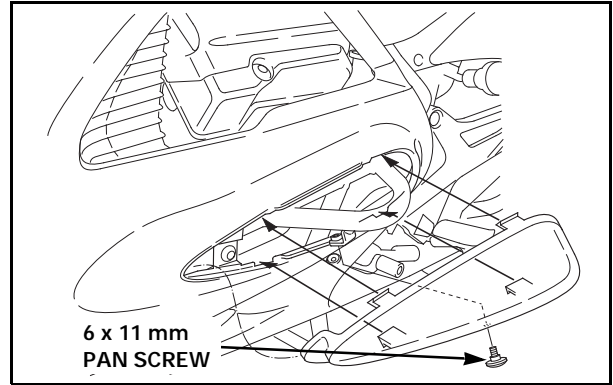

15. Remove the protective cover.

Remove the protective plastic covers. Refer to the illustration on the right for specific locations.

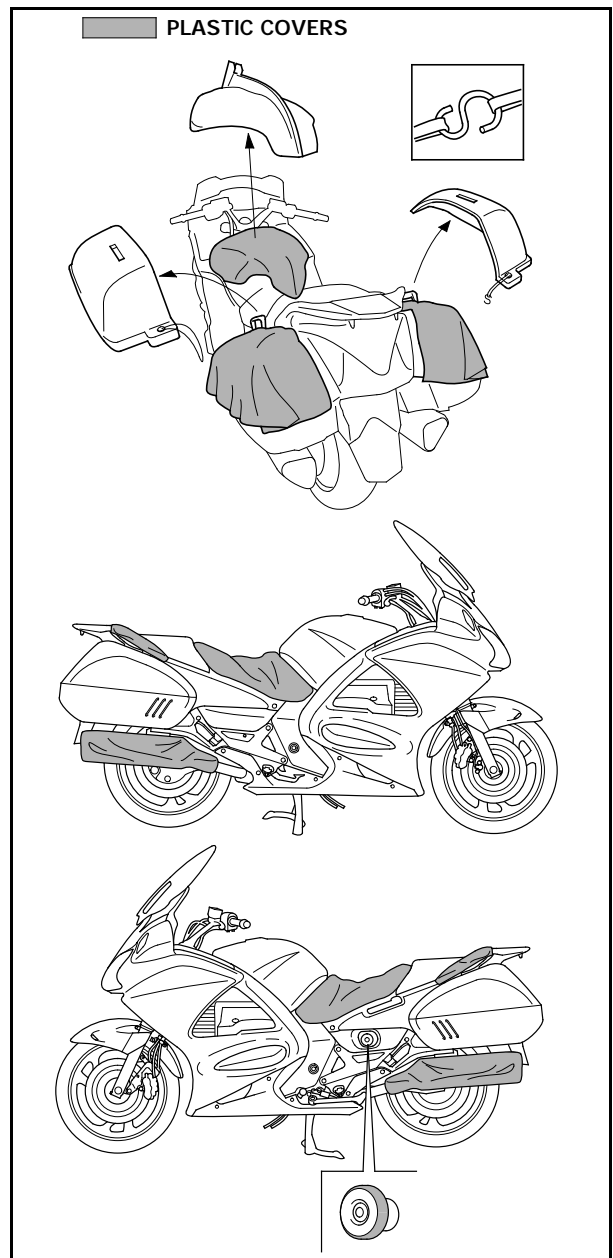



16. Install the fuel tank knee grip pads.

PARTS	QTY
Right knee grip pad	1
Left knee grip pad	1

Install the optional knee pads if the customer requests them to be installed.

If the unit has not been sold, store the pads in the right saddlebag.

Clean the mating surfaces of the fuel tank with a clean shop towel and isopropyl alcohol or equivalent.

Allow the tank to dry completely.

Peel off the backing sheets and attach the pads to the sides of the fuel tank 30 mm (1-13/16 in) from the lower front edges of the tank, as shown in the illustration.

If the ambient temperature is 77°F (21°C) or below, warm the mating surfaces of the tank and both the pad's adhesive sides with a hair dryer before attaching.

After attaching the pads, press down firmly over the entire area of the pad to ensure maximum adhesion.

Avoid washing the motorcycle or riding in wet conditions for 24 hours after attaching the pads.

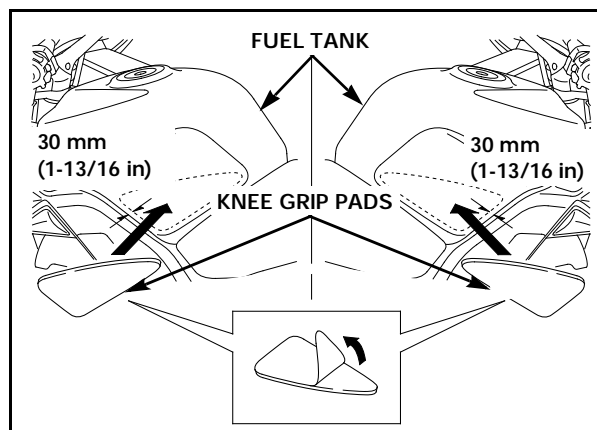

2008 ST1300/A

17. Verify the proper routing of the cables, hoses, and wire harnesses.

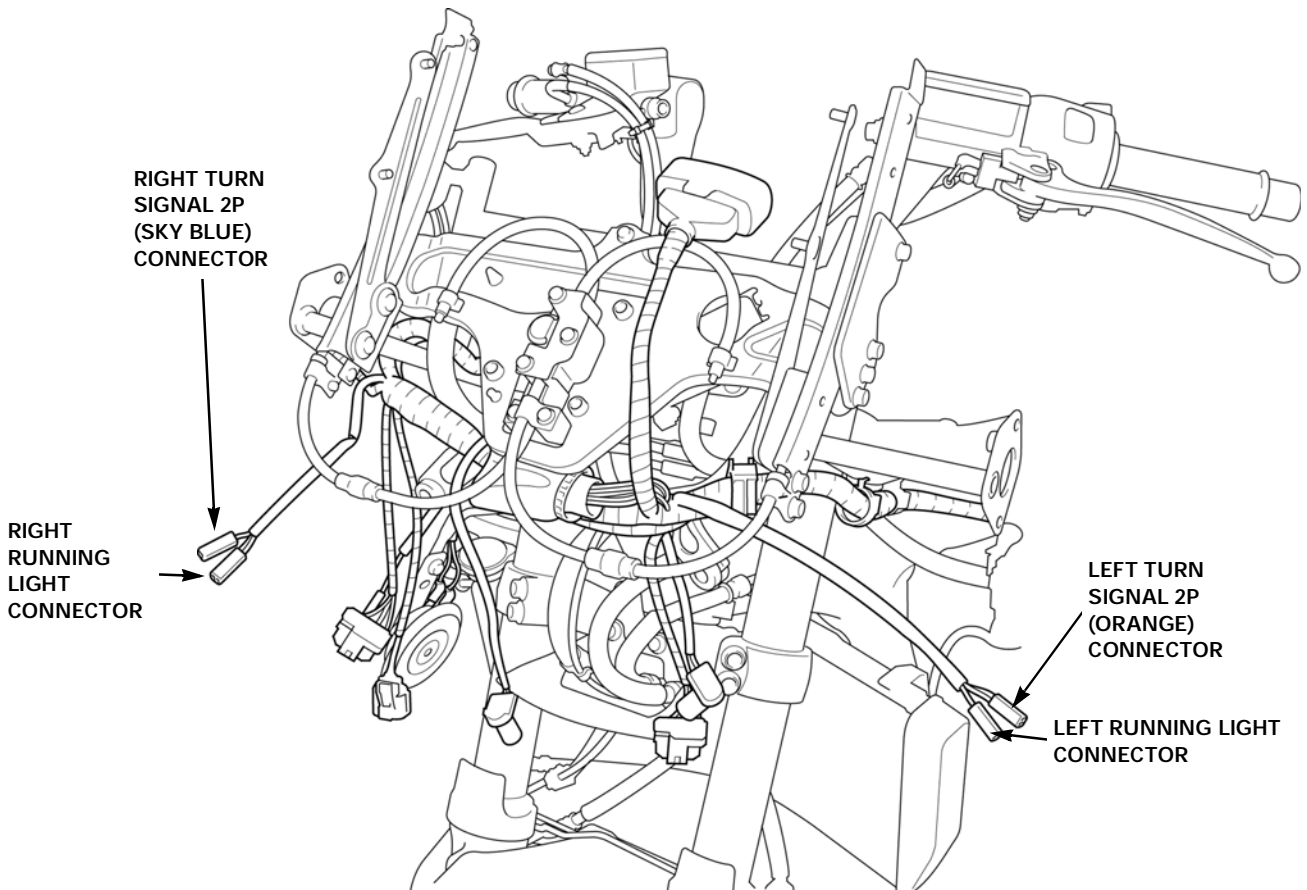
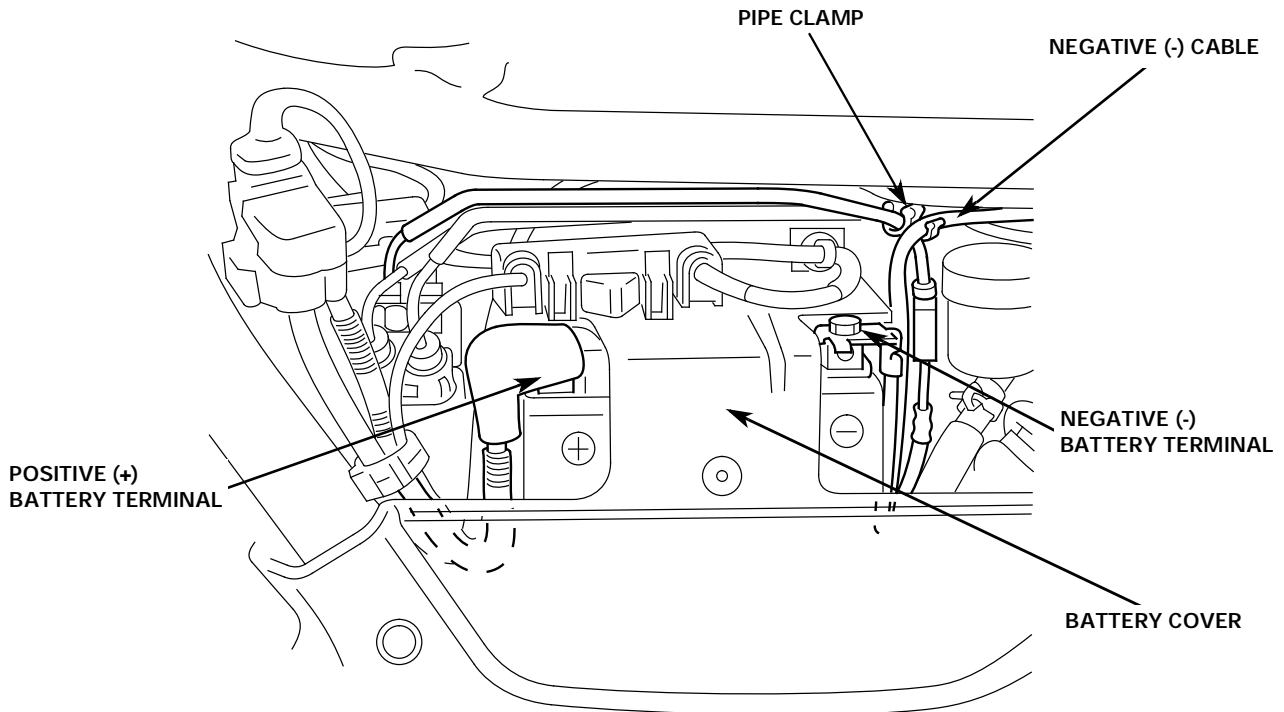



18. Service and install the battery.

PARTS	QTY
Pipe clamp	1

Service the battery only if the unit is sold or will be used as a demonstrator.

Remove the seats:

If the rear seat is installed, follow the instructions for seat removal in step 11.

Remove the front seat by pulling it back and up.

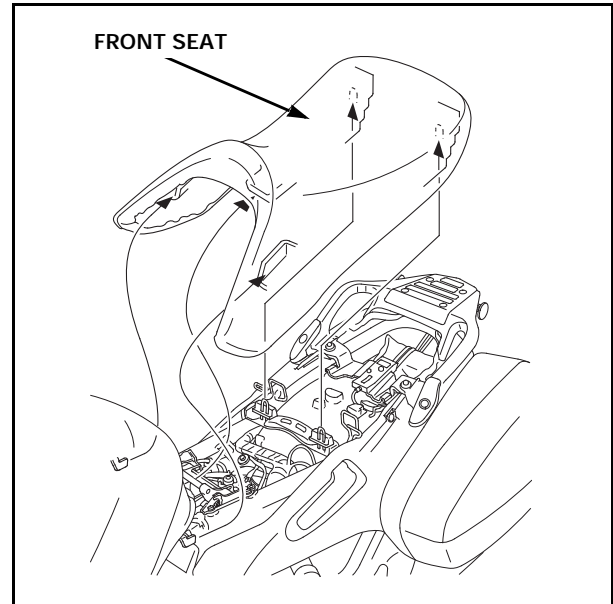

Remove the right saddlebag:

Insert the ignition key and turn it clockwise to open the latch lever.

Remove the right side saddlebag by lifting up and pulling it out.

Close the latch lever.

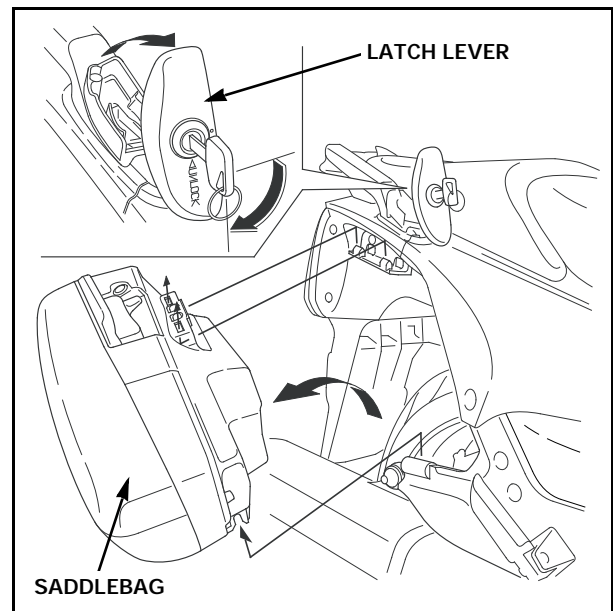

Remove the right side cover:

Remove the three screws and the right side cover.

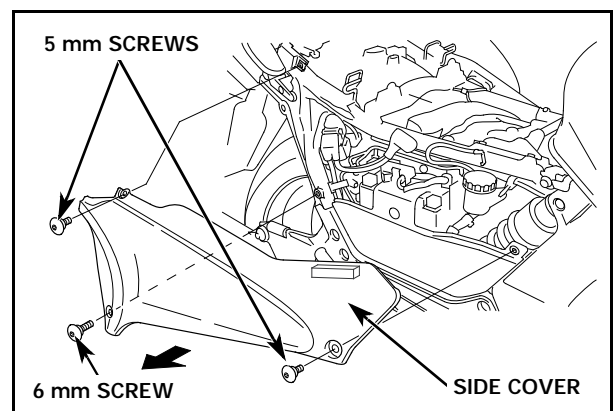

2008 ST1300/A

18. Service and install the battery (cont.)

Remove the battery cover.

Remove the battery holder by removing the bolt.

Pull the battery out of the battery box.

Remove the cap and the packed battery nuts and bolts.

The battery in this motorcycle is a pre-charged, maintenance-free type. The electrolyte has been added at the factory.

Follow the instructions included in *Service Letter #48*.

Make sure the ignition switch is in the OFF position.

Lower the battery into the battery box.

Connect the positive (+) battery cable to the positive (+) battery terminal. Then connect the negative (-) battery cable to the negative (-) battery terminal using the special bolts and nuts.

Tighten the bolts securely.

Pull the red cover over the positive terminal.

Allowing the positive (+) cable to rest on any metal parts could wear through the insulation and cause a short circuit. Do not allow the positive (+) cable to contact any metal parts.

Verify the correct battery cable routing by referring to step 17.

Reinstall the battery holder, bolts, and battery cover.

Reinstall the right side cover securing it with the three screws.

Set the pipe clamp as shown.

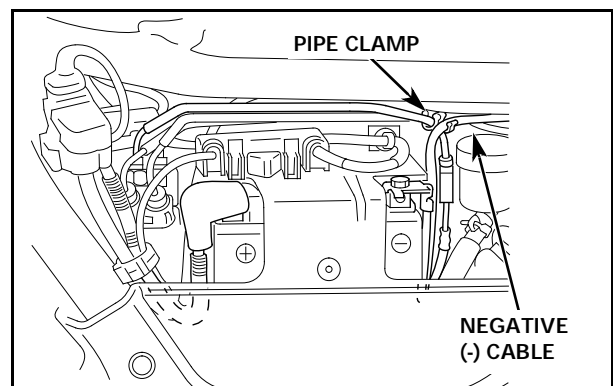
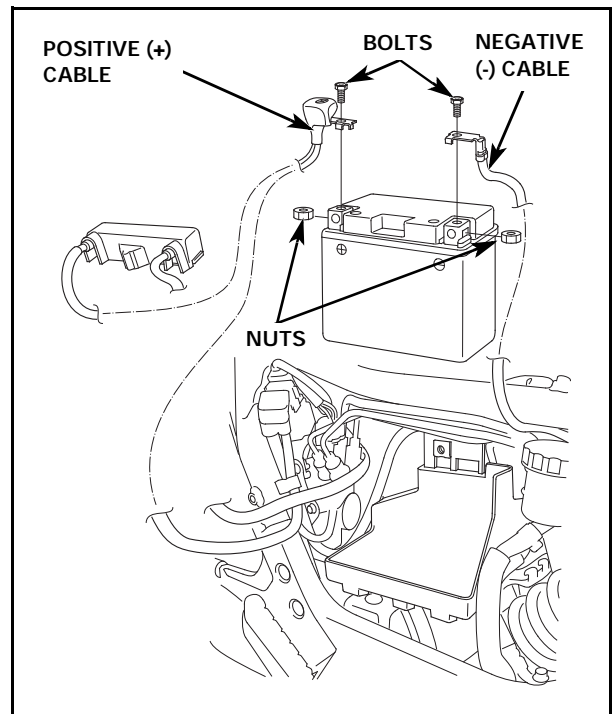
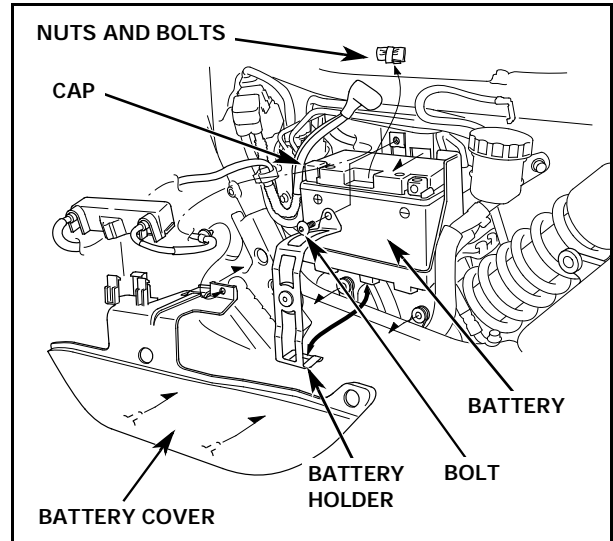



18. Service and install the battery (cont.)

Reinstall the front seat:

Reinstall the right side cover securing it with the three screws.

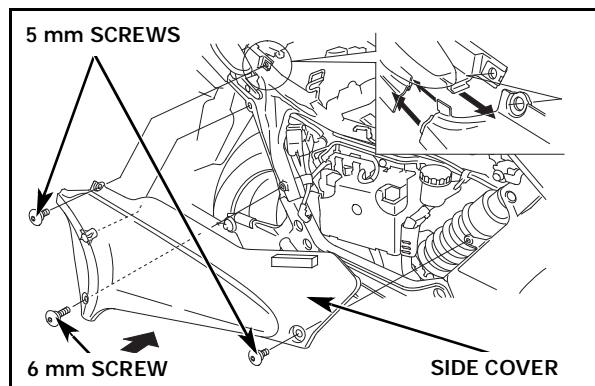

Insert the seat prong under the tank and align the two recesses with the prongs at the rear of the tank. Make sure that the seat adjustment guides align with the holes in the seat and push down on the rear of the seat to secure it into position.

Reinstall the rear seat:

Reinstall the rear seat by following the instructions in step 13.

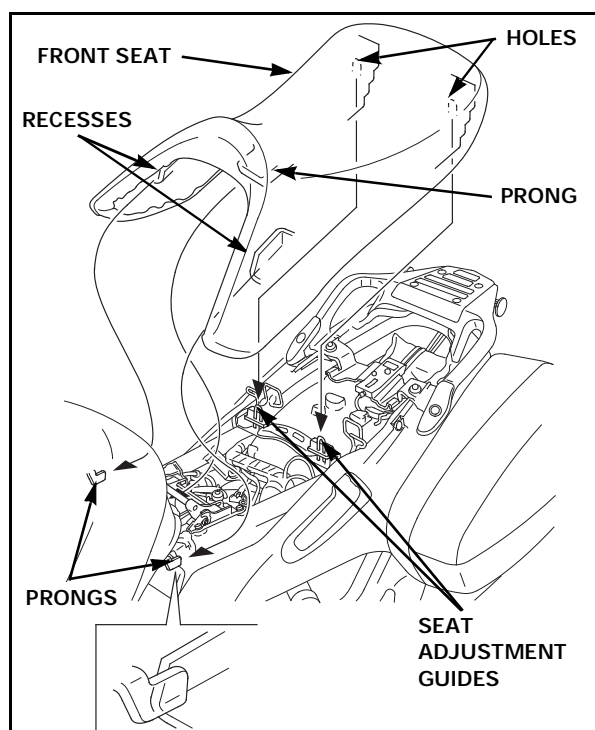

Install the right saddlebag:

Use the ignition key to open the latch lever.

Position the three slots of the saddlebag on the three hooking points on the motorcycle as shown. Check that the saddlebag engages securely.

Close the latch lever and lock it with the ignition key.

Remove the ignition key and place it in the ignition switch in the OFF position.

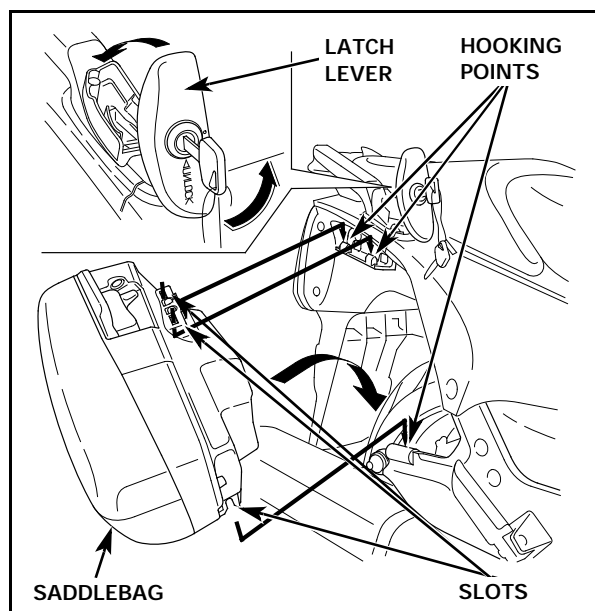

2008 ST1300/A

19. Check the coolant level.

Removing the radiator cap while the engine is hot can cause the coolant to spray out, seriously, scalding you. When removing the radiator cap, let the engine and radiator cool down.

Using coolant with silicate inhibitors may cause premature wear of water pump seals or blockage of radiator passages. Using tap water may cause engine damage. Do not spill coolant on painted or plastic surfaces as it can damage the finish.

Park the motorcycle in an upright position on a firm and leveled surface.

Check the coolant level:

Check that the coolant level is filled to the UPPER level mark.

If required, add coolant to restore the level to the UPPER level mark.

Reinstall the reserve tank cap.

- **Coolant recommendation:**
High quality ethylene glycol antifreeze containing corrosion protection inhibitors.
- **Recommended mixture:**
1:1 (Distilled water and antifreeze)

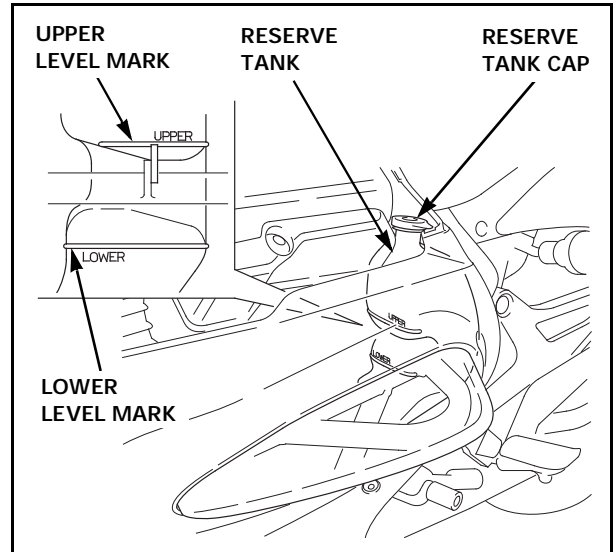

20. Verify the throttle freeplay.

Operate the throttle to confirm that it moves smoothly and returns automatically from any open position to the fully closed position in all steering positions.

Confirm the throttle grip freeplay:

Throttle freeplay:

2 – 6 mm (1/16 – 1/4 in)

Make adjustments at the throttle grip adjuster by loosening the lock nut and turning the adjuster. Tighten the lock nut after adjustment.

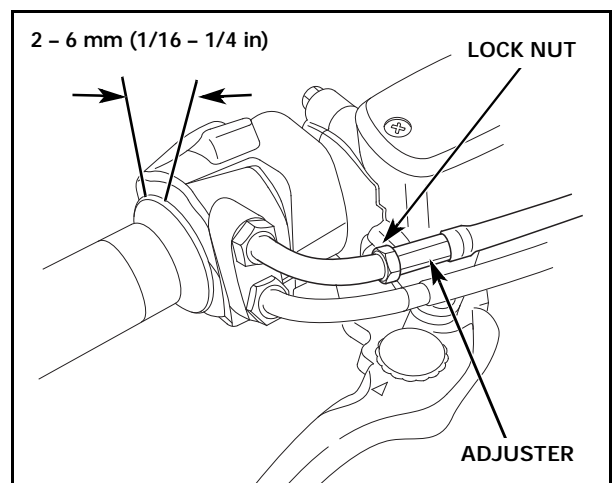



21. Check the oil level.

Before starting the engine, remove the anti-rust coating from the engine and exhaust system using a mild detergent and water. Rinse with clean water.

Park your motorcycle in an upright position on a firm, level surface.

Be careful of hot motorcycle parts and engine oil.

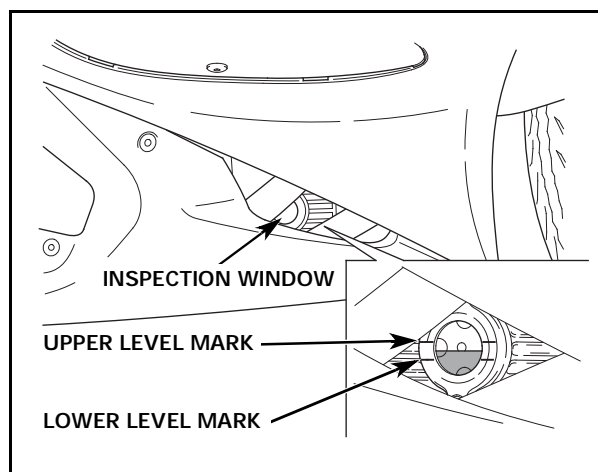

Check the inspection window to be sure the engine has oil.

Start the engine and let it idle for 3 – 5 minutes. Stop the engine and wait 2 – 3 minutes. Check the oil level following the procedure detailed above. If necessary, remove the right cylinder head over-head cover and the engine oil filler cap, add the recommended oil until it nears mid-way between the UPPER and LOWER level marks.

Do not add oil above the UPPER level mark.

- **Recommended oil: Pro Honda GN4 4-stroke oil or equivalent motorcycle oil**
- **Viscosity: SAE 10W-30**
- **Classification: SG or higher. Do not use oils labeled as energy conserving on the circular API service label.**
- **JASO 4T Service Classification: MA**
- **Crankcase capacity (after draining): 3.6 Liters (3.8 US Quarts)**

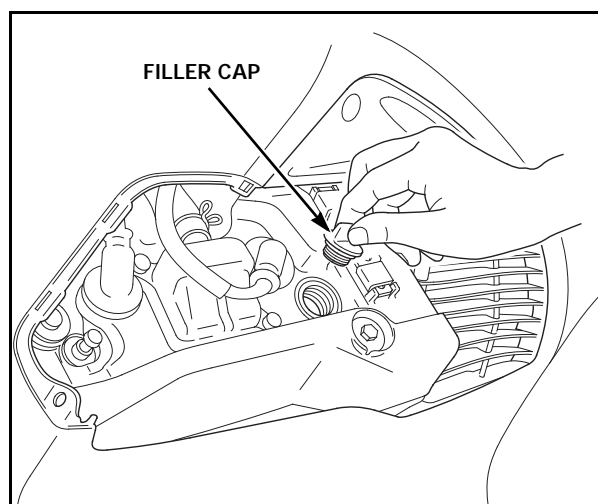

Start the engine and let it idle for 3–5 minutes, then shut it off.

Wait for 2 – 3 minutes and once again support the motorcycle upright on a firm, level surface. Check the oil level using the above procedure and, if necessary, add the recommended oil until it reaches midway between the upper and lower level marks.

Do not add oil above the upper level mark.

Reinstall the oil filler cap and right cylinder head cover.

2008 ST1300/A

22. Check the final drive oil level.

Place the motorcycle on its centerstand on a firm, level surface.

Remove the oil filler cap and check the oil level, it should be flush with the lower edge of the oil filler hole. If the level is low, check for oil leaks. Add the recommended oil through the oil filler hole until it reaches the lower edge of the opening.

Recommended oil: Hypoid gear oil SAE 80

Reinstall and torque the oil filler cap.

Torque: 12 N·m (1.2 kgf·m, 9 lbf·ft)

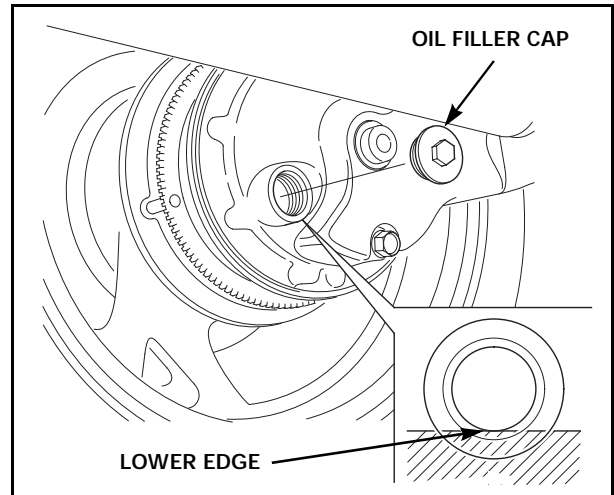

23. Check the clutch and front and rear brake reservoir fluid levels.

Turn the handlebar so the front brake reservoir is level and check the fluid level.

If the fluid level is low, remove the screws, reservoir cover, and diaphragm.

Add Pro Honda DOT 4 Brake Fluid or an equivalent from a sealed container to bring the level up to the upper level mark.

Reinstall the cap, diaphragm, cover, and screws.

Repeat the above steps to check the clutch reservoir fluid level.

Torque the screws

Torque: 1.5 N·m (0.15 kgf·m, 1.1 lbf·ft)

Support the motorcycle in an upright position on a firm, level surface and check the rear brake fluid level.

If the fluid level is low, remove the screws, reservoir cover, and diaphragm.

Add Pro Honda DOT 4 Brake Fluid or an equivalent from a sealed container to bring the level up to the upper level mark.

Reinstall the diaphragm and cover.

Operate the hand lever and foot pedal. If freeplay is excessive or the brake feels spongy, and the reservoir fluid level is correct, bleed the system.

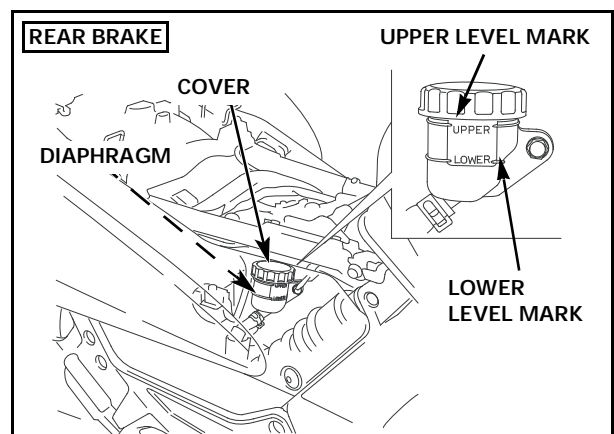
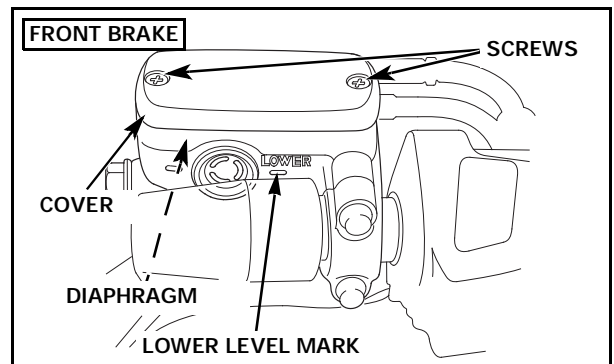
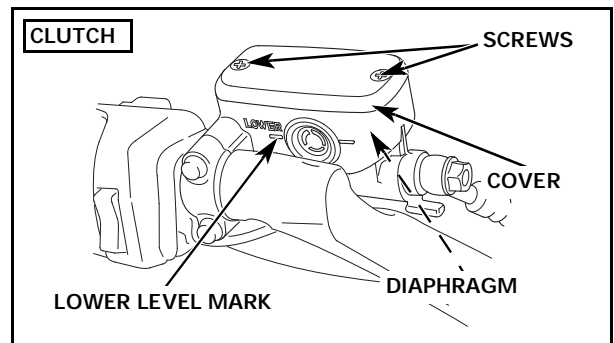



24. Check the idle speed.

Start the engine and warm it up to its normal operating temperature.

Place the motorcycle on its centerstand on a firm, level surface.

Connect a tachometer to the engine according to the manufacturer's instructions.

Verify the idle speed (rpm).

Idle speed: 1,000 ± 100 rpm

If an adjustment is needed, turn the throttle stop screw to set the idle speed using a screwdriver.

Stop the engine and remove the tachometer.

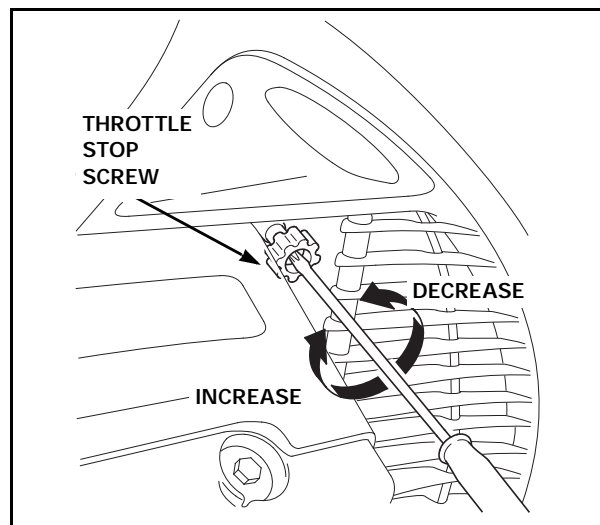

25. Check the tire pressure.

Front and rear: 42 psi.

26. Check the clutch lever and sidestand ignition cut-off switches.

When the transmission is in gear, the starter should not work unless the clutch lever is pulled in and the sidestand is up.

Position the motorcycle securely with the rear wheel raised off the ground.

Clutch lever ignition cut-off switch test:

Shift the transmission into gear.

Raise the sidestand and **without** pulling the clutch lever in, turn on the ignition, set the engine stop switch to the RUN position, and press the starter button.

If the engine starts, there is a problem with the clutch lever ignition cut-off switch.

Troubleshoot the cause.

Sidestand ignition cut-off switch test:

Shift the transmission into gear.

Lower the sidestand and **pull** the clutch lever in. Turn on the ignition, set the engine stop switch to the RUN position, and press the starter button.

If the engine starts, there is a problem with the sidestand ignition cut-off switch.

Troubleshoot the cause.

2008 ST1300/A

27. Adjust the front seat height.

The front seat height of the ST1300/A can be adjusted for rider preference.

Remove the rear seat by referring to the instructions in step 11.

Remove the front seat by following the instructions in step 18.

Move the seat height adjuster into one of the three positions on the guide as shown.

Be sure to align the holes in the rear of the front seat with the adjuster when installing the seat.

Reinstall the front seat by referring to the instructions in step 18.

Reinstall the rear seat by following the instructions in step 13.

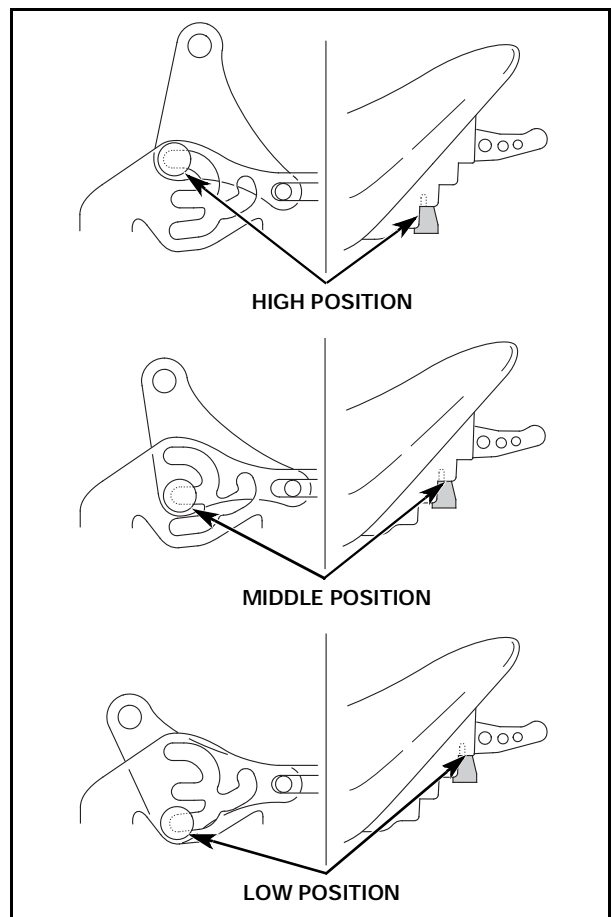
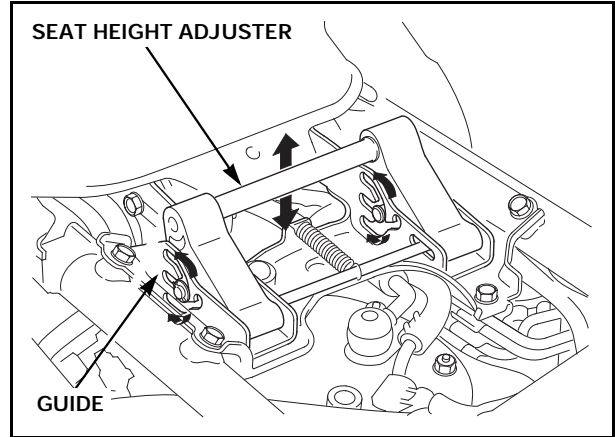



28. Complete the Set-Up/ Pre-Delivery form.

Complete an *On-Road Set-Up/Pre-Delivery Checklist* form by checking the boxes confirming that the steps were done.

NOTE: *The On-Road Set-Up/Pre-Delivery Checklist* form is available on **iN**.

Log onto **iN**.

Click **Service Publications** from the **Service** tab.

Click **Forms Library**.

Under **Category** and **Document Type**, select the form you need, then click **Search**.

After the PDF form loads, click the **Print** button. You will need two copies – one for your records, and one for your customer. Another option is to print one copy, fill in the information, then photocopy it.

Wiring Diagram - ST1300

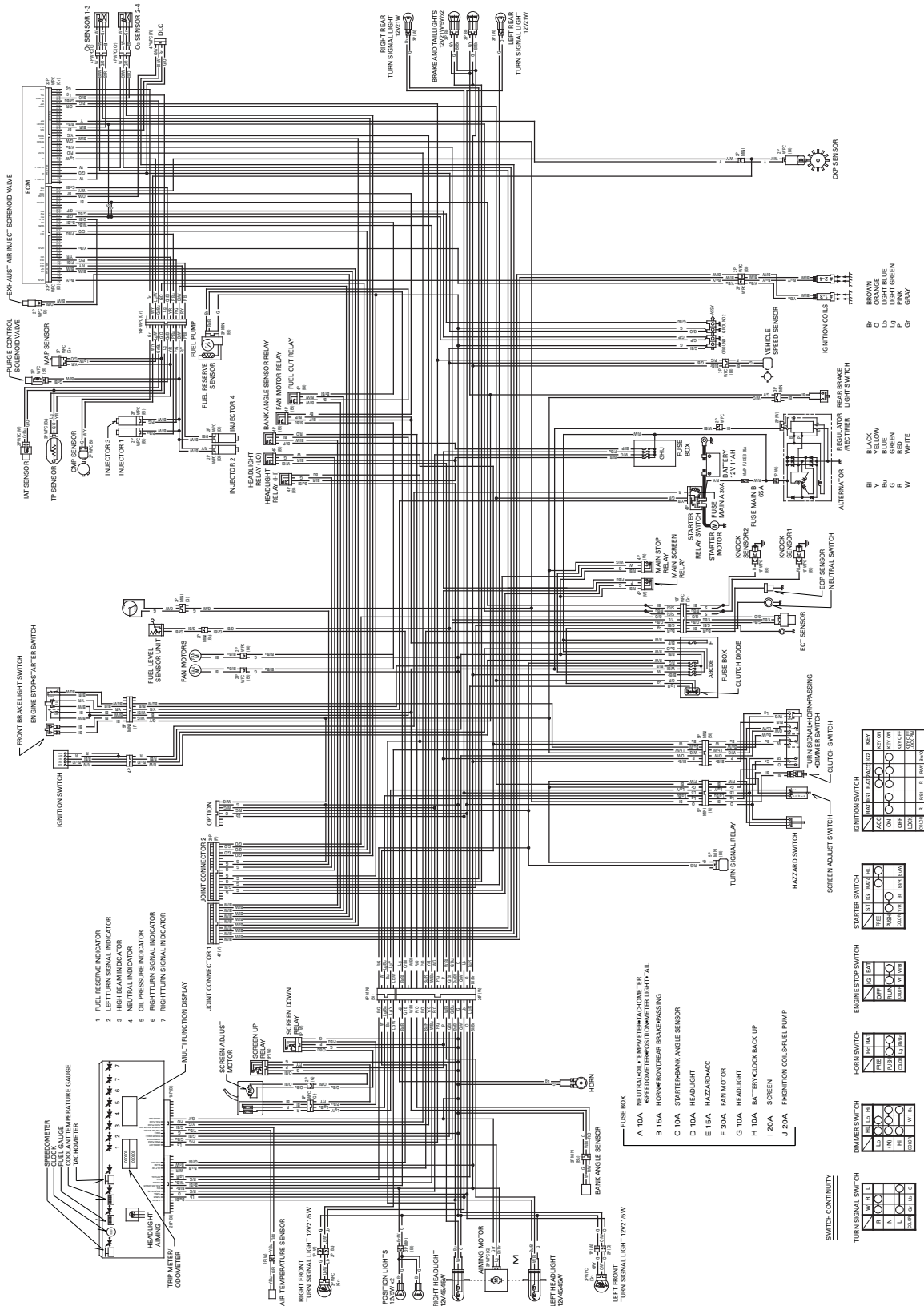



Wiring Diagram - ST1300A

