



2005 ST1300/A SET-UP INSTRUCTIONS



**Set-up and pre-delivery service
must be performed by an authorized
Honda motorcycle dealer.**

IMPORTANCE OF PROPER SET-UP AND PRE-DELIVERY SERVICE

FOR YOUR CUSTOMER'S SAFETY

Proper set-up and pre-delivery service are essential to rider safety and the reliability of the machine. Any error or oversight made by the technician assembling and servicing a new machine can result in faulty operation, damage to the machine, or injury to the rider.

WARNING

Improper set-up or pre-delivery service can create an unsafe condition that can cause your customer to be seriously hurt or killed.

Follow the procedures and precautions in this manual and the service manual carefully.

FOR YOUR SAFETY

Some of the most important safety precautions are given below. However, we cannot warn you of every conceivable hazard that can arise in performing set-up and pre-delivery service. Only you can decide whether or not you should perform a given task.

WARNING

Failure to properly follow instructions and precautions can cause you to be seriously hurt or killed.

Follow the procedures and precautions in this manual carefully.

IMPORTANT SAFETY PRECAUTIONS

Make sure you have a clear understanding of all basic shop safety practices and that you are wearing appropriate clothing and safety equipment. When performing the set-up or pre-delivery service, be especially careful of the following:

- Read the instructions before you begin, and make sure you have the tools and skills required to perform the tasks safely.
- To prevent the machine from falling on you, park it on a firm, level surface, using the proper stand(s) to provide firm support.

Make sure the engine is off before you begin any servicing procedures. This will help eliminate several potential hazards:

- **Carbon monoxide poisoning from engine exhaust**—be sure there is adequate ventilation whenever you run the engine.
- **Burns from hot parts**—let the engine and exhaust system cool before touching.
- **Injury from moving parts**—do not run the engine unless the instruction tells you to do so. Even then, keep your hands, fingers, and clothing away.

To reduce the possibility of a fire or explosion, be careful when working around gasoline or batteries. Use only a nonflammable solvent, not gasoline, to clean parts. Keep all cigarettes, sparks and flames away from the battery and all fuel-related parts.

2005 ST1300/A

How To Use This Manual

Follow the complete sequence of steps as shown. Do not short-cut any steps. The sequence has been established to ensure the unit is properly assembled.

The individual steps are composed of three components:

- **Sub-heading**—The large sub-headings are a brief description of the step. They are intended to be used by the experienced technician, one who only needs a brief reminder of the set-up sequence.
- **Descriptive text**—The descriptive text explains in detail what is to be done during that step. This explanation is intended as a guide for the technician needing additional information.
- **Photographs/Line art**—The photographs or line art support both the sub-headings and the detailed text.



Indicates the Set-up section



Indicates the Pre-delivery section

Modifications and Accessories

Modifications that you may have made, or should make in the future, to any Honda product, shall be deemed by our company to have been performed at your sole risk and responsibility, and without our company's or the manufacturer's approval, or consent, implied or expressed. We further disclaim any and all liability, obligation, or responsibility for any defects of modified parts or of the modified product, and for any claims, demands, or causes of action for damage to property or for personal injuries resulting from the modification of said Honda product.

Revised Pages

PAGE **REVISED**

ITEM

Reflector nut
Front fender bolt
Front axle bolt
Pinch bolt
Caliper bolt
Mirror bolt
Windshield bolt
Windshield cover screws

Torque Table

SIZE

6 mm
6 mm

8 mm
8 mm
6 mm
6 mm
4 mm

TORQUE

12 N·m (1.2 kgf·m, 9 lbf-ft)
12 N·m (1.2 kgf·m, 9 lbf-ft)
79 N·m (8.1 kgf·m, 58 lbf-ft)
22 N·m (2.2 kgf·m, 16 lbf-ft)
31 N·m (3.2 kgf·m, 23 lbf-ft)
12 N·m (1.2 kgf·m, 9 lbf-ft)
12 N·m (1.2 kgf·m, 9 lbf-ft)
1.0 N·m (0.1 kgf·m, 8.4 lbf-in)



1. Remove the carton cover.

The 2005 ST1300/A is crated in one of two ways. You may receive either one.

Covered crate:

Cut the strap and remove the carton cover. Remove the inner cardboard frame cover.

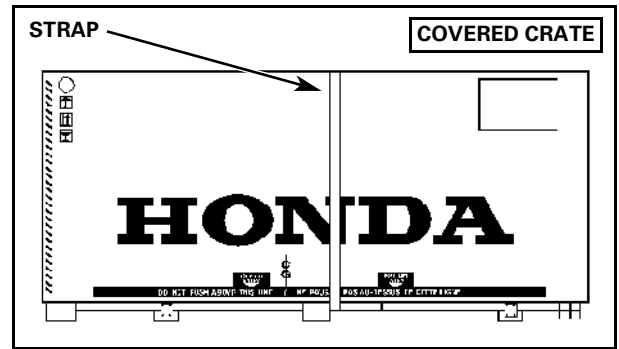

Uncovered crate:

When stacking crates, protect the motorcycle from falling objects and bad weather.

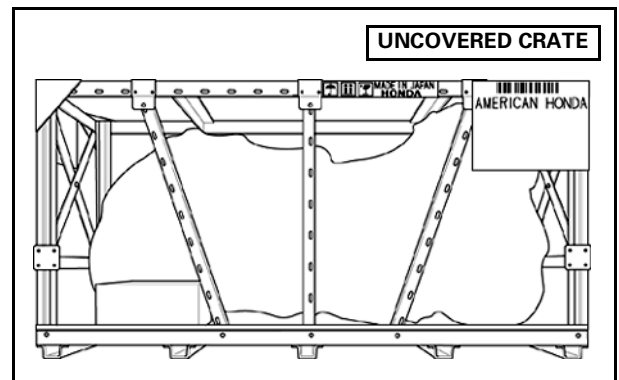

2. Check for damage.

Check the unit for hidden damage.

If you find damage, follow the instructions on the *Delivery and Damage Claims Guidelines* wall chart (Reorder No. S0477) before proceeding.

3. Remove the side braces, wheel, loose parts carton, and crate frame.

Remove the ties securing the front wheel and loose parts cartons.

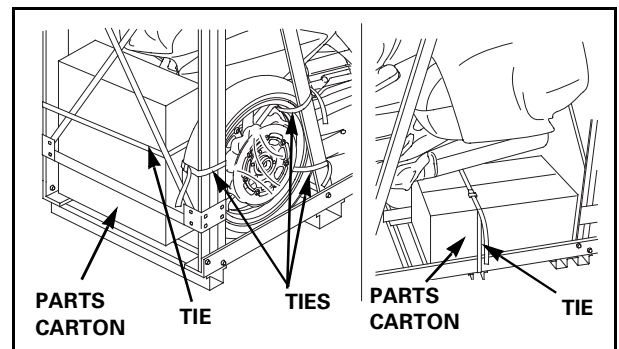

2005 ST1300/A

3. Remove the side braces, wheel, loose parts carton, and crate frame (cont.).

Remove the bolts and side braces, being careful not to damage the front wheel.

Remove the loose parts cartons.

Keep the *Riding Tips & Practice Guide* and hand deliver to the customer at the time of delivery.

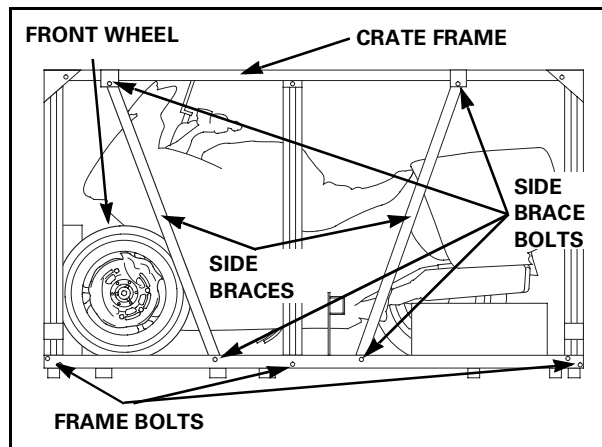

Remove the nuts, plate, and bolts.

Using two people, carefully remove the crate frame, being careful not to damage the motorcycle.

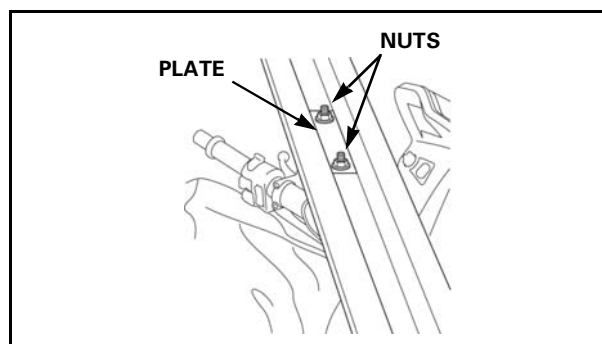



4. Loose Parts Information.

Unpack the remaining loose parts and check them against this illustration. Report any damaged or missing parts immediately to American Honda by calling (800) 421-1900, ext. 1.

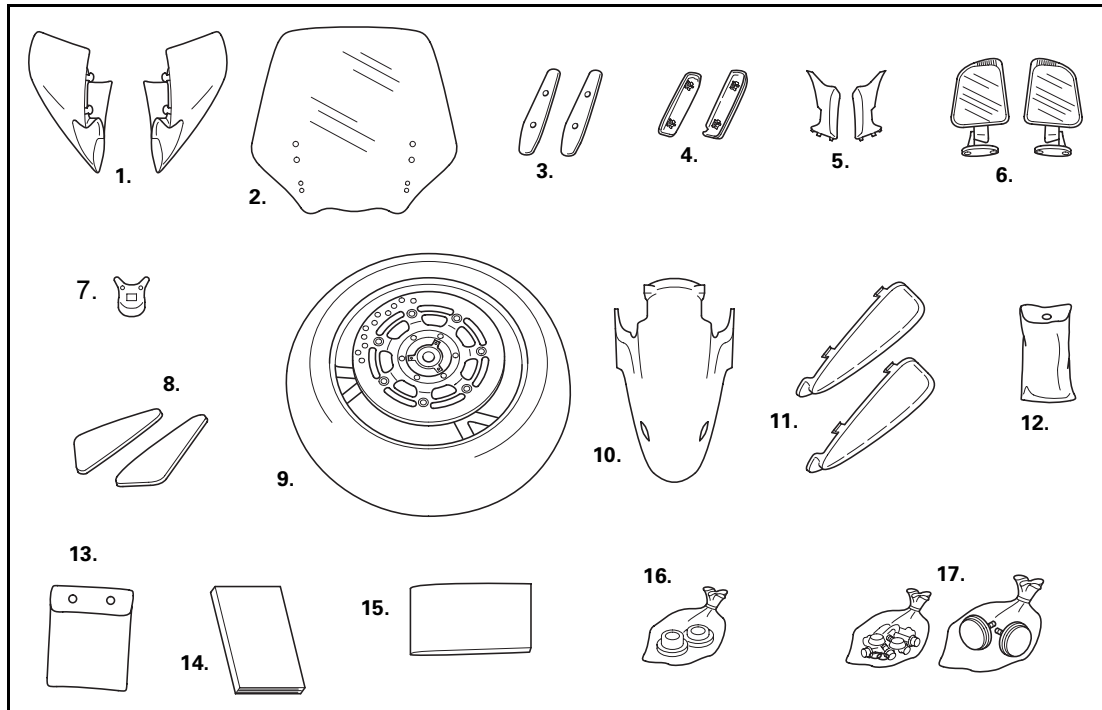

DESCRIPTION	QTY	PART NUMBER	STEP
1. Cover, R, mirror	1	88111-MCS-G00ZF	8
Cover, L, mirror	1	88121-MCS-G00ZF	
2. Windshield	1	64150-MCS-G00	9
3. Cover, windshield	2	64151-MCS-G00	9
4. Cover, R, windshield bracket	1	64183-MCS-G00	9
Cover, L, windshield bracket	1	64188-MCS-G00	
5. Rubber, R, mirror cover	1	88112-MCS-G00	8
Rubber, L, mirror cover	1	88122-MCS-G00	
6. Rear view mirror, R	1	88110-MCS-G01	8
Rear view mirror, L	1	88120-MCS-G01	
7. Cover, handlebar	1	53115-MCS-G00ZA	10
8. Pad, R, knee grip***	1	17506-MCS-G01	15
Pad, L, knee grip***	1	17507-MCS-G01	
9. Front wheel assembly	1	-----	7
10. Front fender	1	61100-MCS-G00ZG	6
11. Cover, R, engine guard	1	64260-MCS-G01	14
Cover, L, engine guard	1	64265-MCS-G01	
12. Tool kit	1	-----	12
13. Owner's Manual bag	1	83642-MN5-000	12
14. Owner's Manual	1	31MCS620*	12
15. Riding Tips & Practice Guide	1	G0045**	3

(Continued on next page.)

2005 ST1300/A

4. Loose parts information (cont.).

	DESCRIPTION	QTY	PART NUMBER	STEP
16.	Collar, R, FR, wheel side	1	44311-MCS-G00	7
	Collar, L, FR, wheel side	1	44312-MCS-G00	
17.	Attaching parts:			
	Washer, rubber	2	18325-MBV-000	6
	Screw, pan 6 x 20 mm	2	90138-MCS-G00	6
	Bolt, socket 6 x 18 mm	2	96600-06018-00	6
	Bolt, flange 6 x 16 mm	2	96001-06016-07	6
	Reflector, front	2	33741-413-013	6
	Stay, front reflector	2	33742-MCS-L00	6
	Nut, flange 6 mm	2	94050-06000	6
	Bolt, flange 6 x 20 mm	4	96001-06020-00	8
	Hose clip	4	95002-02100	8
	Plastic retainer	4	64509-MK4-000	9
	Collar, side cover	4	61104-435-000	9
	Bolt, flange 6 x 18 mm	4	96001-06018-07	9
	Screw, pan 4 x 25 mm	4	90126-MCS-G00	9
	Rubber, adjuster	2	64175-MCS-G00	9
	Special screw 4 x 6.5 mm	2	90136-MCS-G00	10
	Screw, pan 6 x 11 mm	2	90106-KY2-701	14

* If missing, order from Helm Inc.

** If missing, order from Resolve Corp.

*** Optional parts. Hand the knee pads to the customer at the time of delivery or install if the customer wants them installed (see step 15).

Missing Parts or Shipping Damage

Identify missing parts by referring to the *Loose Parts Information* section. Order the parts using normal parts ordering procedures. Claims for missing loose parts or those damaged during transit should be submitted to American Honda, not the carrier. After completing repairs, submit a Transportation Claim via **iN**. For complete details, please refer to the Warranty Policy and Procedures Manual.



5. Remove the motorcycle from the crate base.

Install lifting slings on the engine guards and grab rail as shown.

If necessary, use a spreader board to prevent the slings from damaging the motorcycle.

Lift the slings just enough to remove the slack.

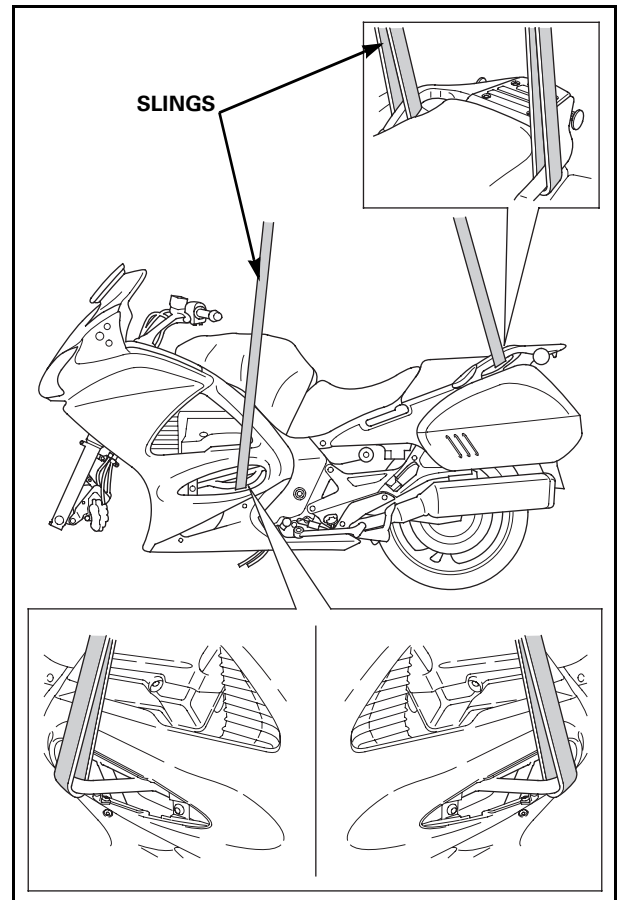

Loosen the axle bolt and axle pinch bolts.

Remove the bolts, washers, and lower shipping bracket from the crate base.

Discard the bolts and washers.

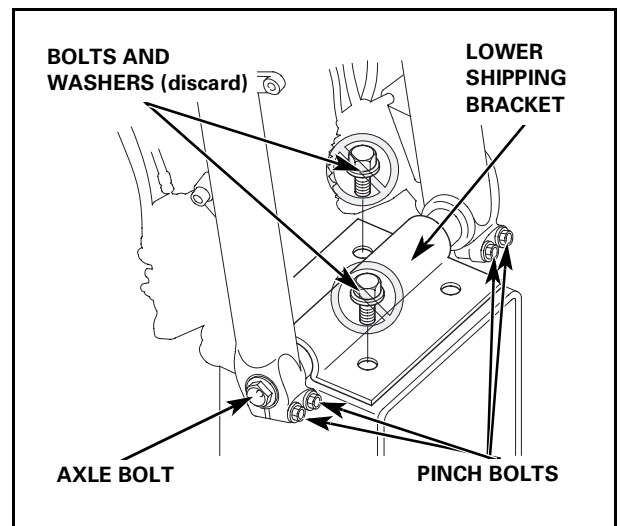

2005 ST1300/A

5. Remove the motorcycle from the crate base (cont.).

Remove the shipping braces, nuts, and protective covering from the foot pegs on both sides of the motorcycle.

Lift the motorcycle free from the crate base and remove the base.

On a firm, level surface, lower the centerstand and lower the motorcycle until it is resting on its rear wheel and centerstand.

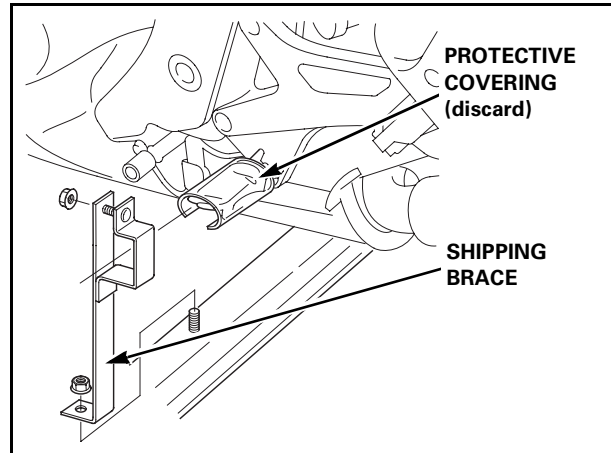

6. Install the front fender.

Remove the axle bolt.

Remove the axle protective covering and axle shaft.

Position the reflector stays on the inside of the front fender by aligning them with the projections on the front fender. Install the reflector stays with two 6 x 20 mm pan head screws and rubber washers.

Secure the reflectors to the stays with two 6 mm nuts.

Torque the nuts.

Torque: 12 N·m (1.2 kgf·m, 9 lbf·ft)

Position the front fender between the fork legs and attach it to the fork stays with two 6 x 18 mm socket bolts. Secure the brake hose stays with two 6 x 16 mm flange bolts.

Torque the bolts.

Torque: 12 N·m (1.2 kgf·m, 9 lbf·ft)

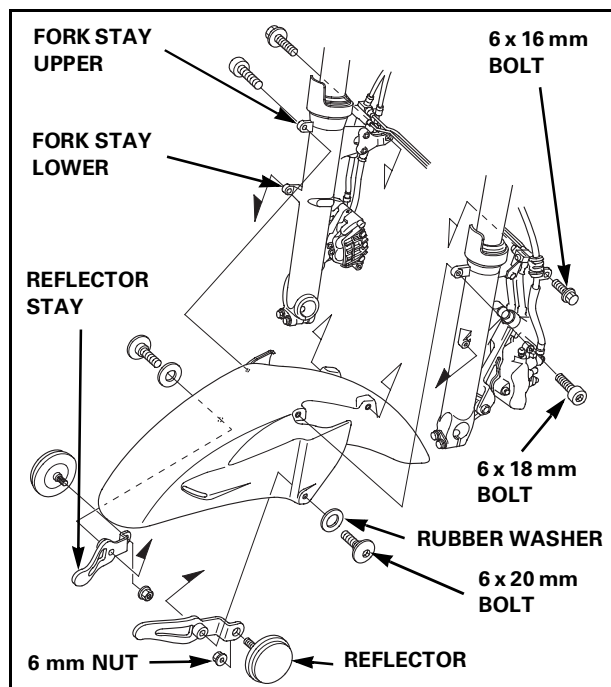
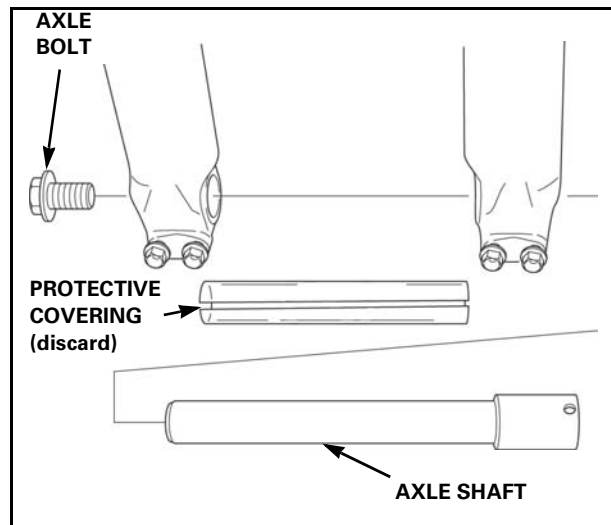



7. Install the front wheel.

Clean both sides of the front brake discs with a clean shop towel and Pro Honda Brake Cleaner or equivalent.

Remove the caliper mounting bolts. Be careful not to get dust and dirt on the ends of the mounting bolts.

Note that a single 8 x 45 mm caliper bolt is attached to the lower left fork leg.

Note that the shoulders on each wheel collar are of different sizes. It is important to install them with the correct sides facing the wheel.

Install the 16.5 mm left-side collar with the 10 mm deep shoulder side facing the wheel.

Install the 27.5 mm right-side collar with the 34 mm outside diameter shoulder facing the wheel.

Position the front wheel between the fork legs.

Slide the axle shaft through the left fork leg, the 16.5 mm left-side collar, front wheel, 27.5 mm right-side collar, and right fork leg.

Push in on the axle shaft so the left end of the axle shaft is flush with the surface of the left fork leg.

Install and tighten the axle bolt to the specified torque.

Torque: 79 N·m (8.1 kgf·m, 58 lbf·ft)

Tighten the left, then the right axle pinch bolts to the specified torque.

Torque: 22 N·m (2.2 kgf·m, 16 lbf·ft)

On ST1300A, verify the clearance between the ABS front pulser ring and sensor is as shown.

Reinstall the caliper bolts and tighten to the specified torque.

Torque: 31 N·m (3.2 kgf·m, 23 lbf·ft)

Clean both sides of the rear brake disc with a clean shop towel and Pro Honda Brake Cleaner or equivalent.

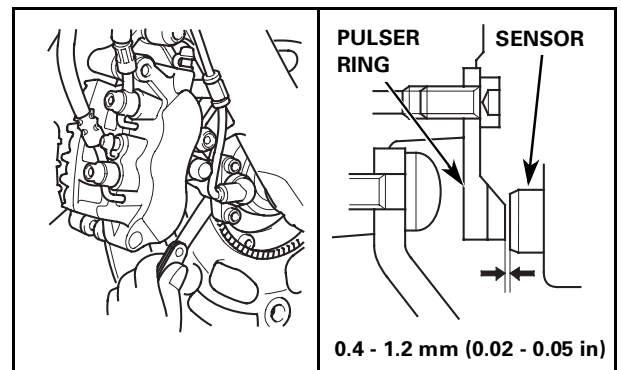
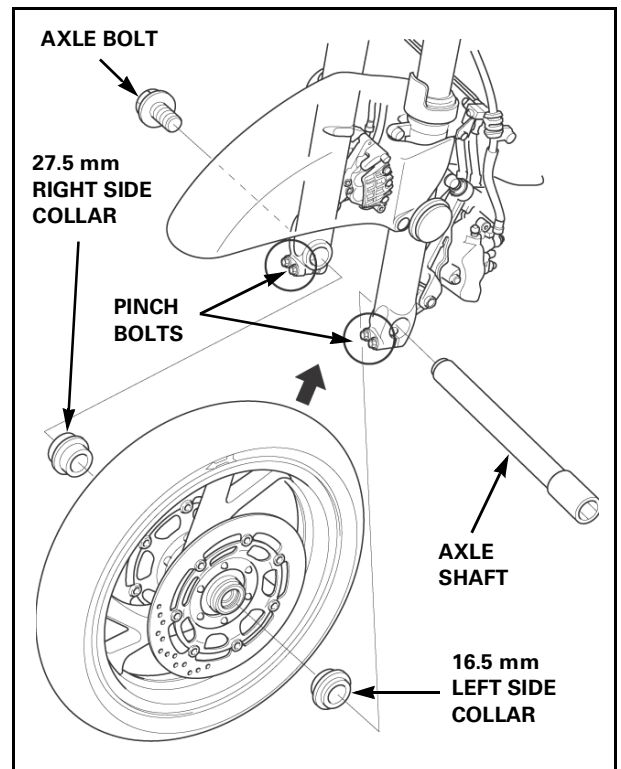
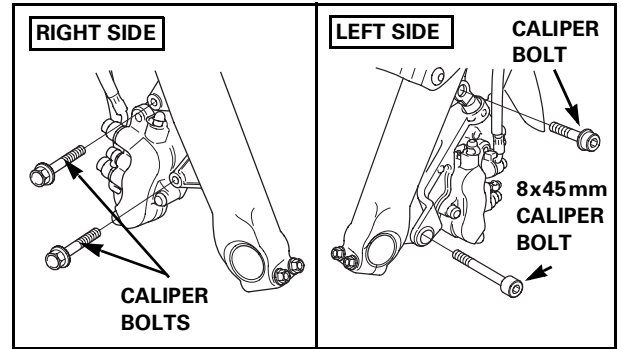

2005 ST1300/A

8. Install the mirrors.

Remove and discard the shipping bolts. Install the right and left rear view mirrors using two 6 x 20 mm flange bolts on each side.

Torque the bolts.

Torque: 12 N·m (1.2 kgf·m, 9 lbf·ft)

Install the two hose clips as shown.

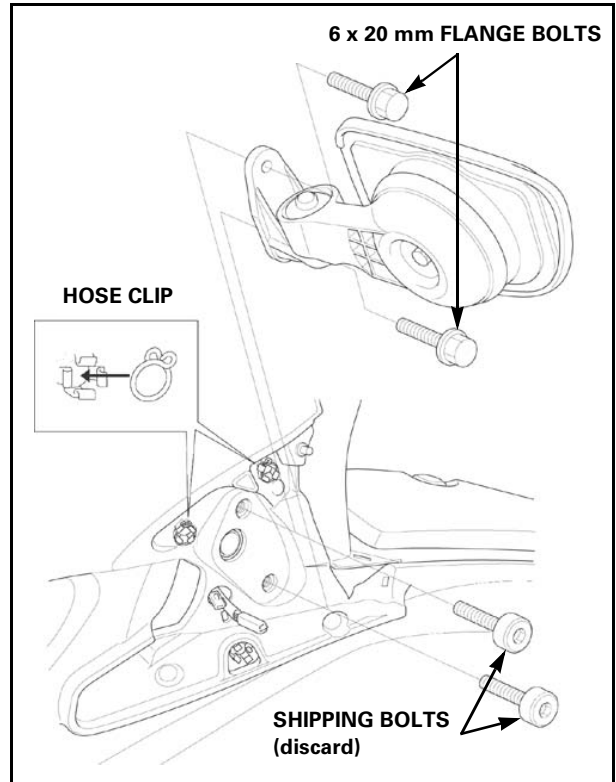

Connect the wiring harness terminals as shown, then push the end of the suspension band into the hole in the body.

Install the mirror rubber covers, then install the mirror covers.

Check that the mirror rubber cover and mirror cover are installed securely.

Complete this installation for both sides of the motorcycle.

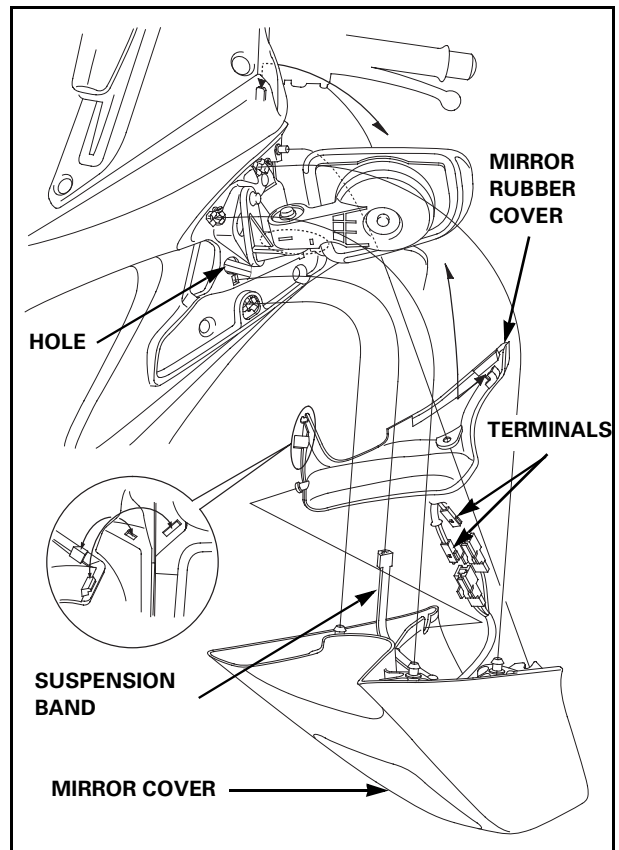



9. Install the windshield.

Note that the windshield adjusters are installed as shown, however, they can be reinstalled according to rider preference.

To install the windshield, use two people to carefully install the following parts in the order indicated below:

- Adjuster rubbers
- Windshield
- Plastic washers
- Collars
- 6 x 18 mm flange bolts

Torque the bolts.

Torque: 12 N·m (1.2 kgf·m, 9 lbf·ft)

Then, install the following:

- Covers
- Windshield bracket covers
- 4 x 25 mm pan screws

Torque the pan screws.

Torque: 1 N·m (0.1 kgf·m, 8.4 lbf·in)

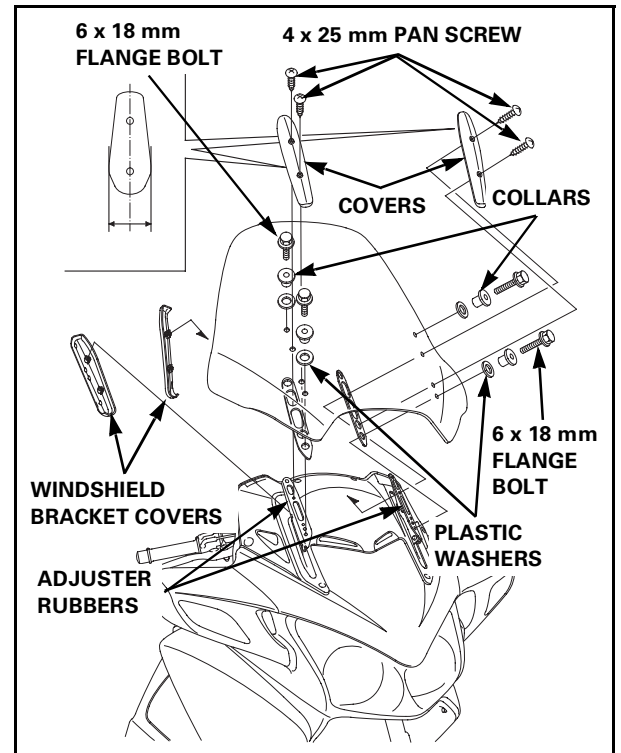

10. Install the handlebar cover and saddlebag lever lock.

Remove the ignition switch key from the ignition.

Attach the handlebar cover using two 4 x 6.5 mm special screws.

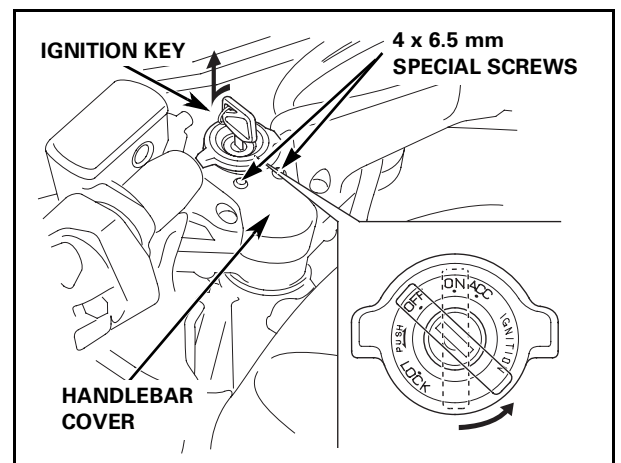

2005 ST1300/A

10. Install the handlebar cover and saddlebag lever lock (cont.).

Open the left fairing pocket with the ignition key.

Take out the saddlebag lever locks from the left fairing pocket.

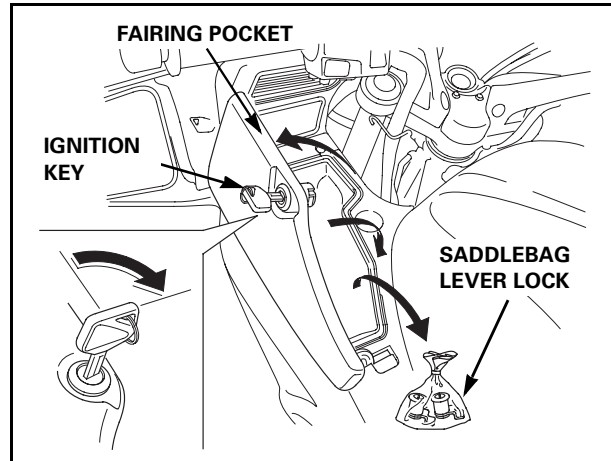

Insert the ignition switch key into the saddlebag lever lock and turn it clockwise to the position shown.

Push in on the saddlebag lever lock while aligning it with the cutout in the saddlebag as shown.

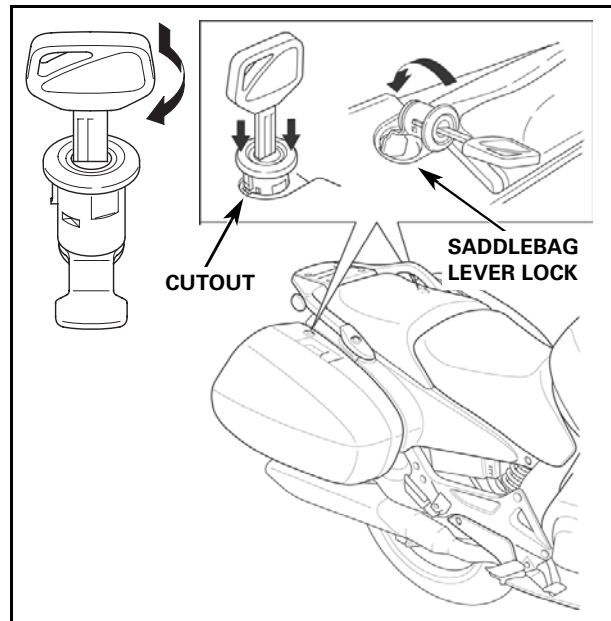

11. Remove the rear seat.

Insert the ignition key and turn it clockwise to open the latch lever.

Pull the rear seat back and up while depressing the seat opener.

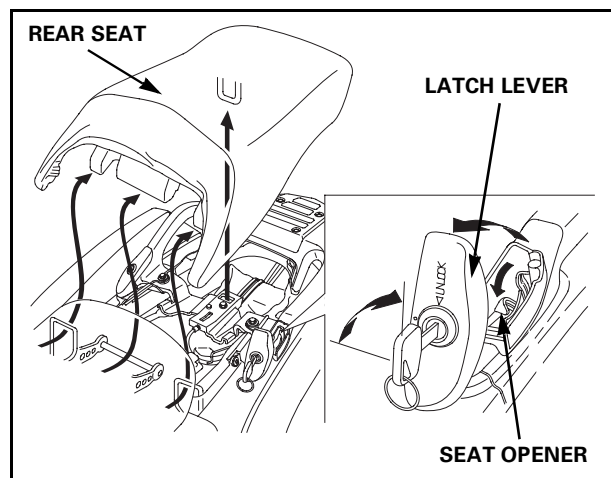



12. Store the tool kit and Owner's Manual.

Place the tool kit under the rear seat and secure it with the tool band.

Place the Owner's Manual into its bag and place it on top of the tool kit.

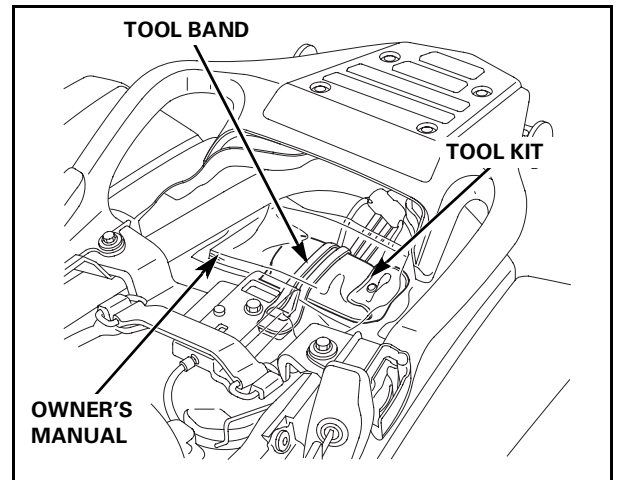

13. Install the rear seat.

Note: If the pre-delivery steps will be completed directly after set-up, leave the rear seat off until after step 16.

Insert the prong into the recess under the frame cross member, then push down on the rear of the rear seat.

Close the latch lever and turn the ignition key counterclockwise.

Be sure the seat is locked securely in position.

Place the ignition key into the ignition.

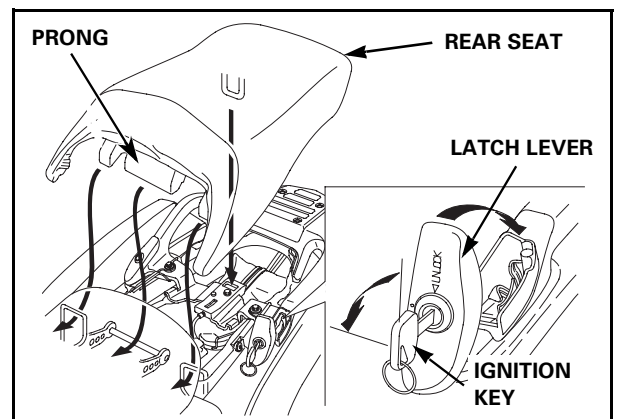

14. Install the engine guard covers.

Install the engine guard covers and secure them with a 6 x 11 mm pan head screw.

Complete the installation on both sides of the motorcycle.

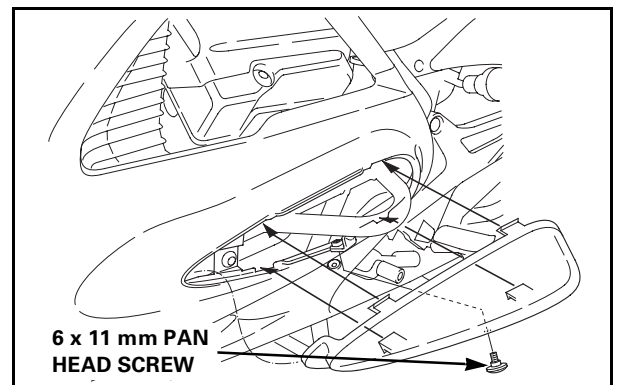

2005 ST1300/A

15. Install the fuel tank knee grip pads.

Install the optional knee pads if the customer requests them to be installed.

If the unit has not been sold, store the pads in the right saddlebag.

Clean the mating surfaces of the fuel tank with a clean shop towel and isopropyl alcohol or equivalent.

Peel off the backing sheets and attach the pads to the sides of the fuel tank 30 mm (1 13/16 in) from the lower front edges of the tank, as shown in the illustration.

If the ambient temperature is 77°F or below, warm the mating surfaces of the tank and the pad's adhesive side with a hair dryer before attaching.

After attaching the pads, press down firmly over the entire area of the pad to ensure maximum adhesion.

Avoid washing the motorcycle or riding in wet conditions for 24 hours after attaching the pads.

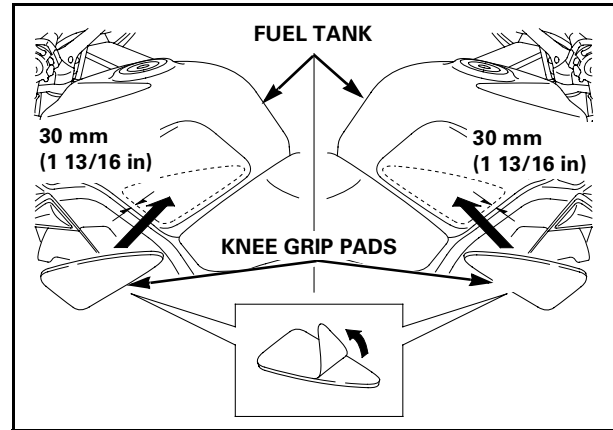



16. Verify the proper routing of the cables, hoses, and wire harnesses.

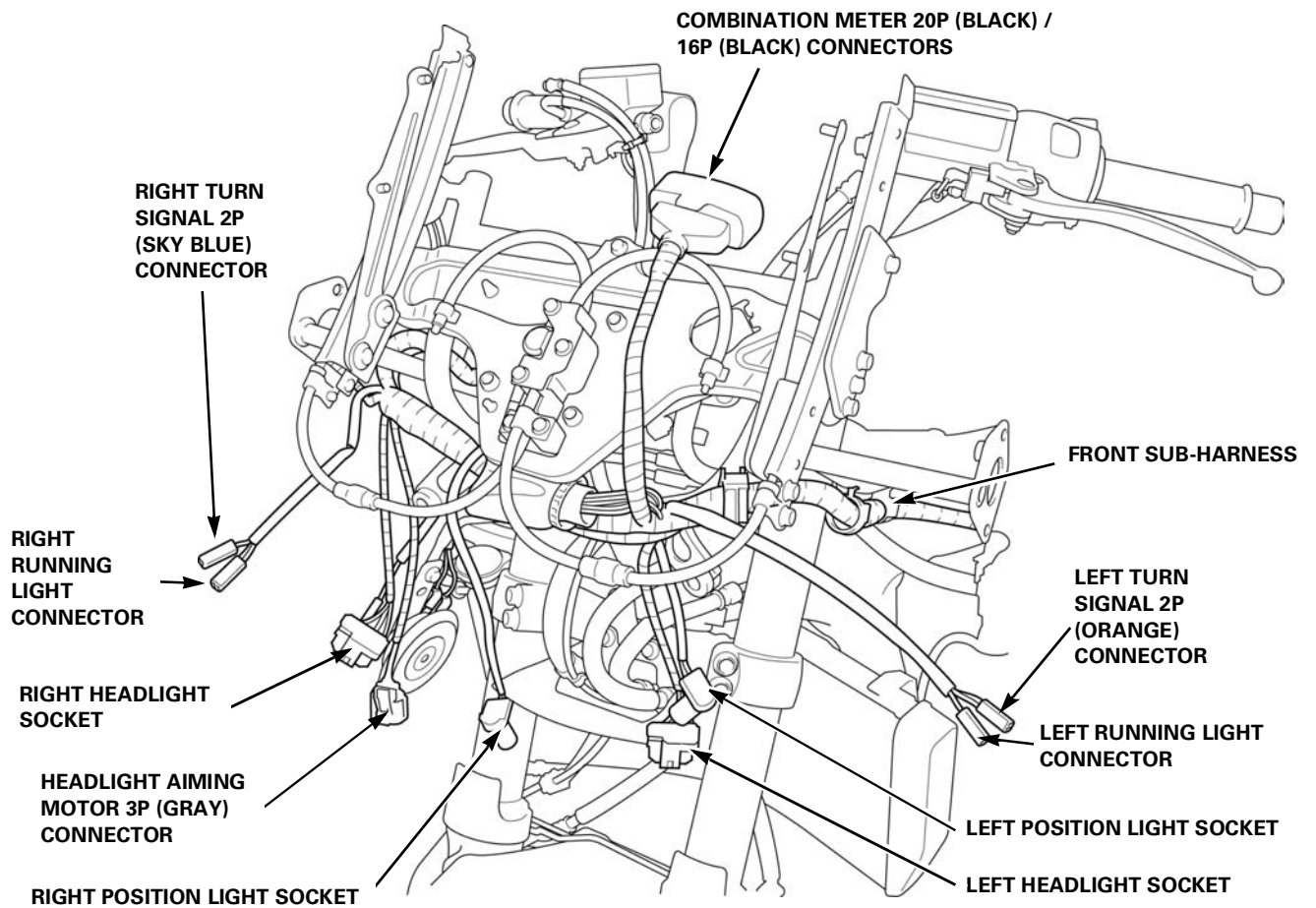
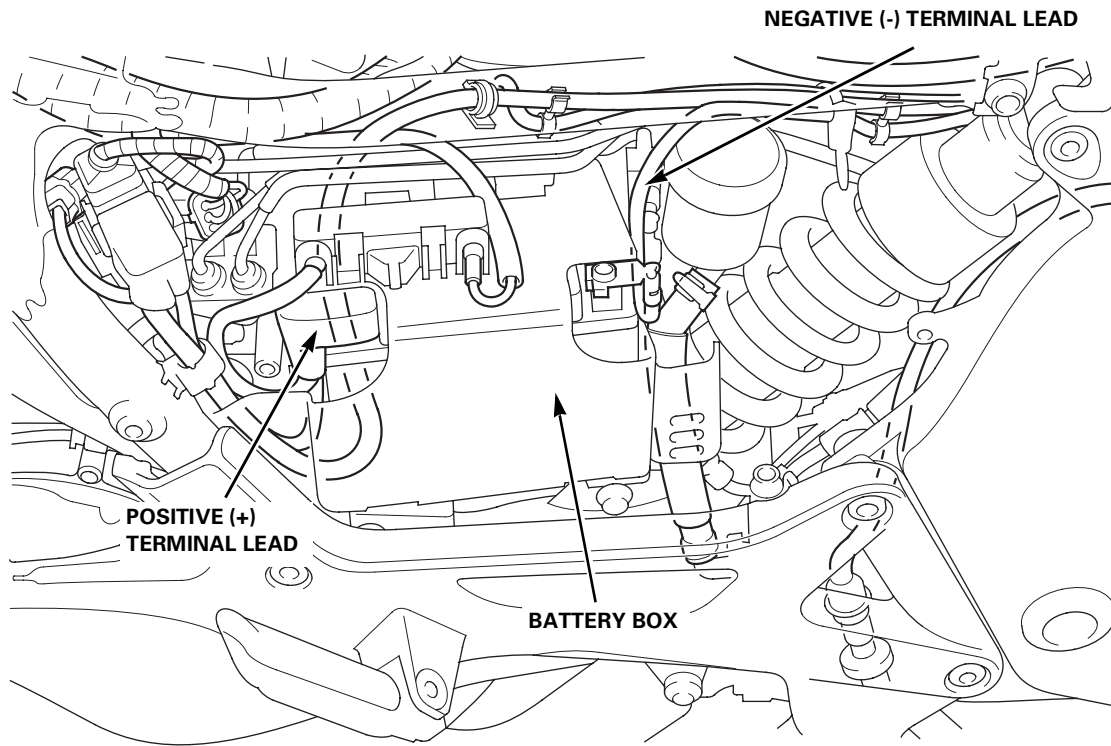

2005 ST1300/A

17. Service and install the battery.

Service the battery only if the unit is sold or will be used as a demonstrator.

Remove the seats:

If the rear seat is installed, follow the instructions for seat removal in step 11 on page 10.

Remove the front seat by pulling it back and up.

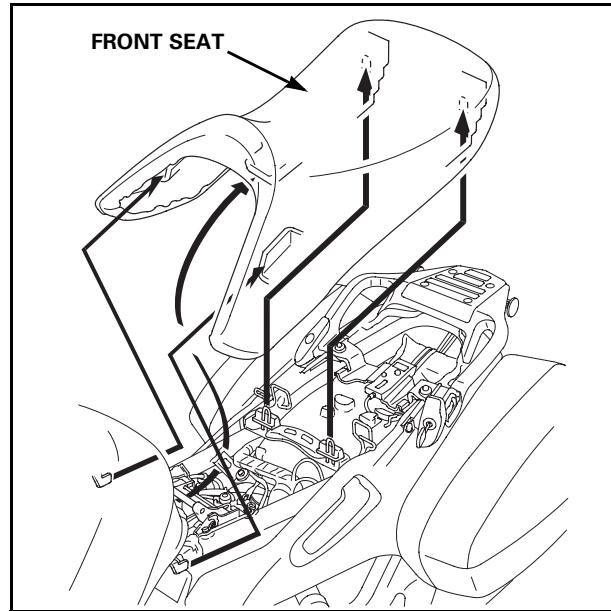

Remove the right saddlebag:

Insert the ignition key and turn it clockwise to open the latch lever.

Remove the right side saddlebag by lifting up and pulling it out.

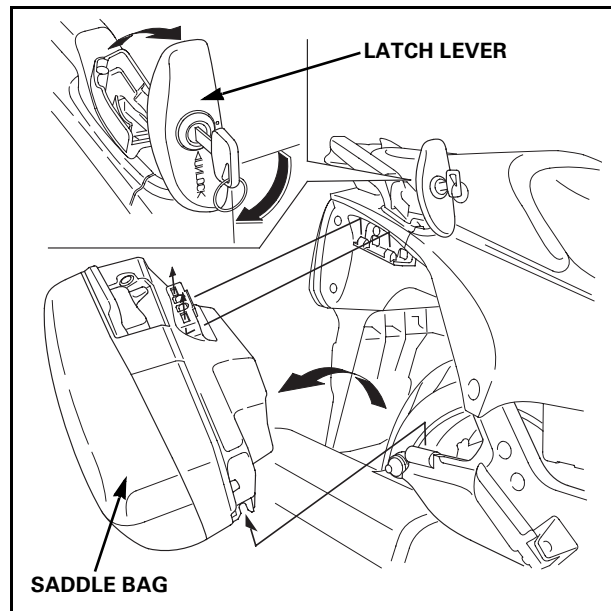

Remove the right side cover:

Remove the bolts and the right side cover.

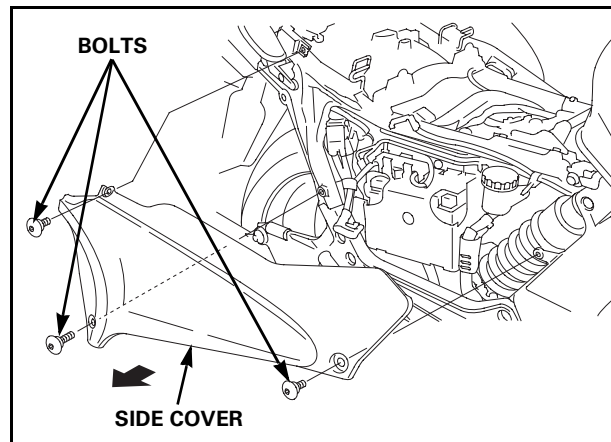



17. Service and install the battery (cont.).

Remove the battery cover.

Remove the battery holder by removing the bolt.

Pull the battery out of the battery box.

The battery in this motorcycle is a pre-charged, maintenance-free type. The electrolyte has been factory installed in the battery.

Follow the instructions included in *Service Letter #48*.

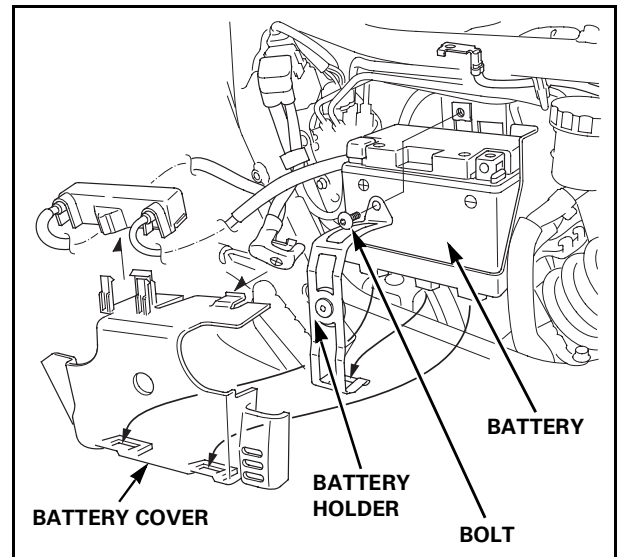

Make sure the ignition key is in the OFF position.

Set the battery into the battery box.

Connect the positive (+) battery cable to the positive (+) battery terminal. Then connect the negative (-) battery cable to the negative (-) battery terminal using the special bolts and nuts.

Tighten the bolts securely.

Coat both terminals with clean dielectric grease and pull the red cover over the positive terminal.

Allowing the positive (+) terminal to rest on any metal parts could wear through the insulation and cause a short circuit. Do not allow the positive (+) cable to contact any metal parts.

Reinstall the battery holder, bolts, battery cover, side cover and saddlebag in the reverse order of removal.

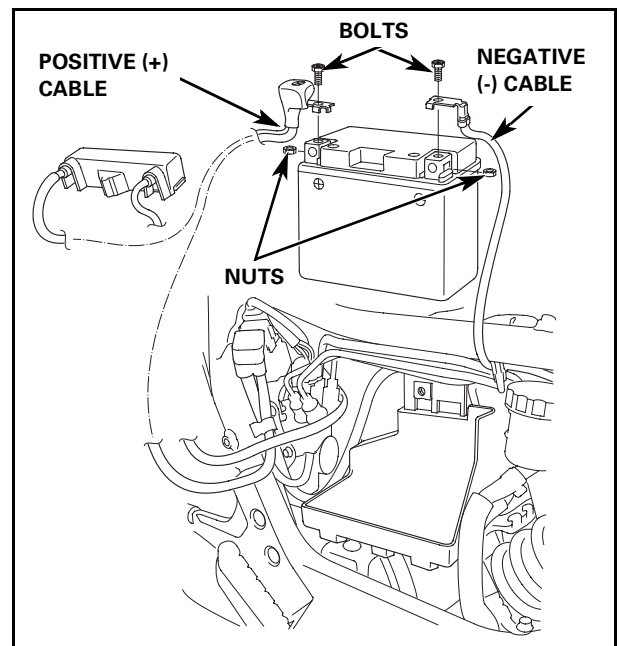

2005 ST1300/A

17. Service and install the battery (cont.).

Reinstall the front seat:

Insert the seat prong under the tank and align the two recesses with the prongs at the rear of the tank. Make sure that the seat adjustment guides align with the holes in the seat and push down on the rear of the seat to secure it into position.

Reinstall the rear seat:

Reinstall the rear seat by following the instructions in step 13 on page 11.

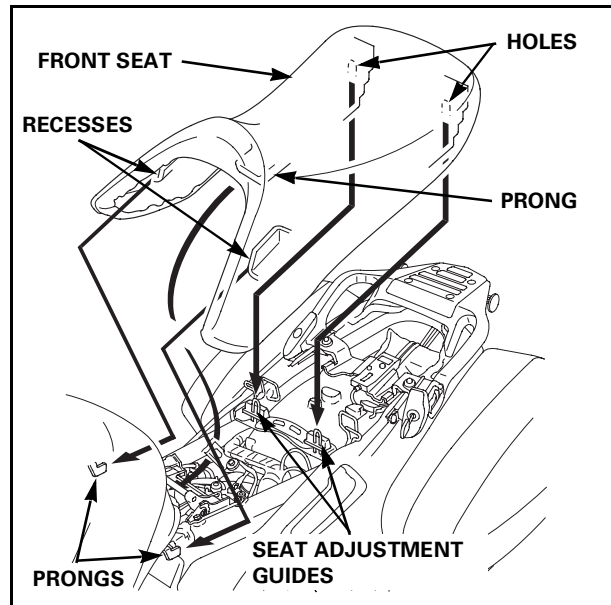

18. Check the coolant level.

Check the coolant level at the coolant reserve tank. If the level is low, remove the coolant reserve tank cap and add Pro Honda coolant or an equivalent 1:1 mixture of antifreeze and distilled water to restore the level to the UPPER level mark. Do not spill coolant on painted or plastic surfaces as it can damage the finish.

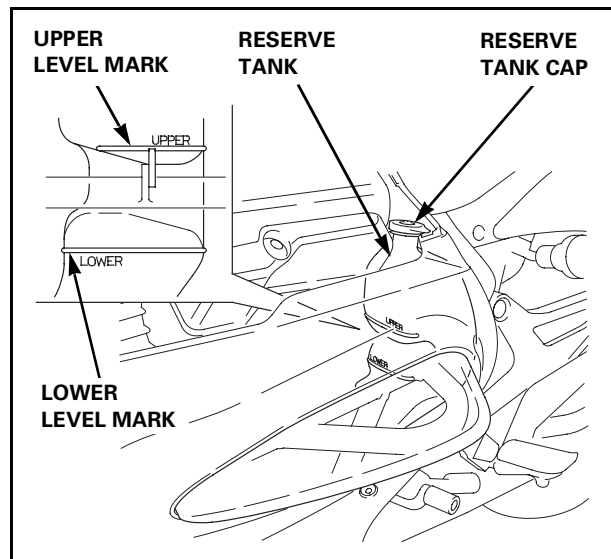

19. Verify the throttle free play.

Operate the throttle to confirm that it moves smoothly and returns automatically from any open position to the fully closed position in all steering positions.

Confirm the throttle grip free play:

Throttle free play:

2 - 6 mm (1/16 - 3/16 in)

Make adjustments at the throttle grip adjuster by loosening the lock nut and turning the adjuster. Tighten the lock nut after adjustment.

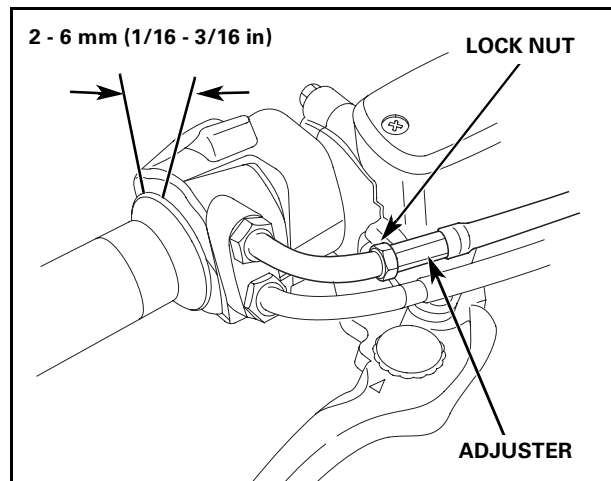



20. Check the oil level.

Before starting the engine, remove the anti-rust coating from the engine and exhaust system using a mild detergent and water. Rinse with clean water.

Support the motorcycle in an upright position on a firm, level surface.

Check that the oil level is between the upper and lower level marks in the inspection window.

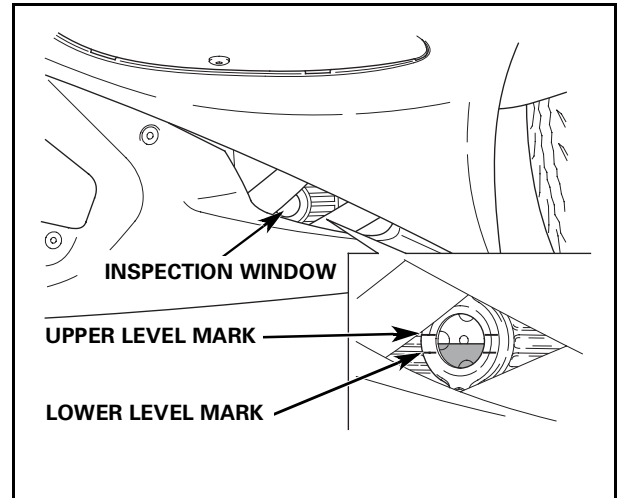

If the oil level is below the lower level mark, remove the right cylinder head over-head cover and oil filler cap, and add the recommended oil until the level is between the upper and lower level marks. Replace the oil filler cap.

Start the engine and let it idle for 3 - 5 minutes. Make sure the low oil pressure indicator goes off. If the indicator remains on, stop the engine and troubleshoot the cause.

Stop the engine and wait 2 - 3 minutes.

Check the oil level using the above procedure and, if necessary, add the recommended oil until it reaches the upper level mark.

Do not add oil above the upper level mark.

- **Oil recommendation: Pro Honda GN4 or HP4 (without molybdenum additives) 4-stroke oil or equivalent.**
- **Viscosity: SAE 10W-40**
- **Classification: SG or higher. Do not use oils labeled as energy conserving on the circular API service label**
- **JASO T 903 standard: MA**
- **Crankcase capacity (after draining): 3.6 Liters (3.8 US Quarts)**

Reinstall the oil filler cap and right cylinder head over-head cover.

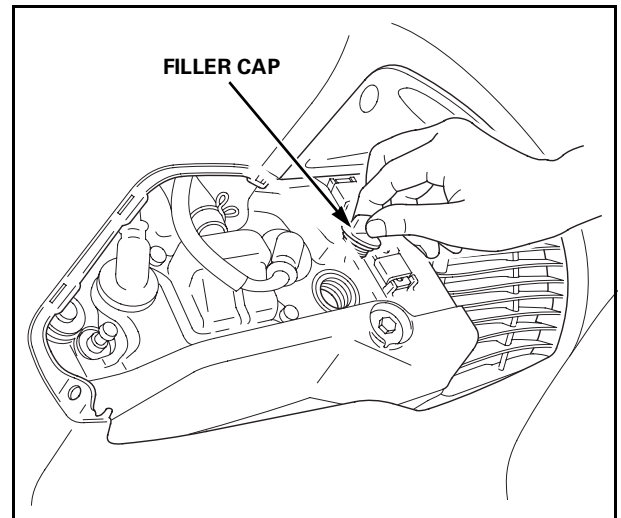

21. Check the final drive oil level.

Place the motorcycle on its centerstand on a firm, level surface.

Remove the oil filler cap.

Check the oil level, it should be flush with the lower edge of the oil filler hole. If the level is low, check for oil leaks. Add the recommended oil through the oil filler hole until it reaches the lower edge of the opening.

Recommended oil: Pro Honda Shaft Drive Oil or equivalent SAE 80 hypoid gear oil.

Reinstall the oil filler cap.

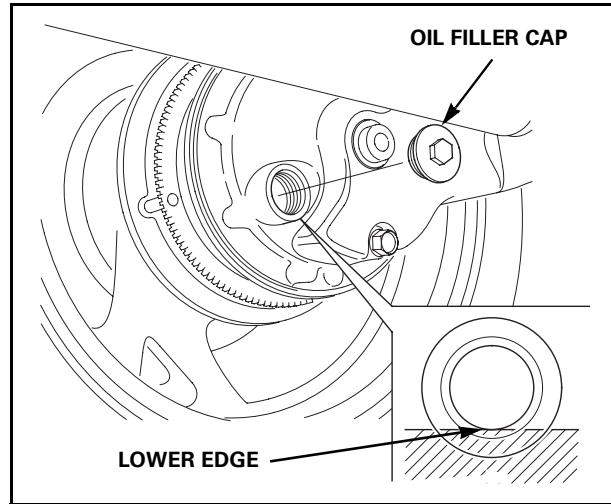

22. Check the front and rear brake reservoir fluid levels.

Turn the handlebar so that the front brake reservoir is level and check the fluid level.

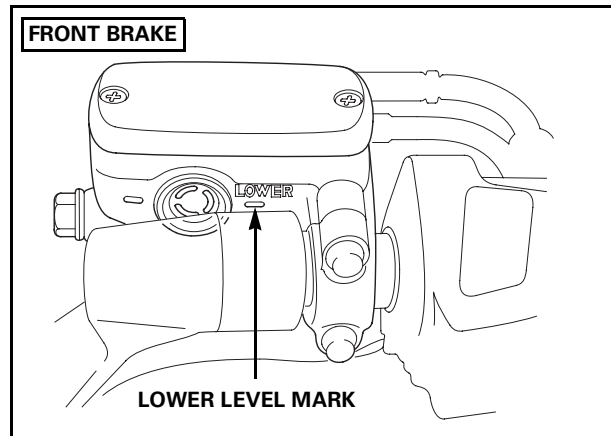

Support the motorcycle in an upright position on a firm, level surface and check the rear brake fluid level.

If the fluid level is low in either reservoir, remove the screws, reservoir cover, and diaphragm or cap.

Add Pro Honda DOT 4 brake fluid or equivalent from a sealed container to bring the level up to the upper level mark.

Reinstall the cap or the diaphragm, cover, and screws.

Operate the hand lever and foot pedal. If the free play is excessive or the brake feels spongy and the reservoir fluid level is correct, bleed the system.

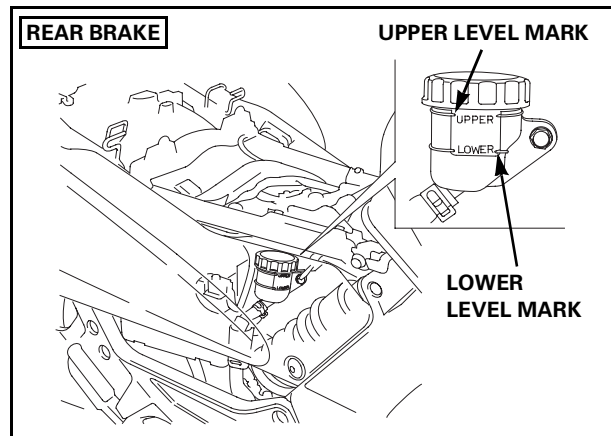



23. Check the idle speed.

Start the engine and warm it up to its normal operating temperature.

Place the motorcycle on its centerstand on a firm, level surface.

Connect a tachometer to the engine according to the manufacturer's instructions.

Verify the idle speed (rpm).

Idle speed: 1,000 ± 100 rpm

If an adjustment is needed, turn the throttle stop screw to set the idle speed using a screwdriver.

Stop the engine and remove the tachometer.

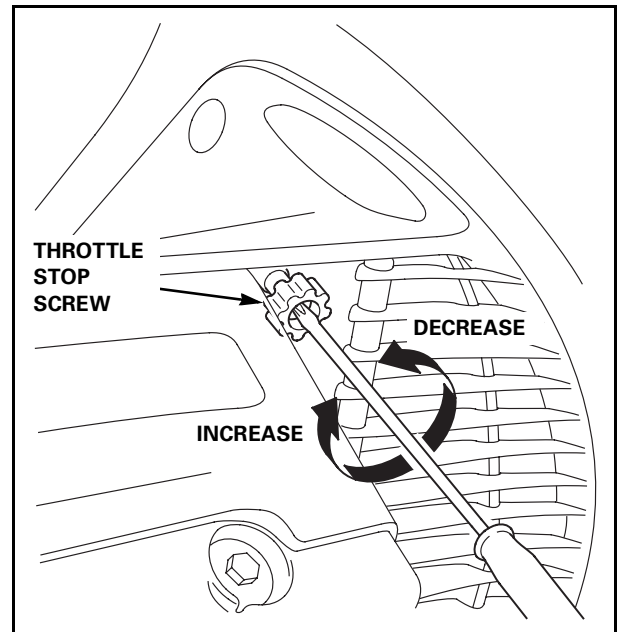

24. Check the tire pressure.

Front and rear: 42 psi.

2005 ST1300/A

25. Adjust the front seat height.

The front seat height of the ST1300/A can be adjusted for rider preference.

Remove the rear seat by referring to the instructions in step 11 on page 10.

Remove the front seat by following the instructions in step 17 on page 14.

Move the seat height adjuster into one of the three positions on the guide as shown.

Be sure to align the holes in the rear of the front seat with the adjuster when installing the seat.

Reinstall the front seat by referring to the instructions in step 17 on page 16.

Reinstall the rear seat by following the instructions in step 13 on page 11.

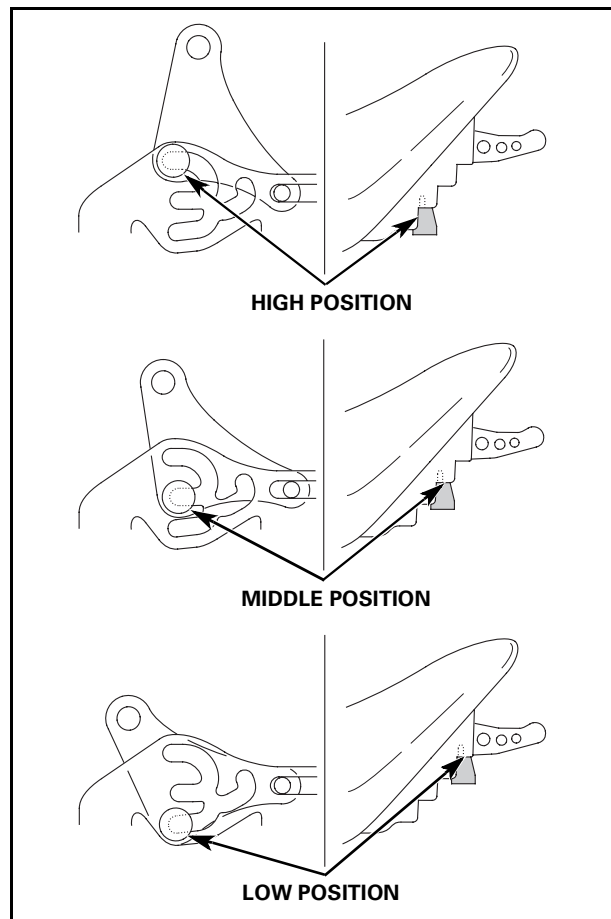
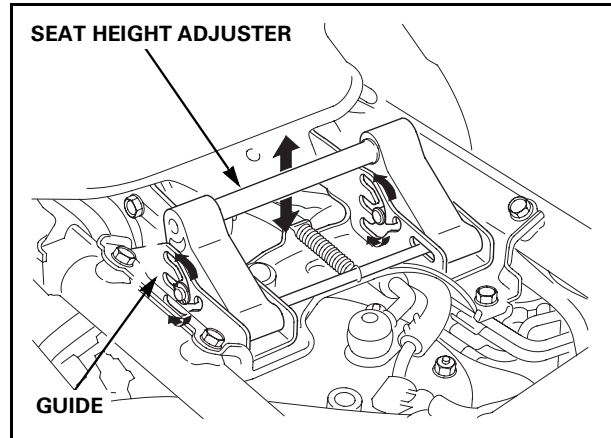

26. Complete the Set-Up/Pre-Delivery Checklist.

Complete an *On-Road Motorcycle Set-up/Pre-delivery Checklist* (Reorder No. S0299) by checking the boxes confirming that the steps were done.



Wiring Diagram - ST1300

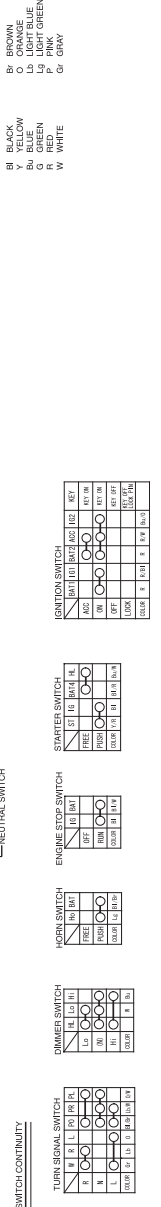
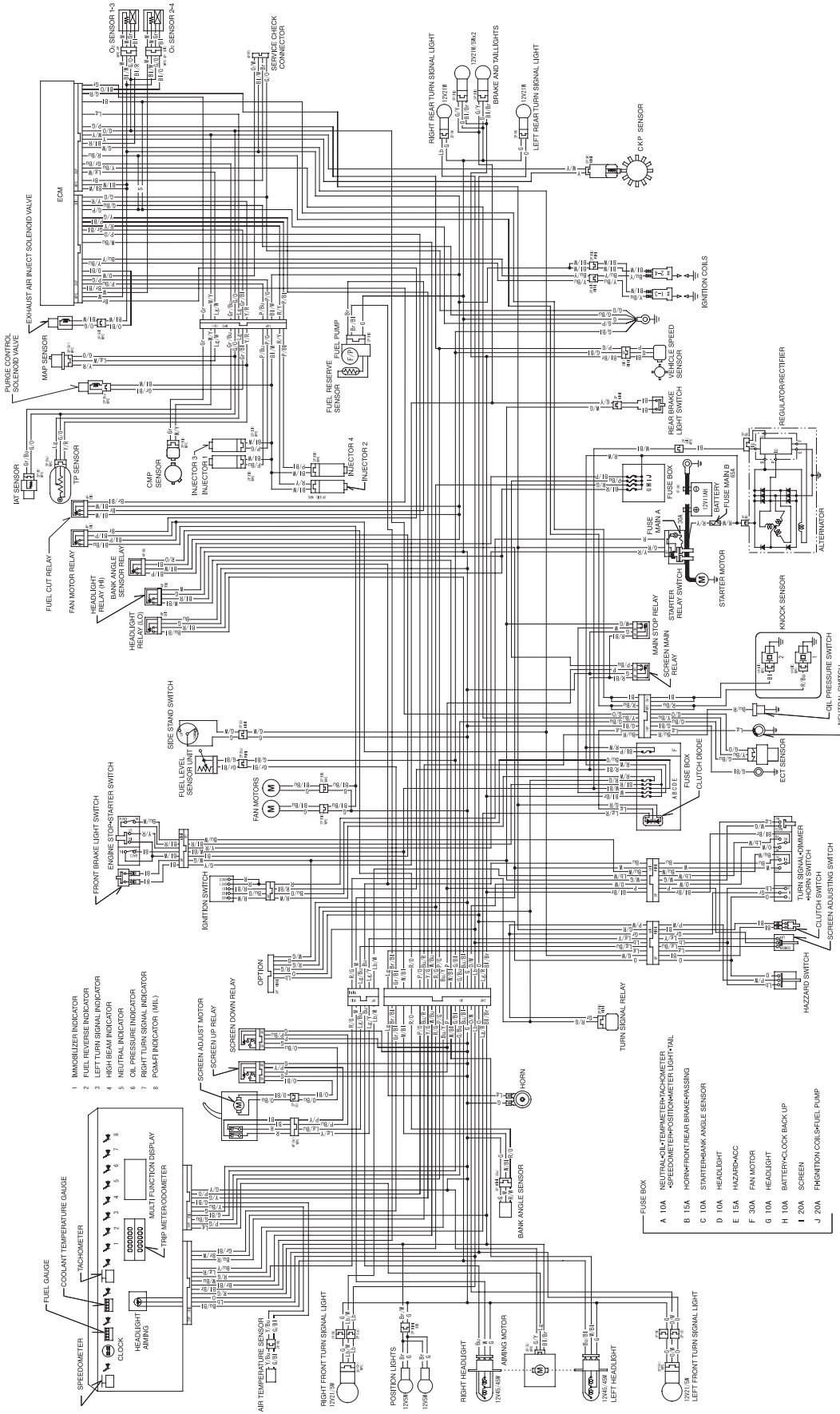

2005 ST1300/A

Wiring Diagram - ST1300A

