



**2003 ST1300 / ST1300A
SET-UP
INSTRUCTIONS**



**Set-up and pre-delivery service
must be performed by an authorized
Honda motorcycle dealer.**

IMPORTANCE OF PROPER SET-UP AND PRE-DELIVERY SERVICE

- **FOR YOUR CUSTOMER'S SAFETY**

Proper set-up and pre-delivery service are essential to rider safety and the reliability of the machine. Any error or oversight made by the technician assembling and servicing a new machine can result in faulty operation, damage to the machine, or injury to the rider.

WARNING

Improper set-up or pre-delivery service can create an unsafe condition that can cause your customer to be seriously hurt or killed.

Follow the procedures and precautions in this manual and the service manual carefully.

- **FOR YOUR SAFETY**

Some of the most important safety precautions are given below. However, we cannot warn you of every conceivable hazard that can arise in performing set-up and pre-delivery service. Only you can decide whether or not you should perform a given task.

WARNING

Failure to properly follow instructions and precautions can cause you to be seriously hurt or killed.

Follow the procedures and precautions in this manual carefully.

- **IMPORTANT SAFETY PRECAUTIONS**

Make sure you have a clear understanding of all basic shop safety practices and that you are wearing appropriate clothing and safety equipment. When performing the set-up or pre-delivery service, be especially careful of the following:

- Read the instructions before you begin, and make sure you have the tools and skills required to perform the tasks safely.
- To prevent the machine from falling on you, park it on a firm, level surface, using the proper stand(s) to provide firm support.

Make sure the engine is off before you begin any servicing procedures. This will help eliminate several potential hazards:

- Carbon monoxide poisoning from engine exhaust; be sure there is adequate ventilation whenever you run the engine.
- Burns from hot parts; let the engine and exhaust system cool before touching.
- Injury from moving parts; do not run the engine unless the instruction tells you to do so. Even then, keep your hands, fingers, and clothing away.

To reduce the possibility of a fire or explosion, be careful when working around gasoline or batteries. Use only a nonflammable solvent, not gasoline, to clean parts. Keep all cigarettes, sparks and flames away from the battery and all fuel-related parts.

2003 ST1300 / ST1300A

How To Use This Manual

Follow the complete sequence of steps as shown. Do not short-cut any steps. The sequence has been established to ensure the unit is properly assembled.

The individual steps are composed of three components; the sub-heading, the descriptive text, and the photograph or line art:

- The large sub-headings are a brief description of the step. They are intended to be used by the experienced technician; one who only needs a brief reminder of the set-up sequence.
- The descriptive text explains in detail what is to be done during that step. This explanation is intended as a guide for the technician needing additional information.
- The photographs or line art support both the sub-headings and the detailed text.



Indicates the Set-up section



Indicates the Pre-delivery section

Modifications and Accessories

Modifications which you may have made, or should make in the future, to any Honda product, shall be deemed by our company to have been performed at your sole risk and responsibility, and without our company's or the manufacturer's approval, or consent, implied or expressed. We further disclaim any and all liability, obligation, or responsibility for any defects of modified parts or of the modified product, and for any claims, demands, or causes of action for damage to property or for personal injuries resulting from the modification of said Honda product.

Revised Pages

<u>PAGE</u>	<u>REVISED</u>
Cover	January 2003
ii	January 2003
1	October 2002
2	October 2002
3	October 2002
6	January 2003
17	October 2002

Torque Table

<u>ITEM</u>	<u>SIZE</u>	<u>TORQUE</u>
Front fender bolt	6 mm	9 ft-lbs (1.2 kg-m, 12 N·m)
Hose stay bolt	6 mm	9 ft-lbs (1.2 kg-m, 12 N·m)
Front axle bolt	6 mm	58 ft-lbs (8.0 kg-m, 78 N·m)
Pinch bolt	8 mm	16 ft-lbs (2.2 kg-m, 22 N·m)
Caliper bolt	8 mm	23 ft-lbs (3.2 kg-m, 31 N·m)
Mirror bolts	6 mm	9 ft-lbs (1.2 kg-m, 12 N·m)



COVERED CRATE

1. Remove the carton cover

2003 ST1300/ST1300As are crated in one of two ways. You may receive either one.

Covered crate:

Cut the strap and remove the carton cover. Remove the inner cardboard frame cover.

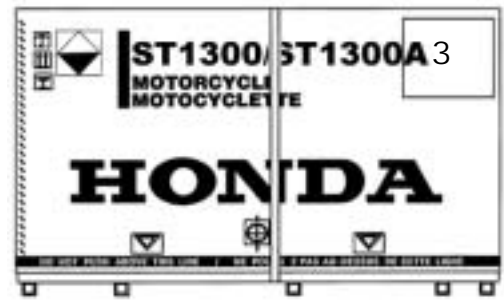

UNCOVERED CRATE

Uncovered crate:

When stacking crates, protect the motorcycle from falling objects and bad weather.

2. Check for damage.

Check the unit for hidden damage.

If you find damage, follow the instructions on the "Delivery and Damage Claims Guidelines" wall chart (Reorder No. S0477) before proceeding.

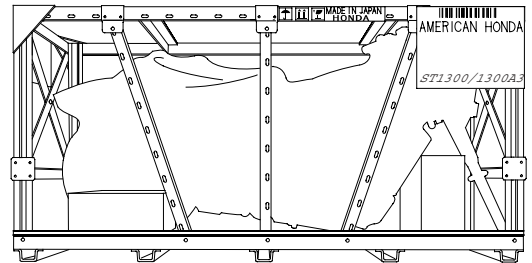

3. Remove the side braces, wheel, loose parts carton and crate frame.

Remove the ties securing the front wheel and loose parts cartons.

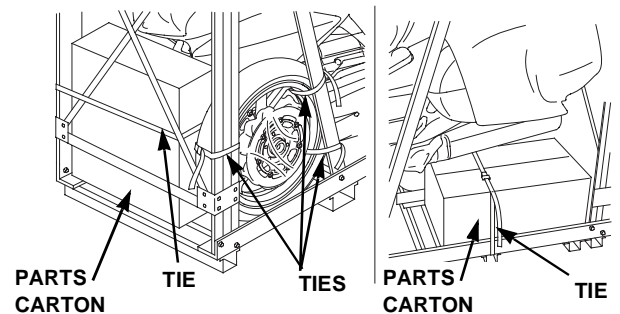

Remove the bolts and side braces, being careful not to damage the front wheel.

Remove the loose parts cartons.

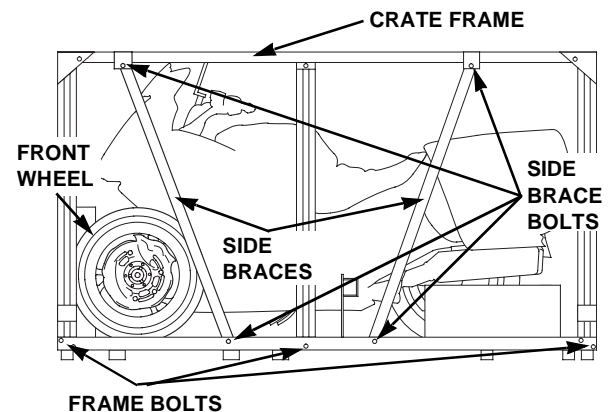

Remove the nuts, plate, and bolts.

Using two people, carefully remove the crate frame; the metal frame can damage the motorcycle.

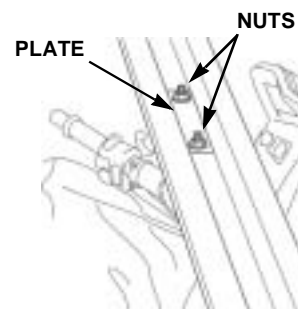

NEW

2003 ST1300 / ST1300A

4. Loose Parts Information.

Unpack the remaining loose parts and check them against this illustration. Report any damaged or missing parts immediately to American Honda by calling (800) 421-1900, ext. 1.

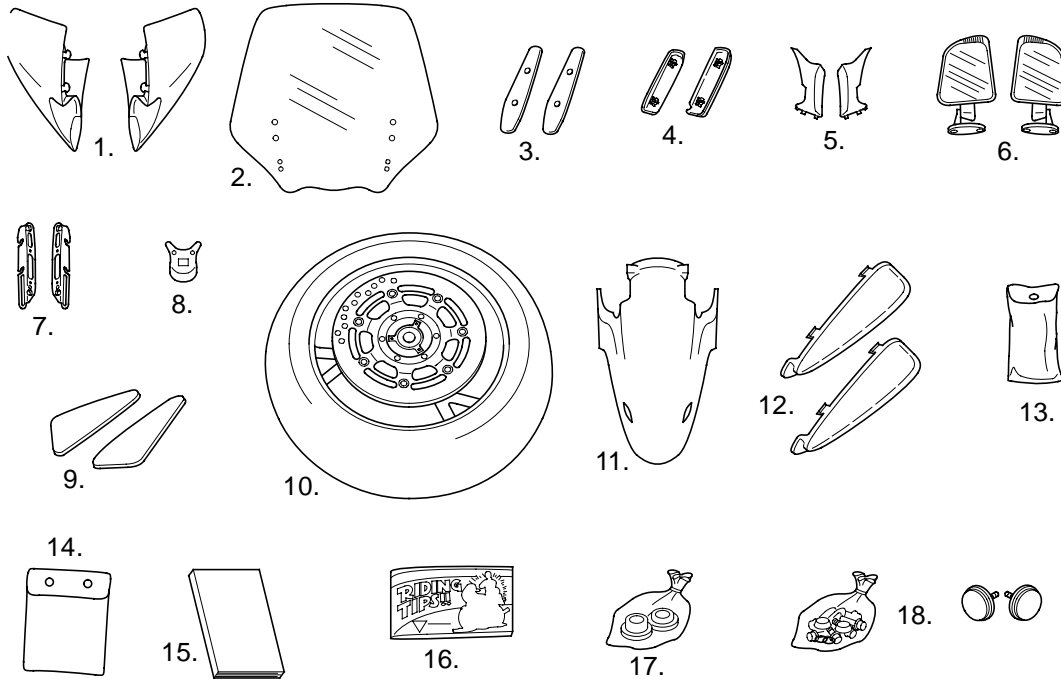

NO.	DESCRIPTION	QTY	PART NUMBER	USE
1.	Cover, R, mirror Cover, L, mirror	1 1	88111-MCS-G0ZB 88121-MCS-G0ZB	Step 9
2.	Windshield	1	64150-MCS-G00	Step 8
3.	Cover, windshield	2	64151-MCS-G00	Step 8
4.	Cover, R, windshield bracket Cover, L, windshield bracket	1 1	64183-MCS-G00 64188-MCS-G00	Step 8
5.	Rubber, R, mirror cover Rubber, L, mirror cover	1 1	88112-MCS-G00 88122-MCS-G00	Step 9
6.	Rear view mirror, R Rear view mirror, L	1 1	88110-MCS-G01 88120-MCS-G01	Step 9
7.	Bracket, R, windshield Bracket, L, windshield	1 1	64172-MCS-G00 64177-MCS0G00	Step 8
8.	Cover, handlebar	1	53115-MCS-G2A	Step 10
9.	Pad, R, knee grip**** Pad, L, Knee grip****	1 1	17506-MCS-G00 17507-MCS-G00	Step 26
10.	Front wheel assembly	1	-----	Step 7
11.	Front fender	1	61100-MCS-G2B	Step 6
12.	Cover, R, engine guard Cover, L, engine guard	1 1	64260-MCS-G00 64265-MCS-G00	Step 18
13.	Tool kit	1	89010-MCS-G00	Step 15
14.	Owner's Manual bag	1	83642-MN5-000	Step 15
15.	Owner's Manual	1	31MCS600*	Step 15
16.	Riding Tips & Practice Guide***	1	G0045**	-----



NEW

NO.	DESCRIPTION	QTY	PART NUMBER	USE
17.	Collar, R, FR, wheel side Collar, L, FR, wheel side	1 1	44311-MCS-G00 44312-MCS-G00	Step 7
18.	Attaching hardware: Cover, handlebar Special screw – 4 x 6.5 mm	2	90136-MCS-G00	Step 10
	Front fender Washer, rubber Screw, pan – 6 x 20 mm Bolt, socket – 6 x 18 mm Bolt, flange – 6 x 16 mm	2 2 2 2	18325-MBV-000 90138-MCS-G00 96600-06018-00 96001-06016-07	Step 6
	Windshield Plastic retainer Collar, side cover Bolt, flange – 6 x 18 mm Screw, pan – 4 x 25 mm Rubber, adj. screen	4 4 4 4 2	64509-MK4-000 61104-435-000 96001-06018-07 90126-MCS-G00 64175-MCS-G00	Step 8
	Windshield cover Nut, flange – 6 mm	4	94050-06070	Step 8
	Rear view mirror Bolt, flange – 6 x 20 mm	4	96001-06020-00	Step 9
	Fairing protector Screw, pan – 6 x 11 mm	2	90106-KY2-701	Step 18
	Rear view mirror cover Clip B 10, tube	4	95002-02100	Step 9
	Reflectors Reflector, front Stay, front reflector Nut, flange – 6 mm	2 2 2	33741-413-013 33742-MCS-L00 94050-06000	Step 6

* If missing, order from Helm Inc.

** If missing, order from Dyment Distribution Services.

*** Hand the Riding Tips & Practice Guide to the customer at the time of delivery.

**** Optional parts. Hand the knee pads to the customer at the time of delivery or install if the customer wants (see step 26).

Damaged or Missing Parts

Identify the missing parts by referring to the “Loose Parts Information.” Order the parts using normal parts ordering procedures.

For parts lost, damaged in transit or left out by the factory, submit a M/C Warranty/Transportation Claim Form via DCS.

2003 ST1300 / ST1300A

5. Remove the motorcycle from the crate base.

Install lifting slings on the engine guards and grab rail as shown.

Use a spreader board, if necessary, to prevent the slings from damaging the motorcycle.

Lift the slings just enough to remove the slack.

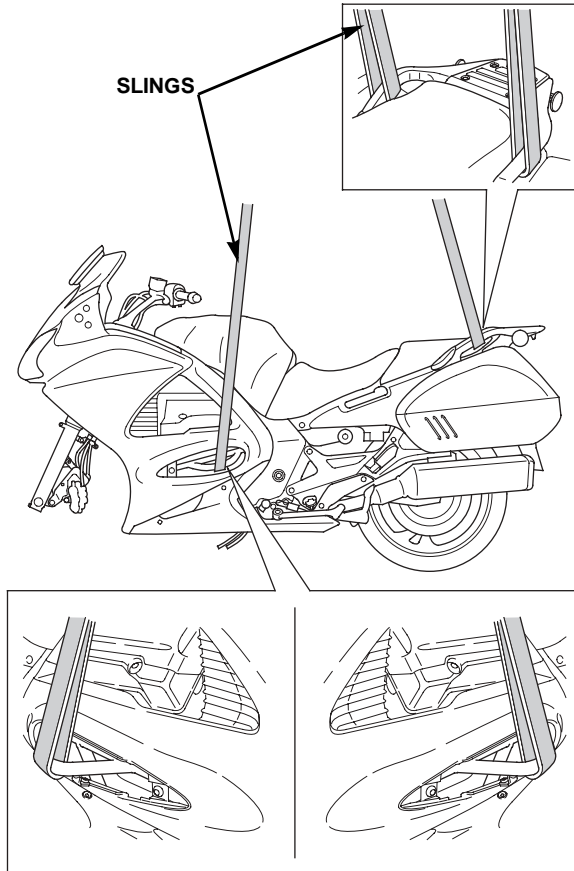

Remove the shipping bolts and washers from the forks; discard the bolts and washers.

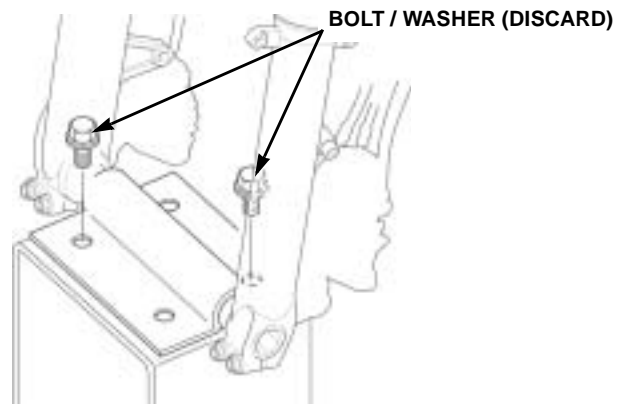

Remove the shipping braces, nuts, and protective covering from the foot pegs (both sides).

Lift the motorcycle free from the crate base and remove the base.

On a firm, level surface, lower the centerstand and lower the motorcycle until it is resting on its rear wheel and centerstand.

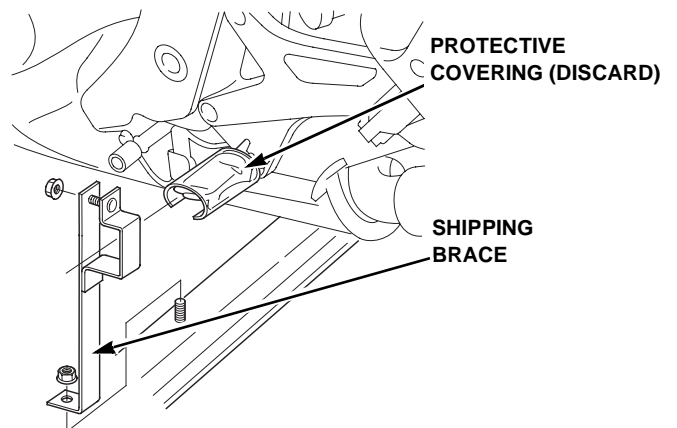



6. Install the front fender.

CAUTION: Be extremely careful when loosening the pinch bolts and removing the axle shaft as the motorcycle will lose stability and can cause damage or fall on you.

Loosen the two right axle pinch bolts.

Remove the axle bolt.

Loosen the two left axle pinch bolts.

Remove the axle protective covering and axle shaft.

Position the reflector stays on the inside of the front fender by aligning them with the projections on the front fender. Install the reflector stays with two 6 x 20 mm pan head screws and rubber washers. Secure the reflectors to the stays with two 6 mm nuts.

Position the front fender between the fork legs and attach it to the fork stays with two 6 x 18 mm socket bolts. Secure the brake hose stays with two 6 x 16 mm flange bolts.

Torque the bolts.

Torque: 9 ft-lbs (1.2 kg-m, 12 N·m)

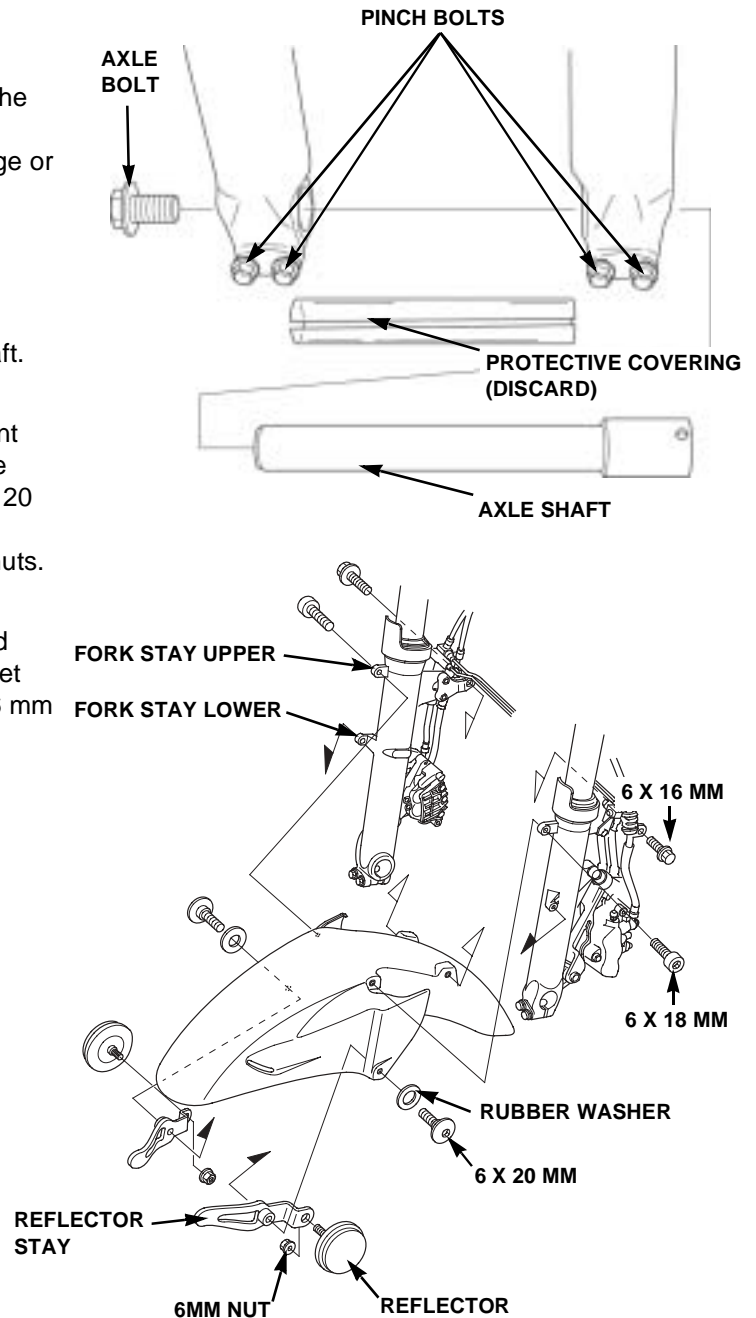

2003 ST1300 / ST1300A

7. Install the front wheel.

Clean both sides of the front brake discs with a clean shop towel and Pro Honda Brake Cleaner or equivalent.

Remove the caliper mounting bolts. Be careful not to allow dust and dirt to adhere to the ends of the mounting bolts.

Note that the 8 x 45 mm caliper bolt is attached to the lower left fork leg.

Note that the shoulders on each collar are of different sizes. It is important to install them with the correct sides facing the wheel.

Install the 16.5 mm left-side collar with the 10 mm deep shoulder side facing the wheel.

Install the 27.5 mm right-side collar with the 34 mm outside diameter shoulder facing the wheel.

Position the front wheel between the fork legs.

Slide the axle shaft through the left fork leg, the 16.5 mm left-side collar, front wheel, 27.5 mm right-side collar, and right fork leg.

Push in on the axle shaft so the left end of the axle shaft is flush with the surface of the left fork leg.

Install and tighten the axle bolt to the specified torque.

Torque: 58 ft-lbs (8.0 kg-m, 78 N·m)

Tighten the left, then the right axle pinch bolts to the specified torque.

Torque: 16 ft-lbs (2.2 kg-m, 22 N·m)

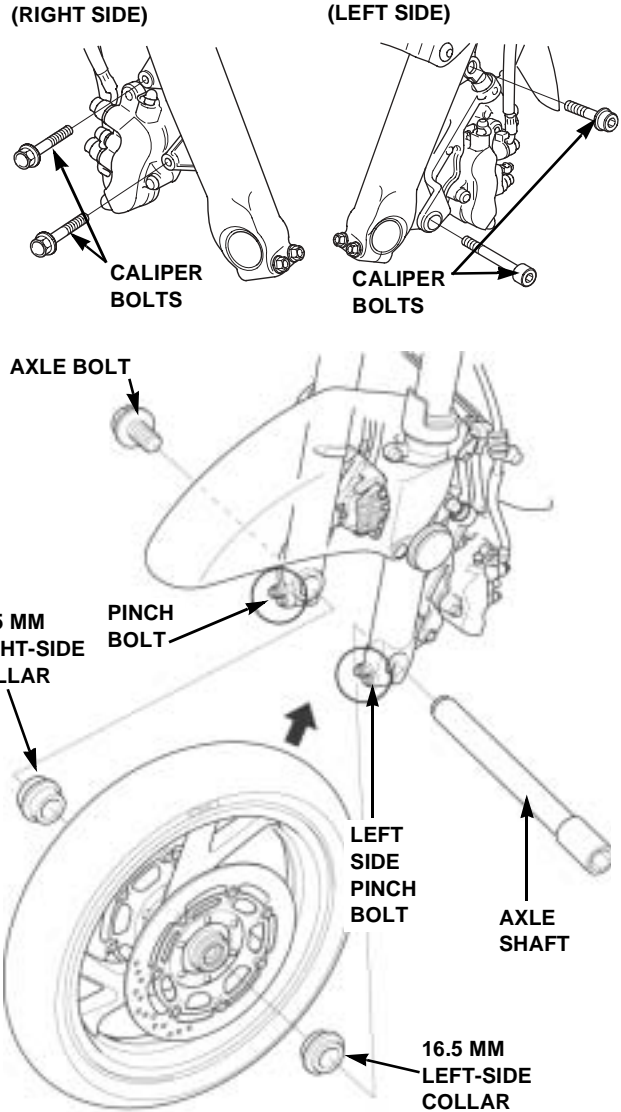

On ST1300A, verify the clearance is as shown.

Reinstall the caliper bolts and tighten to the specified torque.

Torque: 23 ft-lbs (3.2 kg-m, 31 N·m)

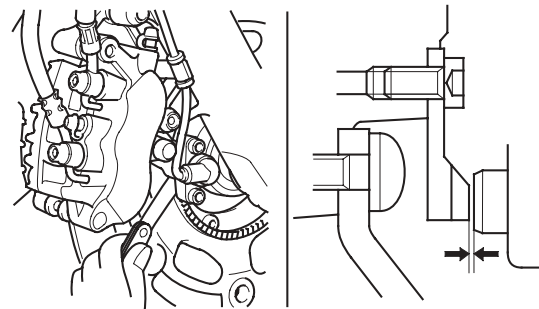

0.4 - 1.2 MM
(0.02 - 0.05 in)



8. Install the windshield.

Note:

- On the ST1300, install the windshield adjusters according to rider preference.
- On the ST1300A, the windshield adjusters are installed as shown, they can be reinstalled according to rider preference.

Install the windshield adjusters (ST1300 Only) and secure with 6 mm nuts.

Using two people, carefully install the following parts in this order:

- Adjuster rubbers
- Windshield
- Plastic washers
- Collars
- 6 x 18 mm flange bolts

Tighten the bolts securely.

Then, install the:

- Rear covers (ST1300 Only)
- Covers (Wide side facing down)
- 4 x 25 mm screw bolts

Tighten the screw bolts securely.

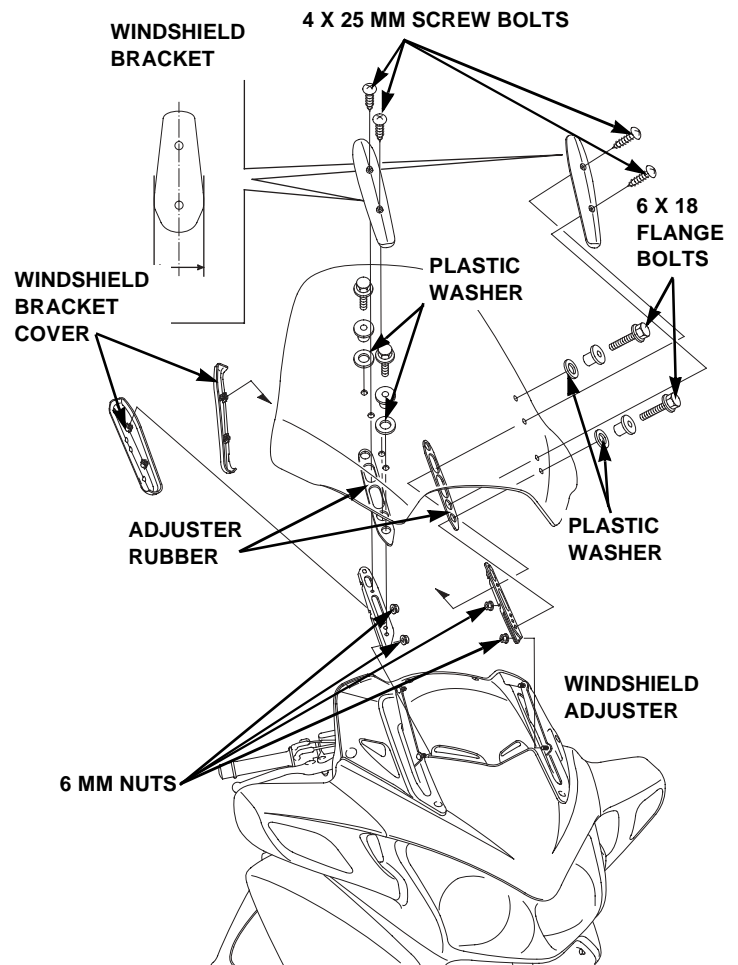
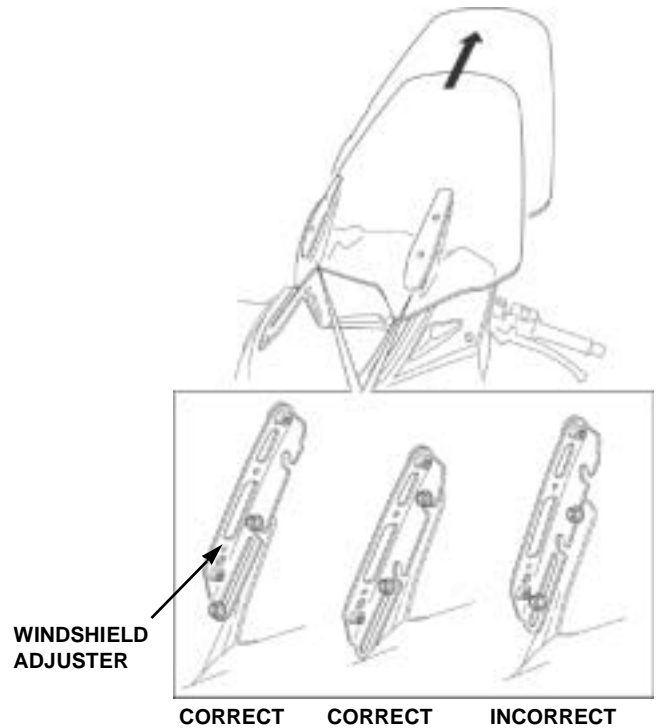

2003 ST1300 / ST1300A

9. Install the mirrors.

Remove the shipping bolts and discard. Install the right and left rear view mirrors using two 6 x 20 mm flange bolts on each side.

Tighten the bolts to the specified torque.

Torque: 9 ft-lbs (1.2 kg-m, 12 N·m)

Install the two hose clips.

Connect the harness terminals as shown, then push the end of the suspension band into the hole in the body.

Install the mirror rubber cover, then install the mirror cover.

Check that the mirror rubber cover and mirror cover are installed securely.

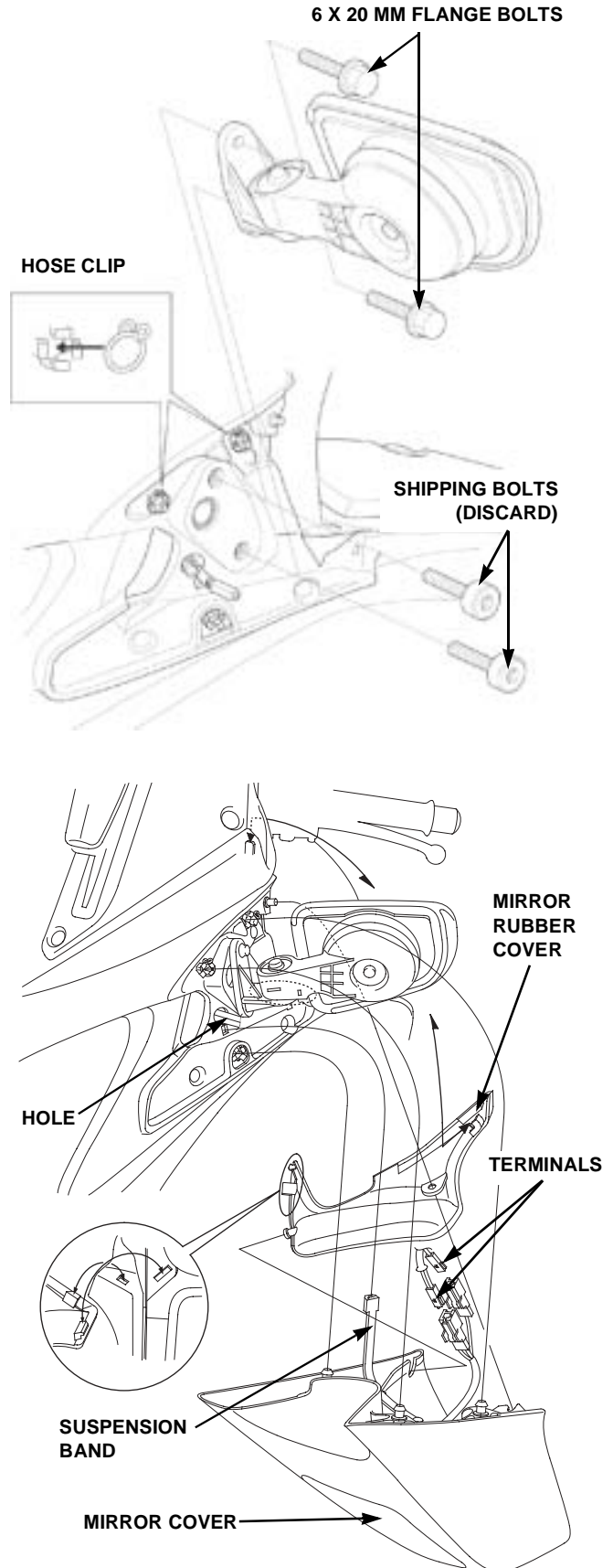



10. Install the handlebar cover and saddlebag lever lock.

Remove the ignition switch key from the key cylinder.
Attach the handlebar cover using two 4 x 6.5 mm special screws.
Open the left fairing pocket with the ignition key.

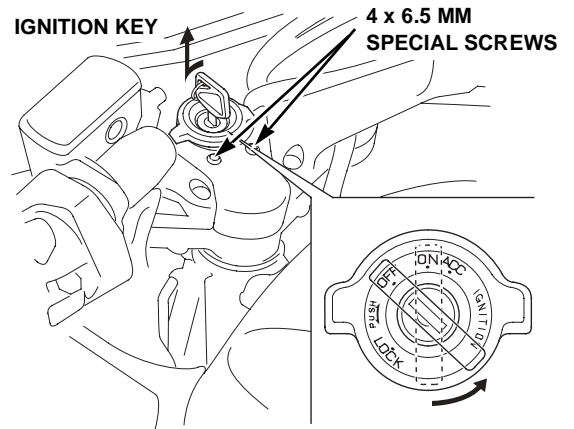

Take out the saddlebag lever locks from the left fairing pocket.

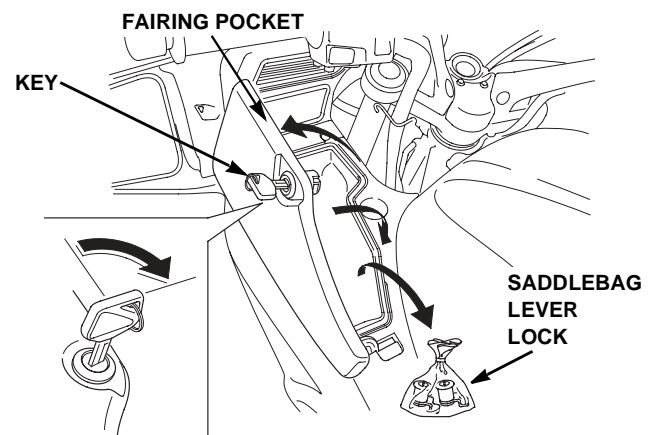

Insert the ignition switch key into the saddlebag lever lock and turn it clockwise to the position shown.

Push in on the saddlebag lever lock while aligning it with the cutout in the saddlebag as shown.

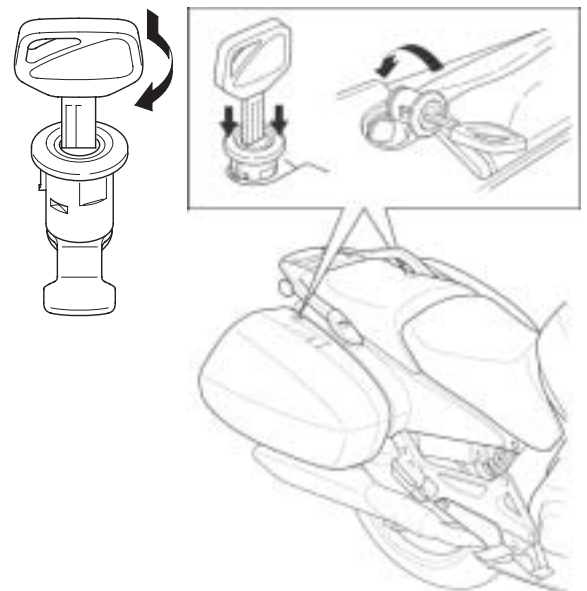

2003 ST1300 / ST1300A

11. Remove the seat.

Insert the ignition key and turn it clockwise to open the latch lever.

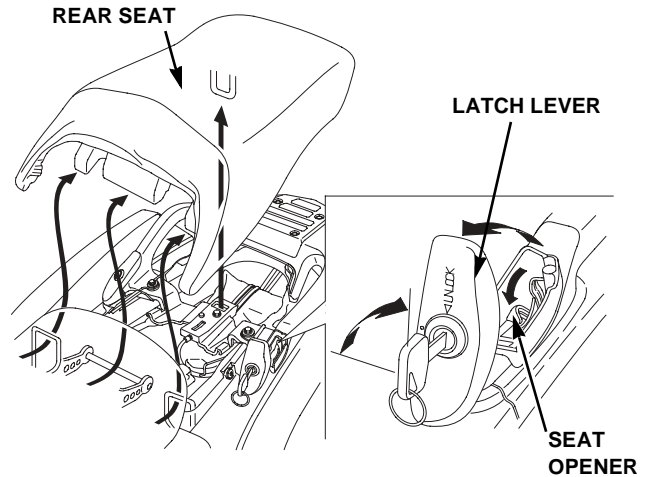

Pull the rear seat back and up while depressing the seat opener.

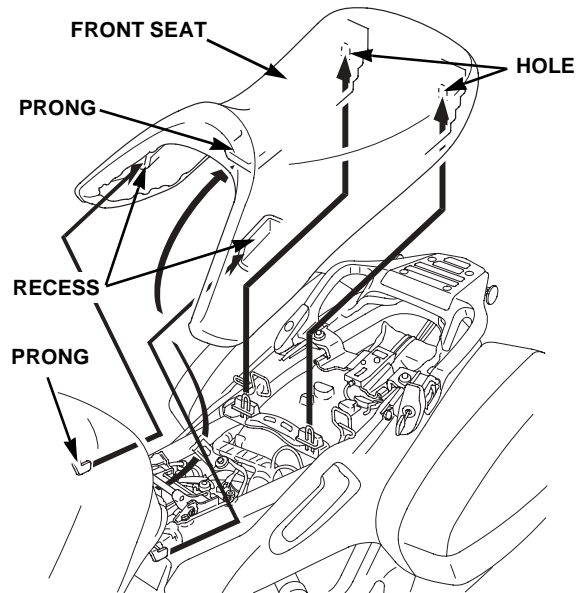

12. Remove the saddlebag.

Insert the ignition key and turn it clockwise to open the latch lever.

Remove the right side saddlebag by lifting up and pulling it out.

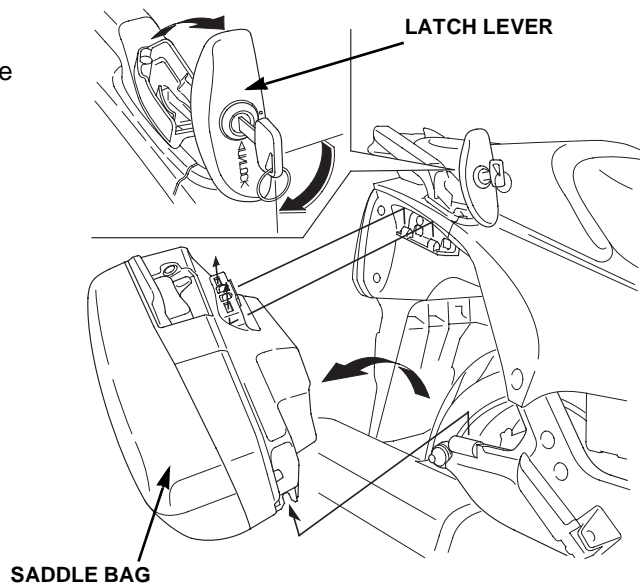



13. Remove the side cover.

Remove the bolts and side cover.

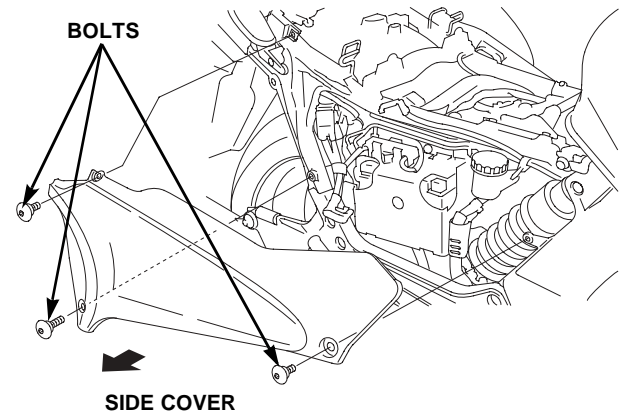

14. Service the battery.

Service the battery only if the unit is sold or will be used as a demonstrator.

The battery in this motorcycle is a pre-charged, maintenance-free type. The electrolyte has been factory installed in the battery.

Follow the instructions included in *Service Letter #48*.

Remove the battery cover.

Remove the battery holder by removing the bolt.

Pull the battery out of the battery box.

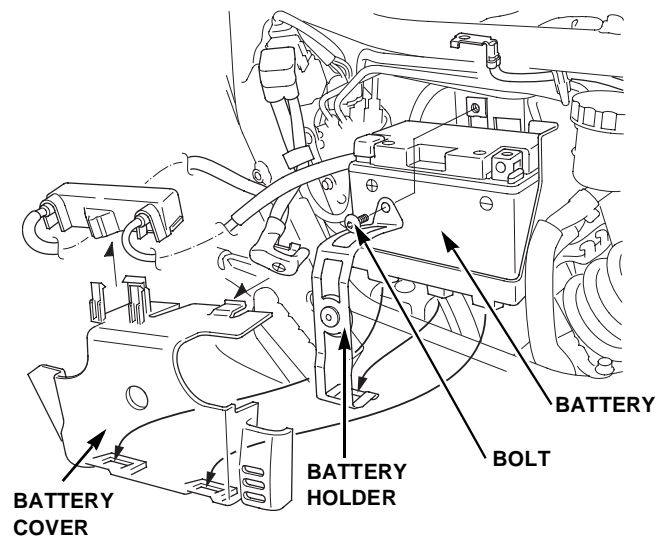

Turn the ignition key to the "OFF" position.

Set the battery into the battery box.

Connect the positive (+) battery cable to the positive battery terminal. Then connect the negative (-) battery cable to the negative battery terminal using the special bolts and nuts.

Tighten the bolts securely.

Coat both terminals with clean Dielectric grease and pull the red cover over the positive terminal.

Allowing the positive (+) terminal to rest on any metal parts could wear through the insulation and cause a short circuit. Do not allow the positive (+) cable to contact any metal parts.

Reinstall the side cover and saddlebag in the reverse order of removal.

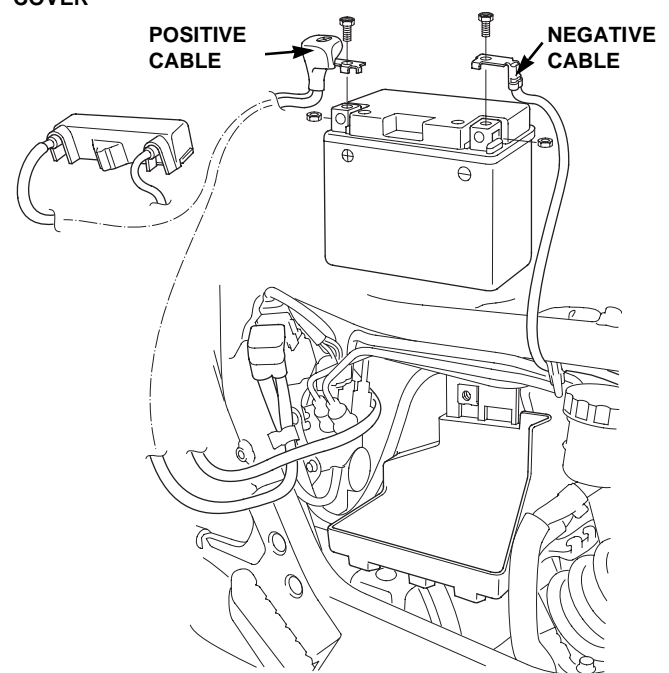

2003 ST1300 / ST1300A

15. Store the tool kit and Owner's Manual

Place the tool kit under the rear seat and secure with the tool band.

Place the Owner's Manual into its bag and place on top of the tool kit.

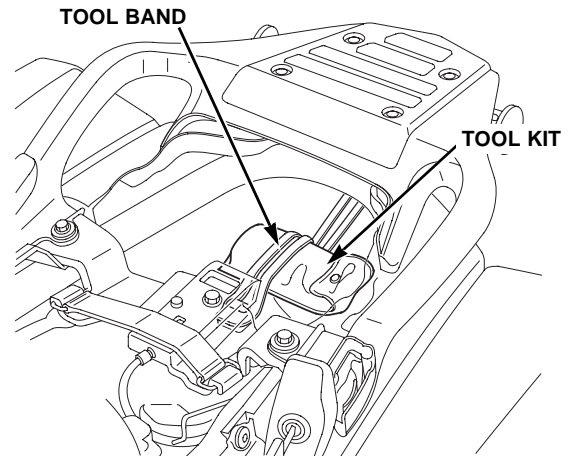

16. Adjust the seat height

Slide the seat height adjuster toward the rear, then seat it in the guide.

Be sure to align the hole in the rear of the front seat with the adjuster when installing.

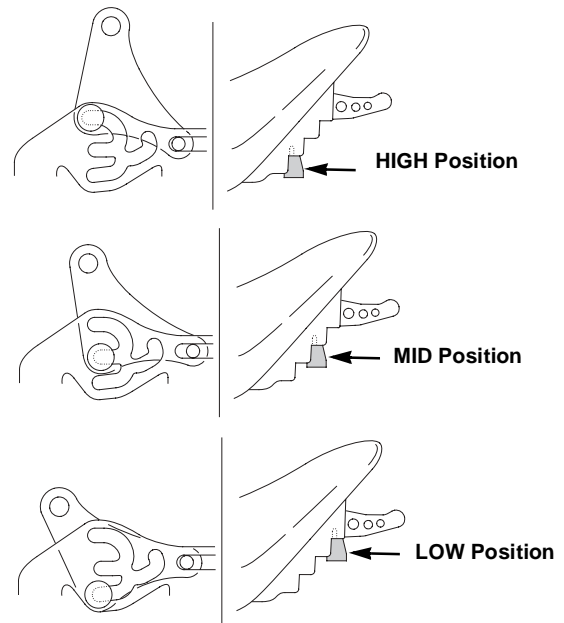
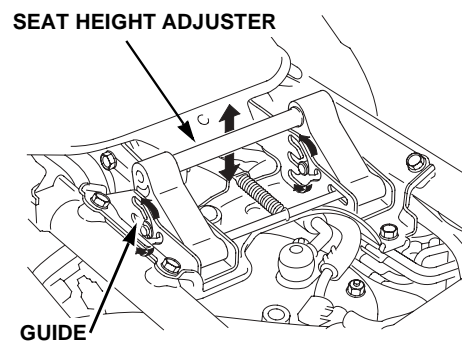



17. Install the seat.

Insert the prong into the recess under the frame cross member, then push down on the rear of the front seat.

Insert the prong into the recess under the frame cross member, then push down on the rear of the rear seat.

Close the latch lever and turn the ignition key counterclockwise.

Be sure the seats are locked securely in position.

Replace the ignition key.

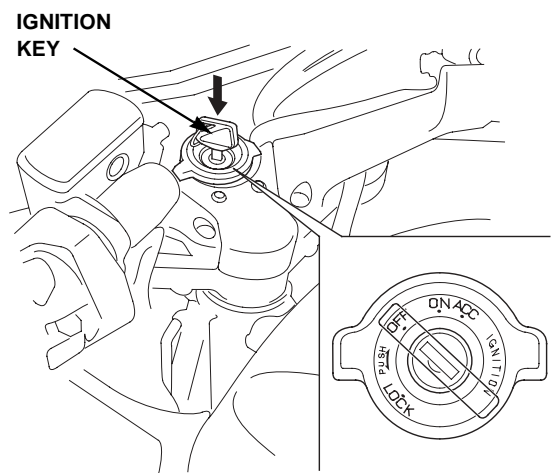
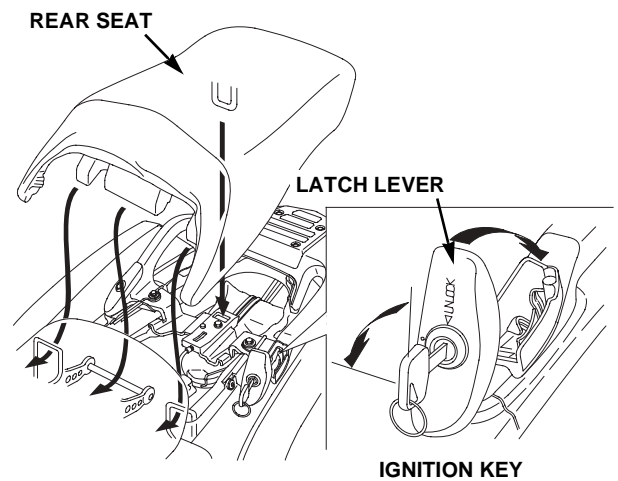
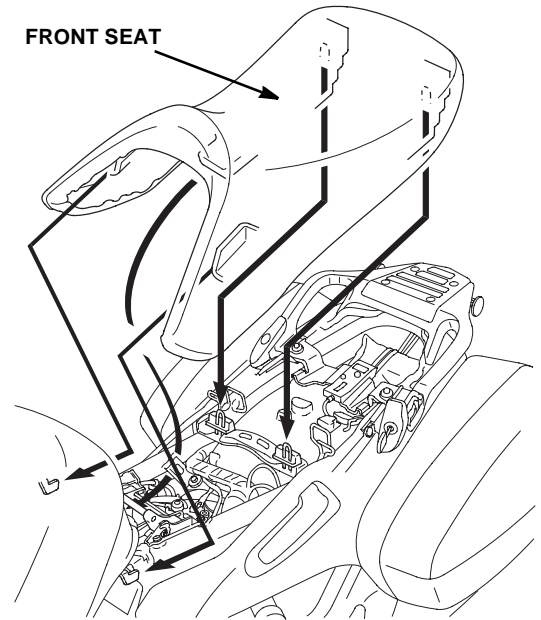

2003 ST1300 / ST1300A

18. Install the engine guards.

Install the engine guard covers and secure them with a 6 x 11 mm pan head screw (both sides).

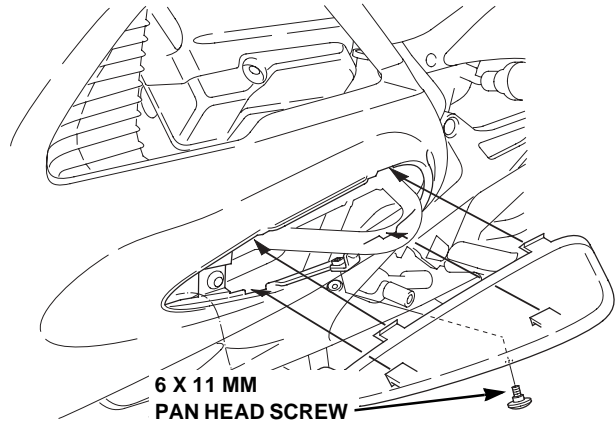

19. Check the oil level.

Park the motorcycle on its center stand on a firm, level surface.

Check that the oil level is between the upper and lower level marks in the inspection window. If the oil level is below the lower level mark, remove the oil filler cap and add the recommended oil until the level is between the upper and lower level marks. Replace the oil filler cap.

Start the engine and let it idle for 3 – 5 minutes. Make sure the low oil pressure indicator goes off. If the indicator remains on, stop the engine immediately.

Stop the engine and wait 2 – 3 minutes.

Check the oil level using the above procedure and if necessary, add the recommended oil until it reaches the upper level mark.

Oil recommendation: Pro Honda GN4 or HP4 (without molybdenum additives) 4-stroke oil or equivalent.

Viscosity - SAE 10W-40

Classification - SG or higher except oils labeled as energy conserving on the circular API service label

Crankcase capacity (after draining) – 3.8 US Quarts, 3.6 Liters

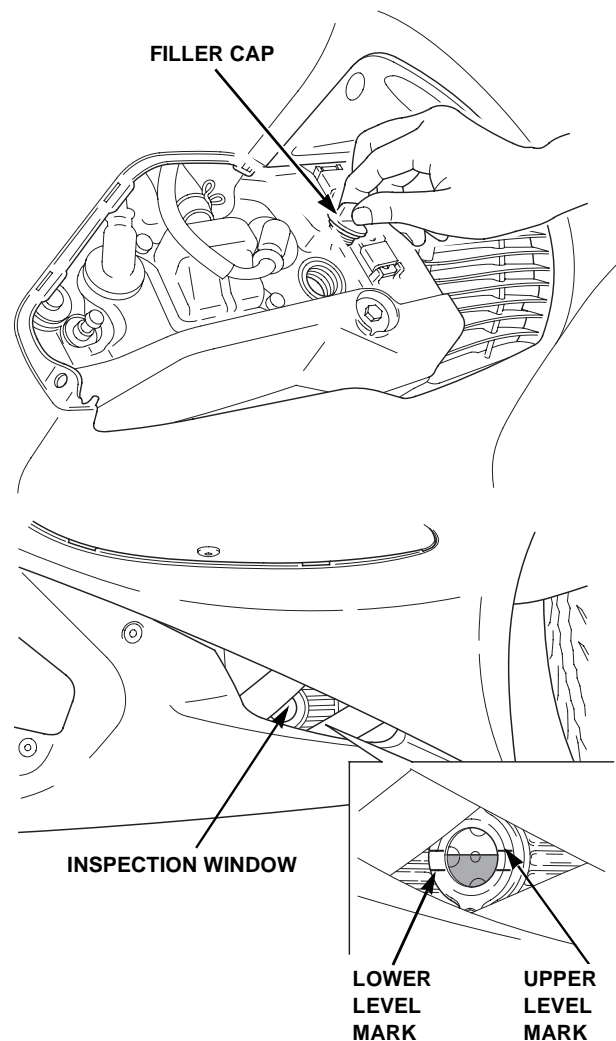



20. Check the final drive oil level.

Place the motorcycle on its center stand on a firm, level surface.

Remove the oil filler cap.

Check the oil level. It should be flush with the lower edge of the oil filler hole. If the level is low, check for oil leaks. Add the recommended oil through the oil filler hole until it reaches the lower edge of the opening.

Recommended oil: Pro Honda Shaft Drive Oil or equivalent SAE 80 hypoid gear oil.

Reinstall the oil filler cap.

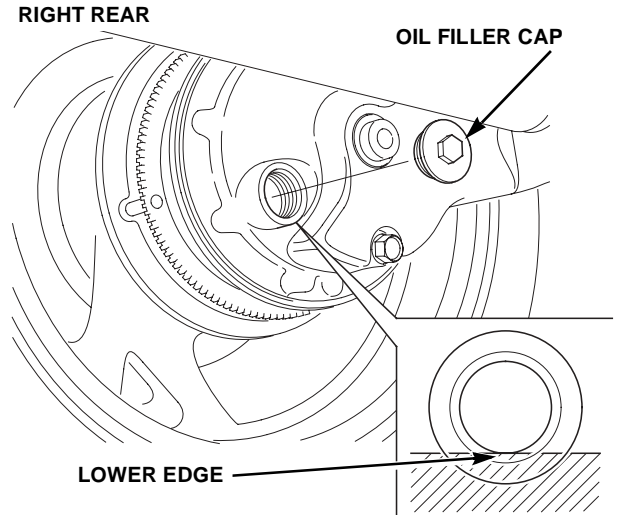

21. Check the front and rear brake reservoir fluid levels.

Turn the handlebar so that the front brake reservoir is level and check the fluid level.

Make sure the motorcycle is level and check the rear brake fluid level.

If the fluid level is low in either reservoir, remove the reservoir cover and diaphragm (by removing the two screws) or cap.

Add Pro Honda DOT 4 brake fluid or equivalent from a sealed container to bring the level up to the upper level mark.

Reinstall the cap or the diaphragm, cover, and screws.

Operate the hand lever and foot pedal. If the free play is excessive or the brake feels spongy and the reservoir fluid level is correct, bleed the system.

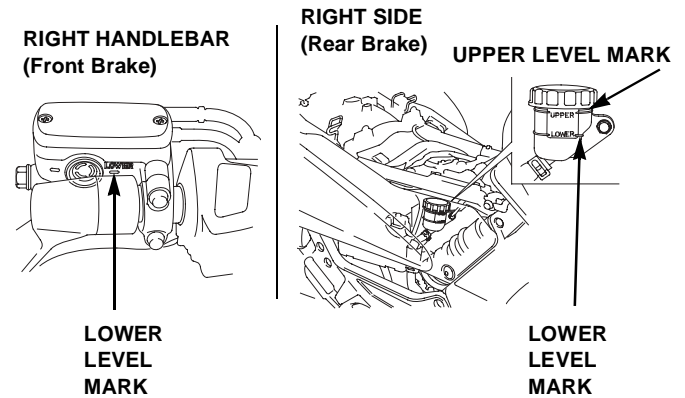

22. Check the coolant level.

Check the coolant level at the coolant reserve tank. If required, remove the coolant reserve tank cap and add Pro Honda coolant or an equivalent 50/50 mixture of antifreeze and distilled water to restore the level to the UPPER level mark. Do not spill coolant on painted or plastic surfaces as it can damage the finish.

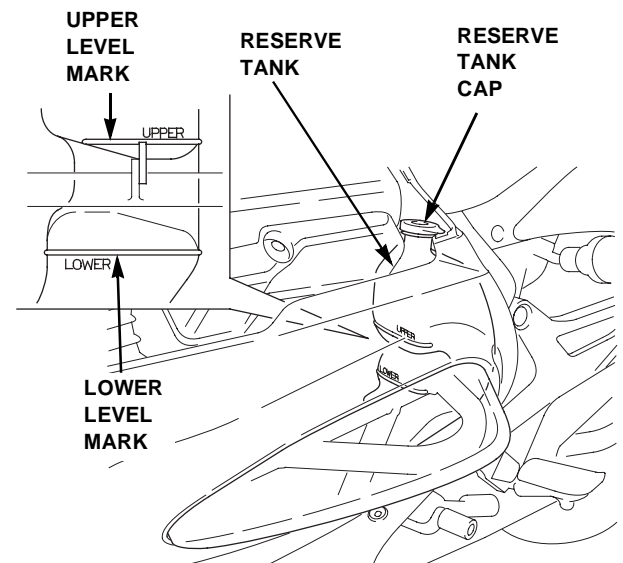

2003 ST1300 / ST1300A

23. Verify the proper routing of the cables, hoses, and wire harnesses.

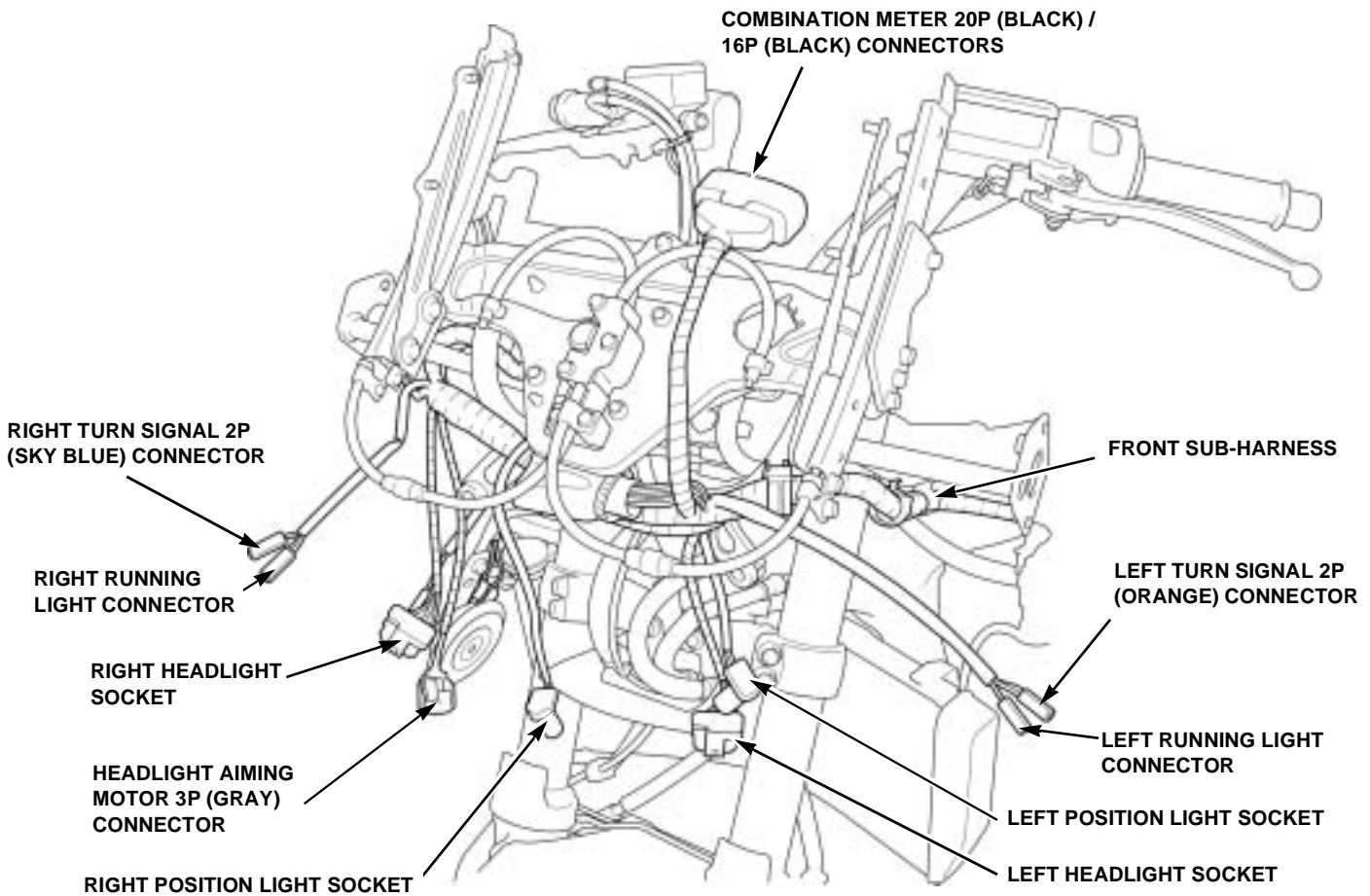
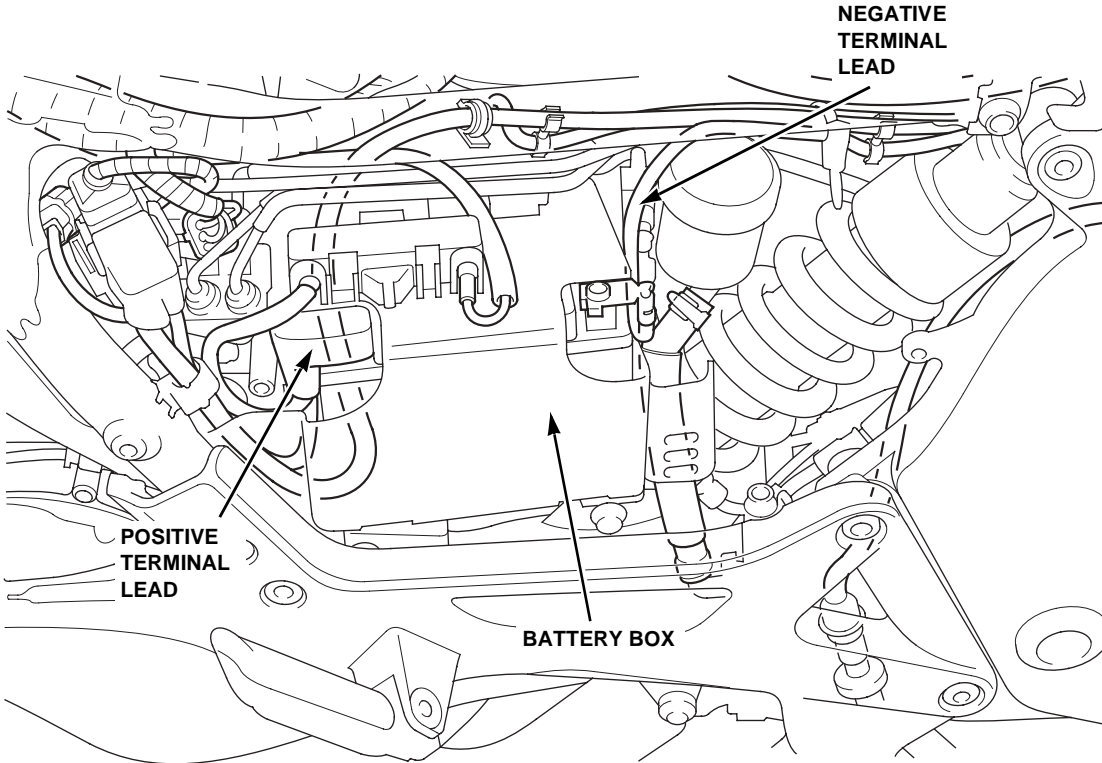



24. Check the idle speed.

Start the engine and warm it up to its normal operating temperature.

Place the motorcycle on its centerstand on a firm, level surface.

Connect a tachometer to the engine according to the manufacturer's instructions.

Verify the idle speed (rpm).

Idle speed: 1,000 ± 100 rpm

If an adjustment is needed, turn the throttle stop screw to set the idle speed using a screwdriver.

Stop the engine and remove the tachometer

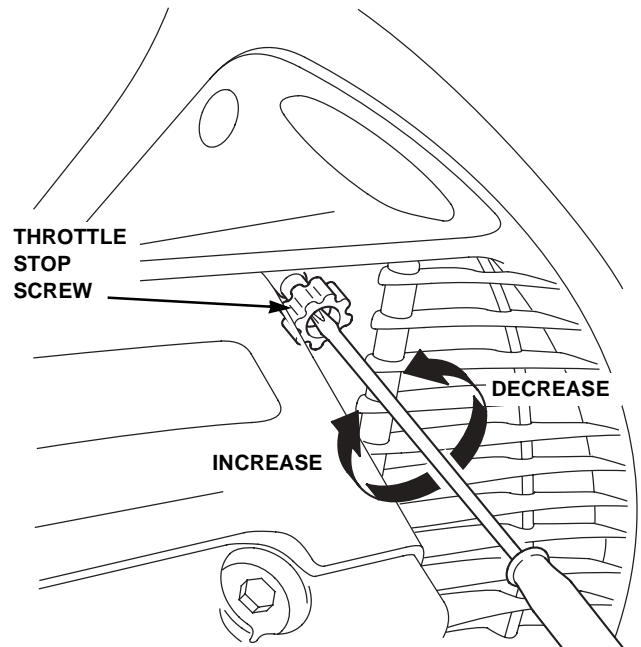

25. Check the tire pressure.

Front: 42 psi

Rear: 42 psi

26. Install the fuel tank knee grip pads.

Only install the optional knee grip pads if the customer states a desire to have them installed.

Clean the mating surfaces of the fuel tank with a clean shop towel and isopropyl alcohol or equivalent.

Peel off the backing sheets and attach the pads to the sides of the fuel tank 30 mm from the lower front edges of the tank, as shown in the illustration.

If the ambient temperature is 77°F or below, warm the mating surfaces of the tank and the pad's adhesive side with a hair dryer before attaching.

After attaching the pads, press down firmly over the entire area of the pad to ensure maximum adhesion.

Avoid washing the motorcycle or riding in wet conditions for 24 hours after attaching the pads.

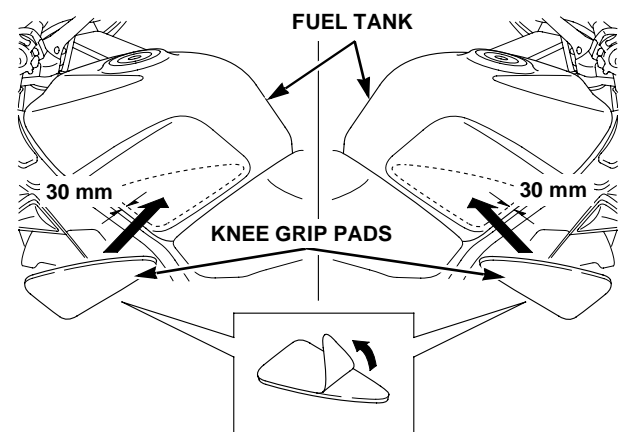

NEW

27. Complete the Set-Up/Pre-Delivery Checklist.

Complete an On-Road Motorcycle Set-up/Pre-delivery Checklist (Reorder No. S0297) by checking the boxes confirming that the steps were done.

ST1300

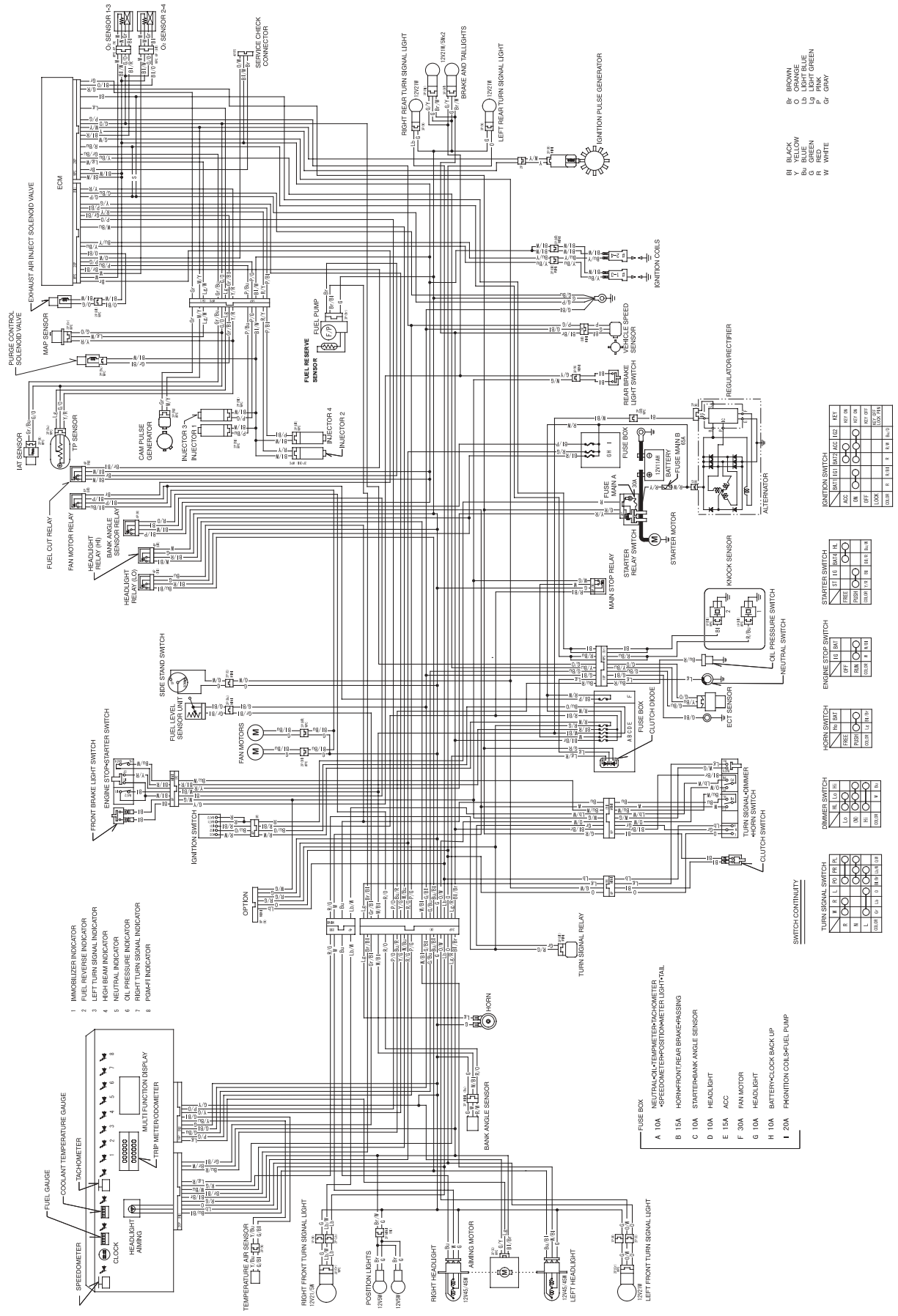

- Bf BROWN
- Bk BLACK
- Bl LIGHT BLUE
- Gr GREEN
- Cr GRAY

- Bf BLACK
- Bw WHITE
- Bl LIGHT BLUE
- Gr GREEN
- W WHITE

- 1 IMMOBILIZER INDICATOR
- 2 FUEL REVERSE INDICATOR
- 3 LEFT TURN SIGNAL INDICATOR
- 4 HIGH BEAM INDICATOR
- 5 NEUTRAL INDICATOR
- 6 OIL PRESSURE INDICATOR
- 7 POISSON INDICATOR
- 8 POISSON INDICATOR

- FUSE BOX
- A 10A NEUTRAL/CLUTCH/TEMPERATURE/CLUTCH/PAI
 - B 15A HORN/FRONT REAR BRAKE/PASSING
 - C 10A STARTER/BANK ANGLE SENSOR
 - D 10A HEADLIGHT
 - E 15A ACC
 - F 30A FAN MOTOR
 - G 10A HEADLIGHT
 - H 10A BATTERY/CLOCK BACK-UP
 - I 20A FRONT/IDA COIL/FUEL PUMP

IGNITION SWITCH

IGN	BATT	101	BATT	ACC	102	KEY
ACC	103	IGN	104	IGN	105	IGN
IGN	106	IGN	107	IGN	108	IGN
IGN	109	IGN	110	IGN	111	IGN
IGN	112	IGN	113	IGN	114	IGN

STARTER SWITCH

IGN	115	IGN	116	IGN
IGN	117	IGN	118	IGN
IGN	119	IGN	120	IGN
IGN	121	IGN	122	IGN

ENGINE STOP SWITCH

IGN	BATT
IGN	BATT
IGN	BATT
IGN	BATT

HORN SWITCH

IGN	BATT
IGN	BATT
IGN	BATT
IGN	BATT

DIMMER SWITCH

IGN	BATT
IGN	BATT
IGN	BATT
IGN	BATT

TURN SIGNAL SWITCH

IGN	BATT
IGN	BATT
IGN	BATT
IGN	BATT

SWITCH CONTINUED



ST1300A

